

Nº 955

R.P.O. Vol. 53  
C.T. Vol. 2398  
Vide Plan R.G. 41

Fol. 263  
Fol. 201

Ward of Naparima.  
County of Victoria.  
Cadastral Sheet (G.13.B),  $\frac{63F}{1/a}$

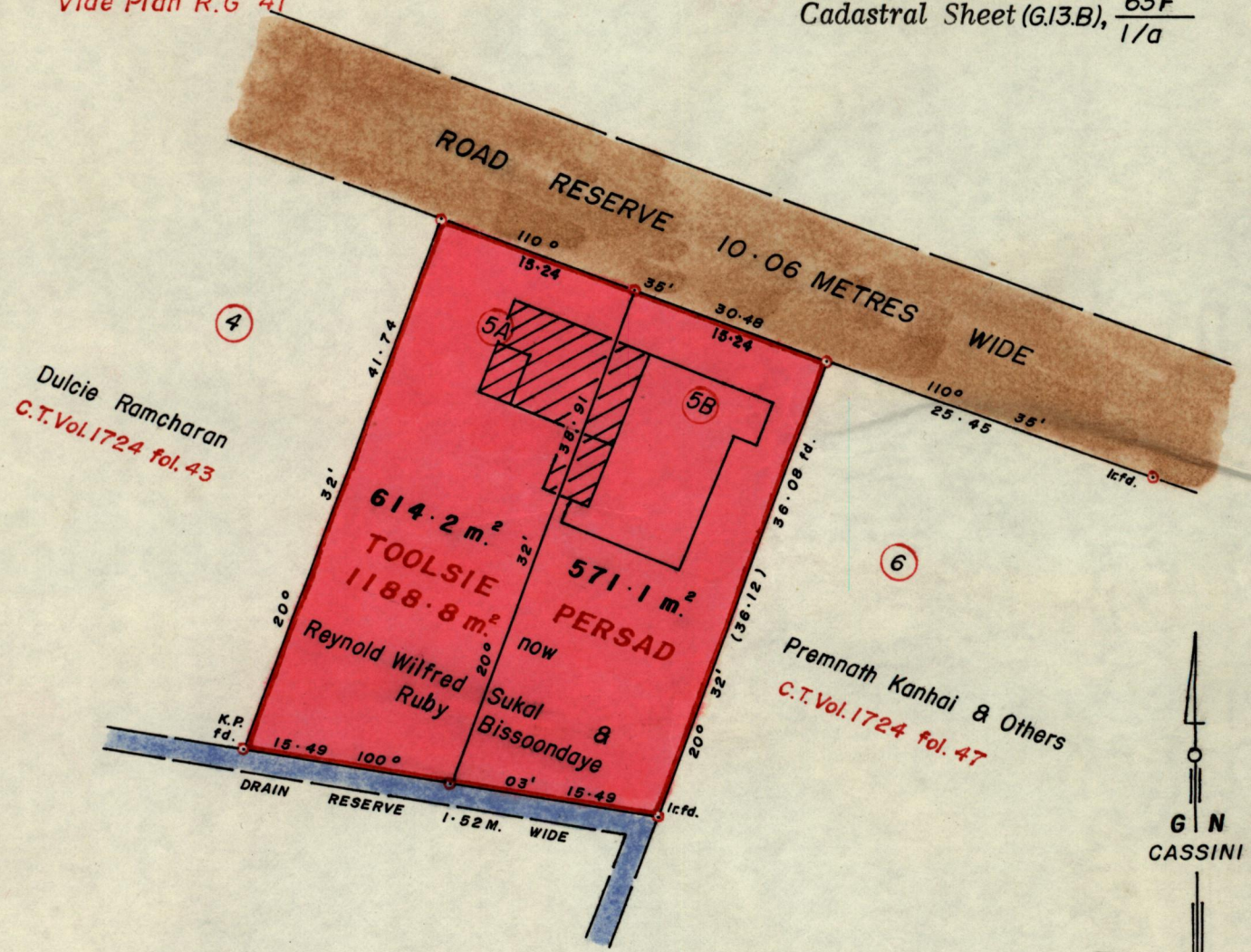

Dulcie Ramcharan  
C.T. Vol. 1724 fol. 43

Premnath Kanhai & Others  
C.T. Vol. 1724 fol. 47

Approved *[Signature]*  
Director of Surveys  
28/10/02

To be demolished

Denotes Iron put except stated otherwise

Bearings are Cassini Grid based on Solar Observations.  
Note: To obtain compass bearings add/subtract

SCALE 1 : 500

minutes Distances are in metres.

PLAN of 2 Parcels of land coloured pink in the Ward of Naparima.  
Containing together one thousand one hundred and eighty five point three square metres.  
Surveyed by me, with due authority, in March 1997.

I certify that I have complied with rule 76 under section 14(2)(d) of the  
Land Surveyors' Ordinance 1952, and that this plan is correct.

Checked by *[Signature]* 8.9.98

Entered .....

*[Signature]*  
Land Surveyor, Trinidad and Tobago  
12<sup>th</sup> March 1998

188

252

Word of ...  
County of ...  
Circuit Court

Vol. ...  
Page ...

1887 ...

Original Survey Plan R.G. 41

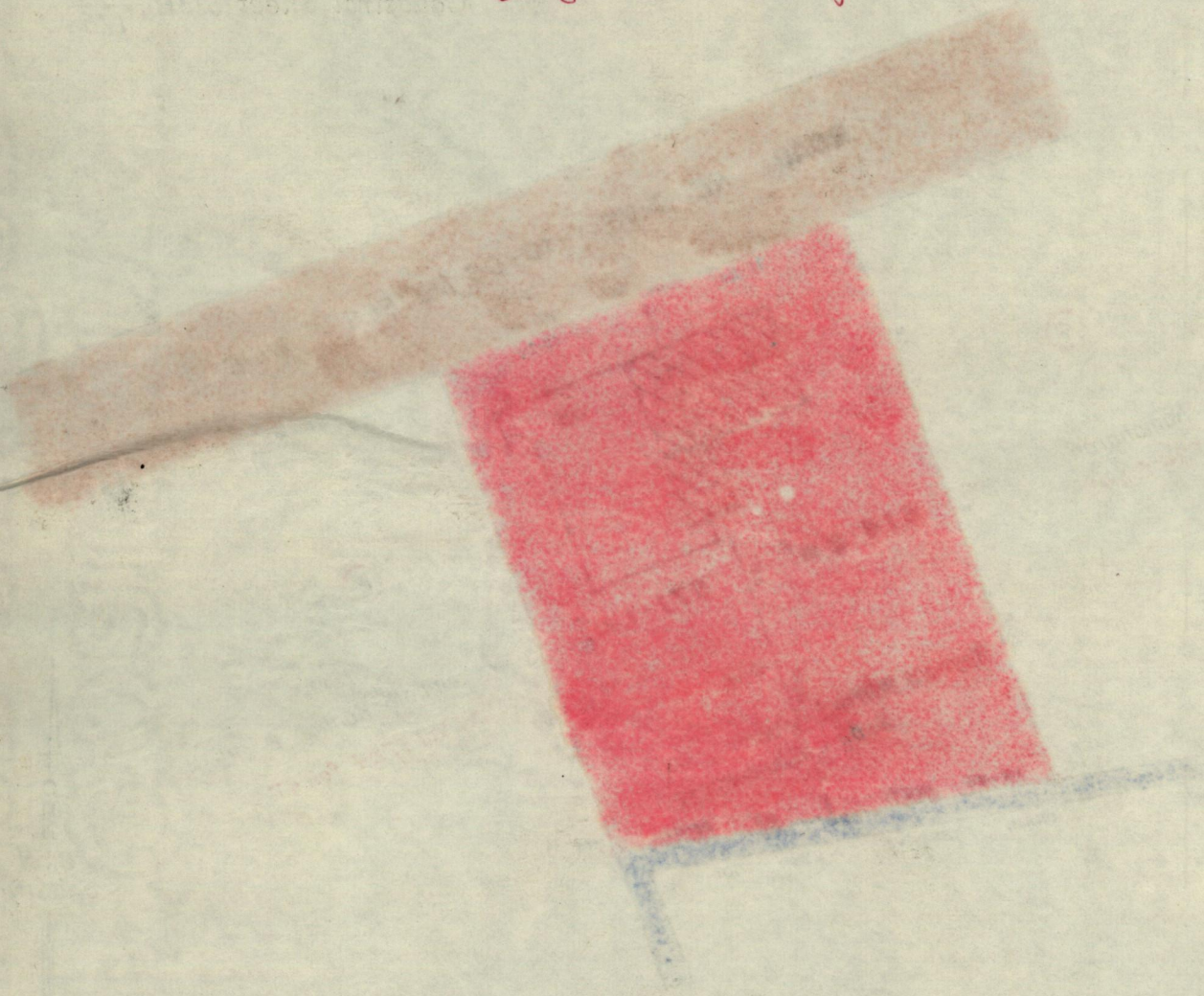

LANDS AND SURVEYS  
25 MAR 1998