

No. 23621

R.P.O. Vol. 16

Fol. 459

Ward of Siparia

C.T. Vol. 1616

Fol. 351

County of St. Patrick

Vide: Bk. 964 Fol. 123

Cadastral Sheet G.12.B.  $\frac{63.D}{27a}$

" : Bk. 1053 Vol. 2 Fol. 598

Parcel 2

SOOKDEHEE

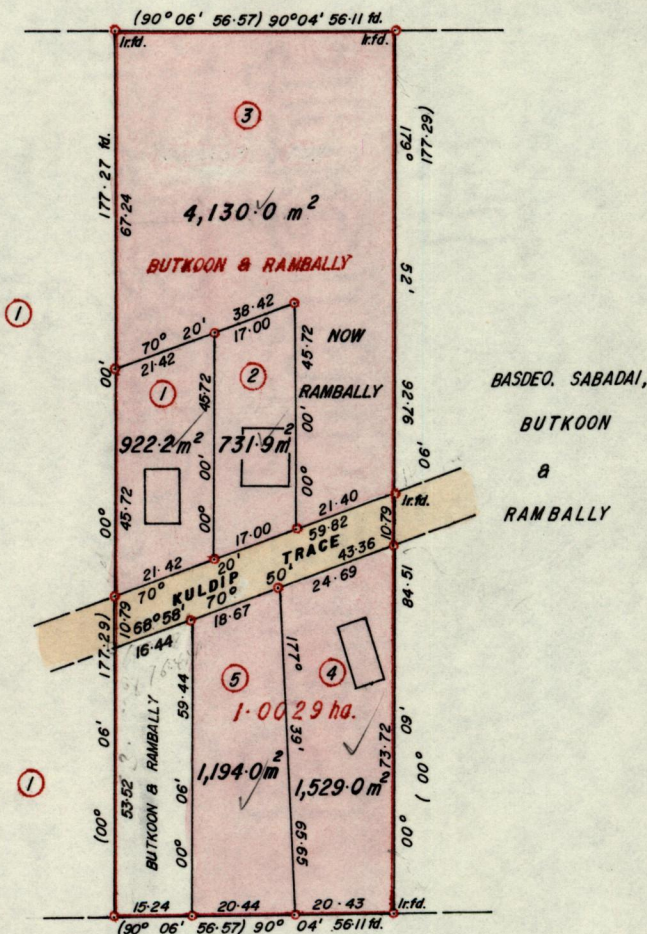

G.N. Cassini

VICTOR CHARLES

Approved

*[Signature]*

Director of Surveys  
9B.10.21

• Denotes iron put except otherwise stated.

Bearings are Cassini Grid, based on Solar Observations

SCALE 1:1500

Note: To obtain compass bearings add/subtract

minutes

Distances are in metres

PLAN of 5 Parcelsof land coloured pink in the Ward of Siparia

Containing together eight thousand, five hundred and seven point one square metres

Surveyed by me, with due authority, in March 6th. 1997

I certify that I have complied with rule 76 under section 14(2)(d) of the Land Surveyors' Ordinance 1952, and that this plan is correct.

Checked by

*[Signature]* 4.9.98

*[Signature]* 3/6/98

Entered

Land Surveyor, Trinidad and Tobago

Original Survey Blk. 964 fol. 123

