

1196

248

L. & S.—54

No 26949

1138

248

Comp.

R.P.O. Vol. III
C.T. Vol. 473

Fol. 105
Fol. 5

Ward of Turure
County of St. Andrew
Cadastral Sheet E.12.G $\frac{35F}{4/d}$ & $\frac{36D}{3/c}$

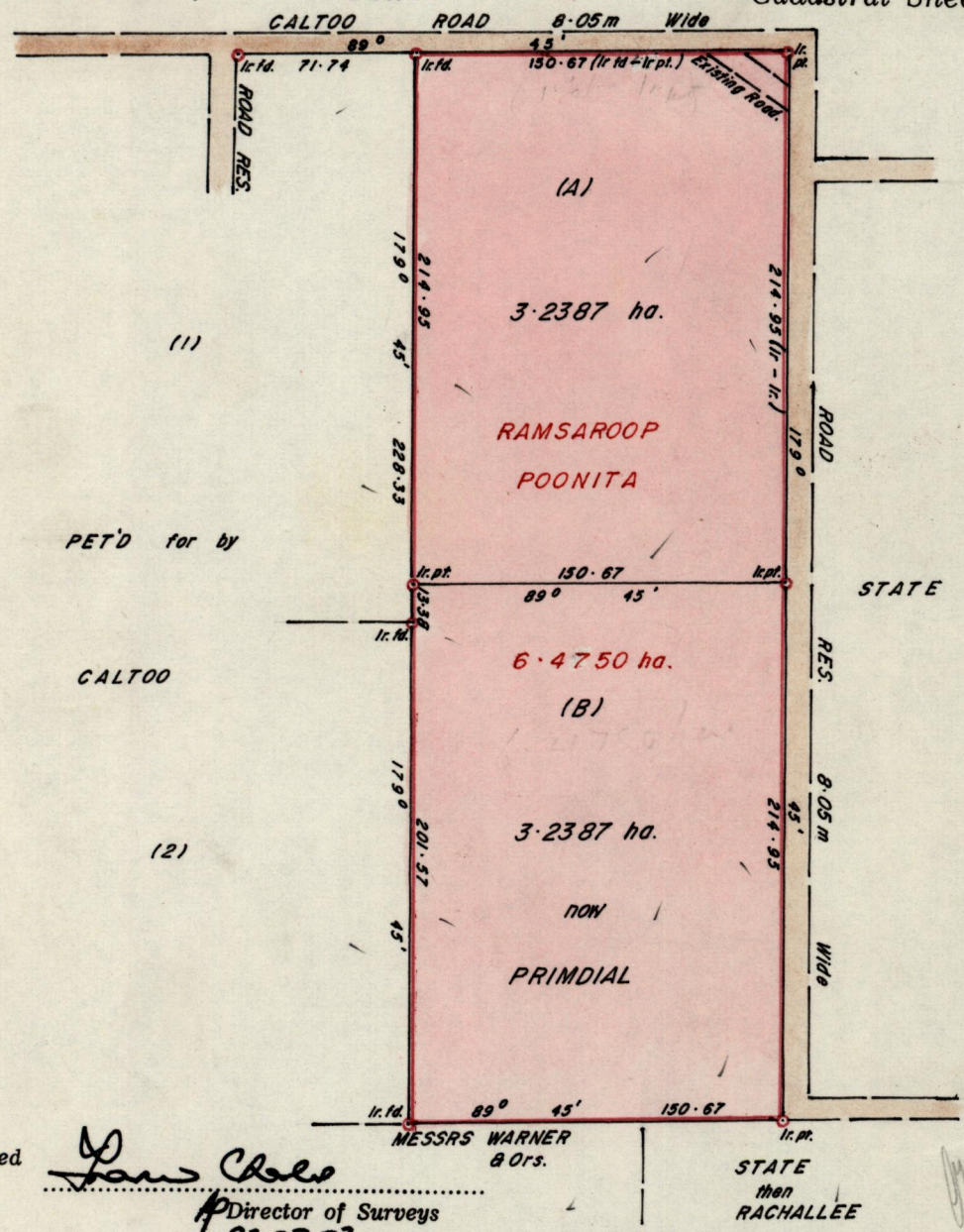

Approved

Paul Cole
Director of Surveys
92.07.03

SCALE 1/3000

Note: To obtain compass bearings add/subtract 15 minutes Distances are in metres

PLAN of 2 Parcels of land coloured pink in the Ward of Turure
Containing together six point four seven seven four hectares
Surveyed by me, with due authority, in July, 1989

I certify that I have complied with rule 76 under section 14(2)(d) of the
Land Surveyors' Ordinance 1952, and that this plan is correct.

Checked by *J. Ramcharan* 3/7/92 *Hugo Somars*

Entered Land Surveyor, Trinidad 15th November 1989
and Tobago

BR 1145 fol 276

BK. 1145 fol. 476

Orig in Bk. 177 fol. 88

1145

177

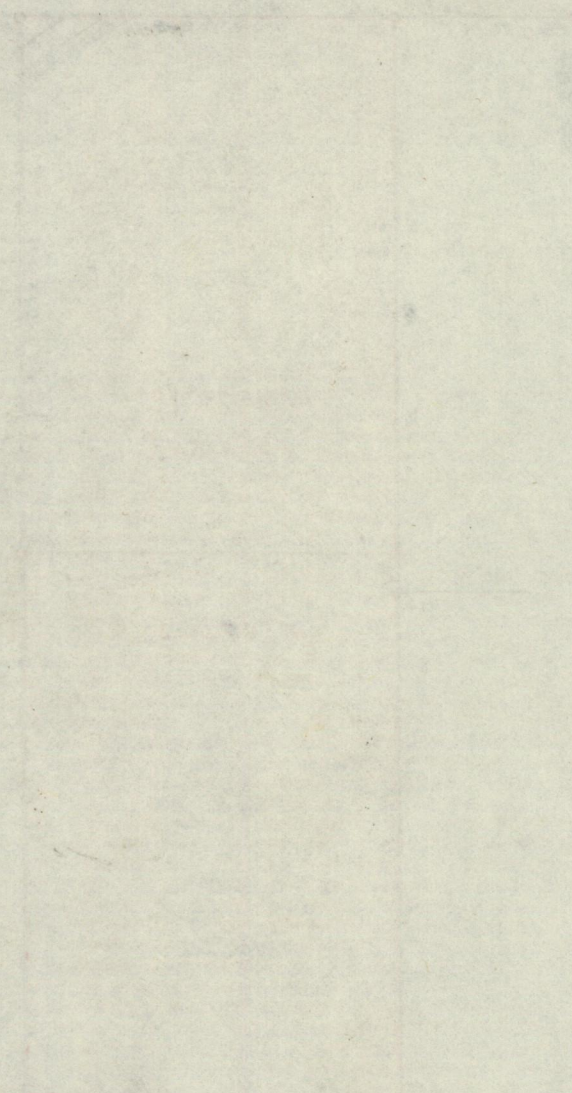

[Faint handwritten text]