

1196

REMAINING PORTION

244

R.P.O. Vol. 28 Fol. 201

Cadastral Sheet 24 D / 3/a (D. 3. B.)

C. of T. Vol. 3554 Fol. 517

Ward of Cunupia

County of Caroni

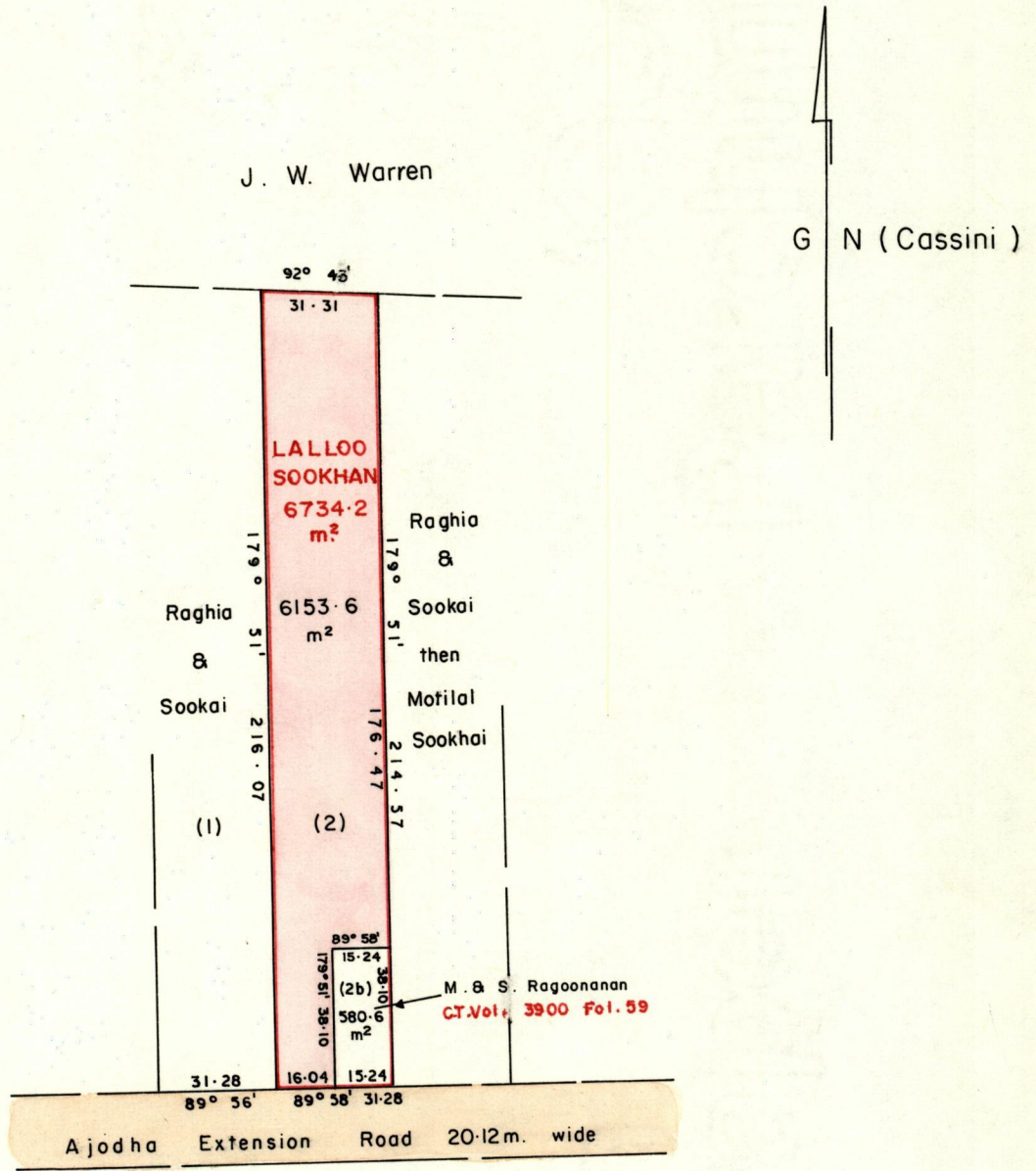

Approved

[Signature]
 Director of Surveys
 28/8/24

Note: To obtain compass bearings add 2 minutes subtract

SCALE 1 : 2000

Distances are in METRES

This is a true copy of a diagram of six thousand seven hundred and thirty-four point two square metres originally granted to LALLOO SOOKHAN, shewing a portion coloured pink and containing six thousand one hundred and fifty-three point six square metres being the remainder after one previous transfer of another portion of the land.

the dividing lines having been run in conformity with Rule 76 under Sec. 7(d) of Cap. 27: No. 2 and duly certified by the Director of Surveys.

Checked by *[Signature]*
 Entered on 17-8-28

[Signature]
 Land Surveyor, Trinidad, July 03 1928

Original Survey Bk. 1200 fol: 215

