

No 22896

1136

217

R.P.O. Vol. 515  
C.T. Vol.

Fol. 465  
Fol.

Ward of Tacarigua  
County of St. George  
Cadastral Sheet B.18.M.  $\frac{24A}{1/c}$

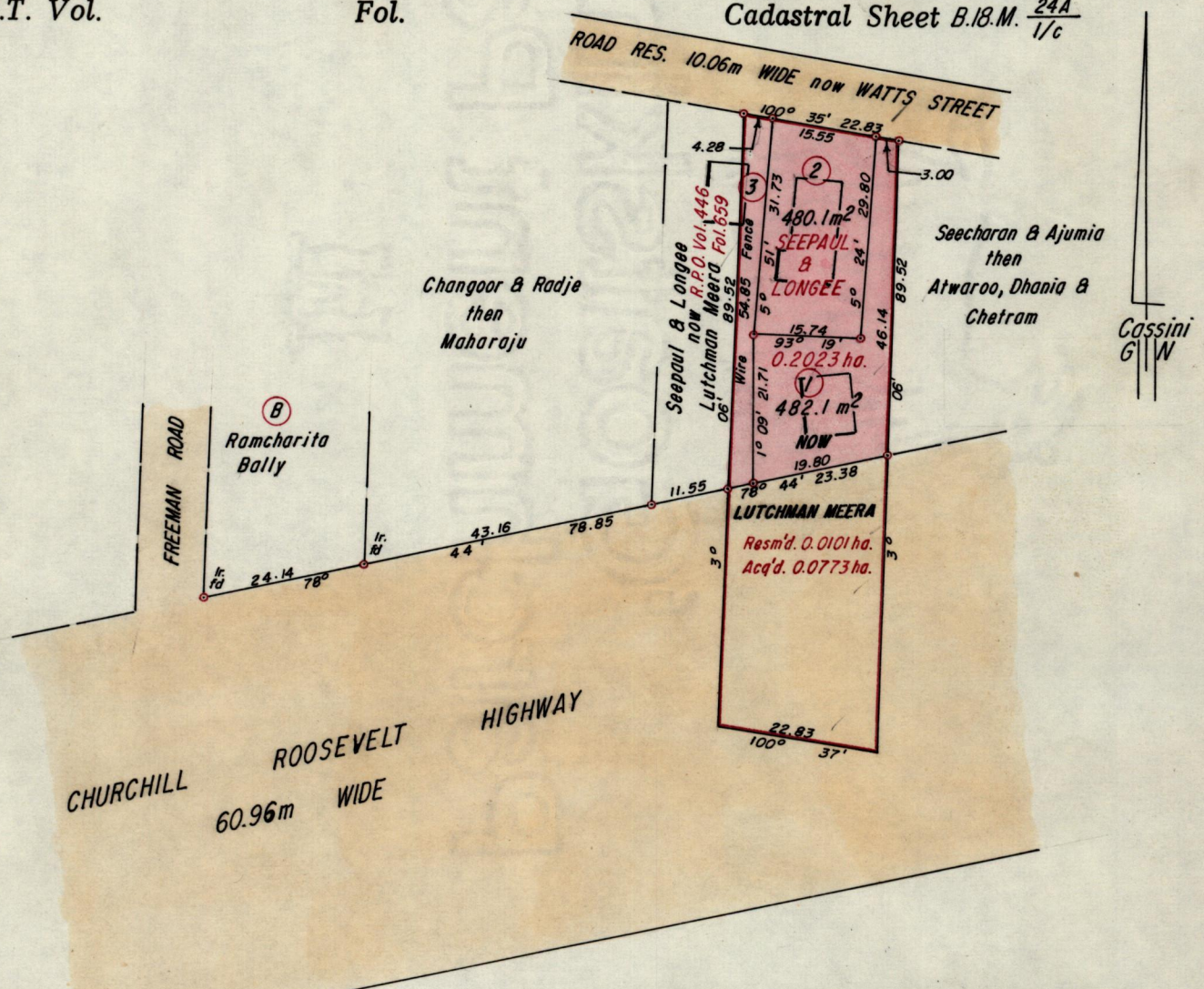

Note: Parcel 3 to be amalgamated to Parcel with R.P.O. Vol. 446 Fol. 659

Approved *[Signature]*

PARCEL 3 = 180.6 m<sup>2</sup>

Director of Surveys 92.06.05

• Denotes Iron put except otherwise stated  
Bearings are based on solar observations

SCALE 1:1000

Note: To obtain compass bearings add/subtract

minutes

Distances are in Metres

PLAN of 3 Parcelsof land coloured pink in the Ward of Tacarigua  
Containing one thousand one hundred and forty two point eight square metres  
Surveyed by me, with due authority, in January 1992

I certify that I have complied with rule 76 under section 14(2)(d) of the  
Land Surveyors' Ordinance 1952, and that this plan is correct.

Checked by *[Signature]*

*[Signature]*

Entered .....

Land Surveyor, Trinidad & Tobago 20th May 1992

Original Plan P.A. 24