

EX. 1196

211

L. & S.—54

No 24664

1136

211

R.P.O. Vol.
C.T. Vol. 2886

Fol.
Fol. 129

Ward of Savana Grande
County of Victoria
Cadastral Sheet G.4.N. 54D
3/b

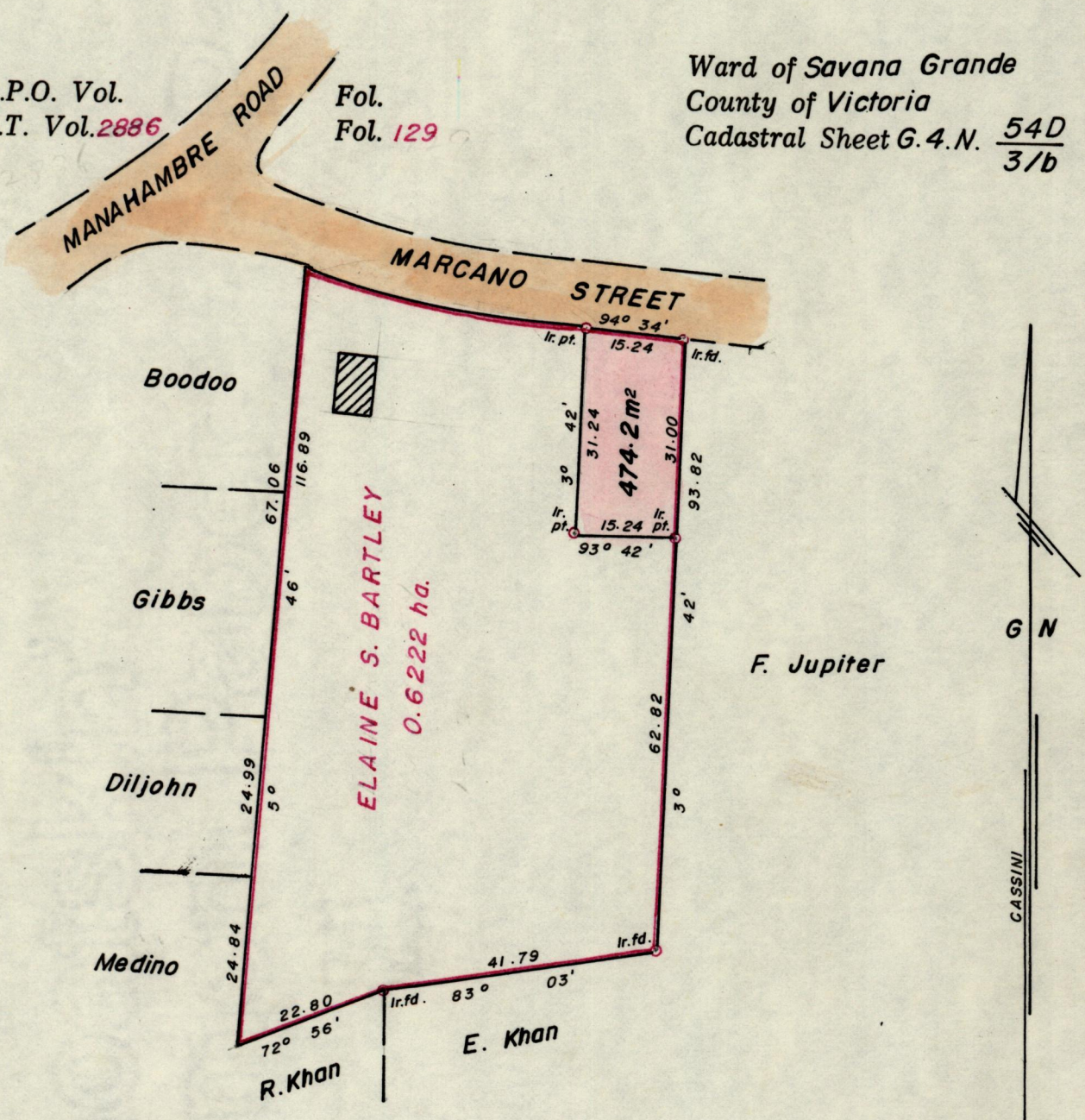

Approved *David Charles*
 Director of Surveys
 92.05.22

Bearings based on Solar obs. SCALE 1: 1000
 Note: To obtain compass bearings add/subtract minutes Distances are in metres

PLAN of a Parcel of land coloured pink in the Ward of Savana Grande
 Containing four hundred and seventy four point two sq. metres
 Surveyed by me, with due authority, in November 1990
 I certify that I have complied with rule 76 under section 14(2)(d) of the
 Land Surveyors' Ordinance 1952, and that this plan is correct.

Checked by *J.Ramcharan* 15/5/92
 Entered Land Surveyor, Trinidad 10/11/1990

Original Survey Bk. 1132 pl. 25

