

1198

Cadastral Sheet E. 2. L.

36 A
1/a

193

138746

Ward of Turure

County of Nariva

CONSOLIDATED PLAN

G. N.
Cassini

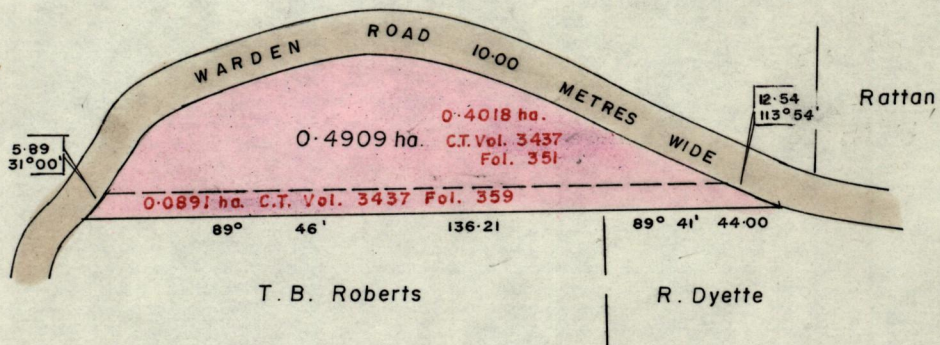

Approved

[Signature]

Vide: L&S. Bk. 1159 fol. 95.
& 1159 fol. 163

Director of Surveys
92.05.05

SCALE : 1 / 2000

add

Note: To obtain compass bearing ~~subtract~~ 19 minutes Distances are in metres

PLAN of a Parcel of land coloured pink in the Ward of Turure

Containing zero point four nine zero nine hectare.

Compiled

Surveyed by me, with due authority, in October 1991

for Vernon Allard.

Checked by *[Signature]*
10/15/92

Entered

[Signature]
Land Surveyor, Trinidad

16/10/1991

Original Plan BK. 1159 fol. 95

20

20

1159

LIBRARY OF THE UNIVERSITY OF CHICAGO

1159

Handwritten signature or name