

1196

1133

No 27613

R.P.O. Vol. C.T. Vol. 1904

Fol. 155

Borough ~~Werra~~ of Arima County of St. George Cadastral Sheet 24C/4/a (B.25.E.)

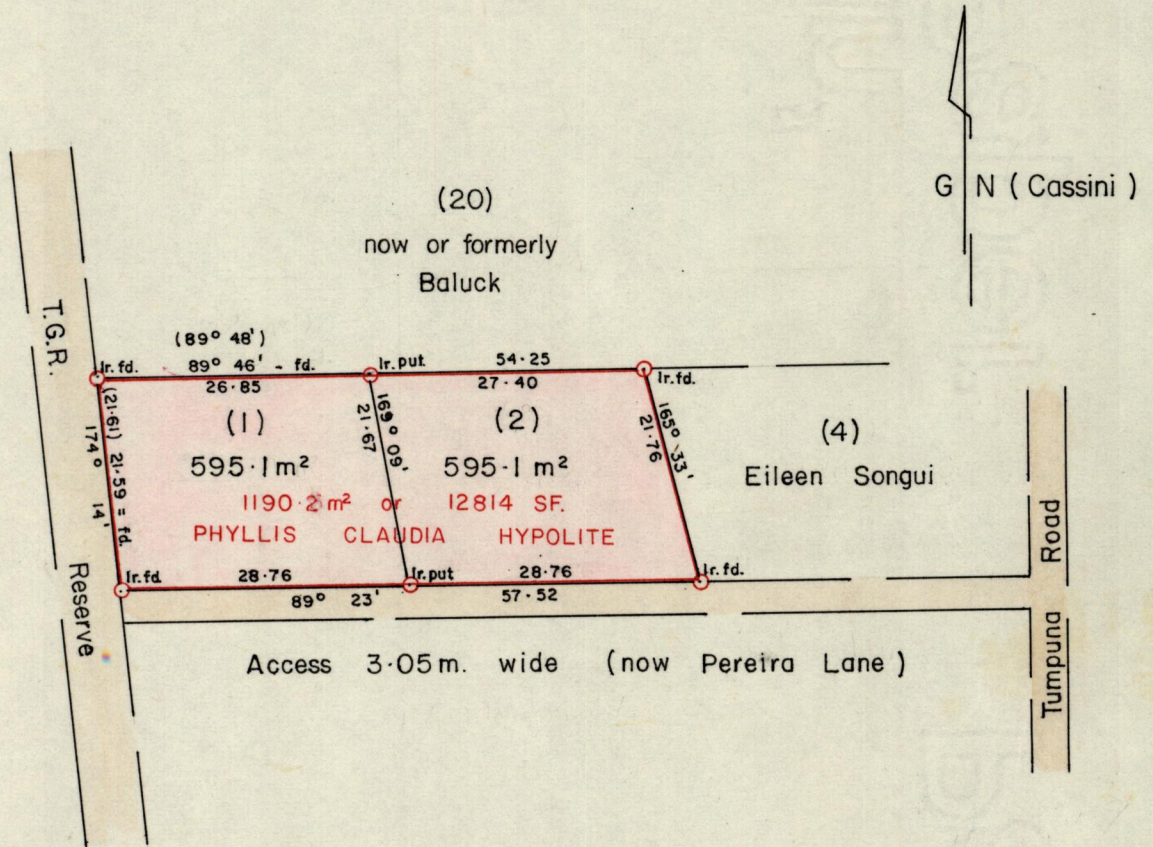

- References
 R.P.O. Vol. 1254 Fol. 195
 Vol. 1761 Fol. 79
 R.P.O. Vol. 1254 Fol. 193

Approved *[Signature]*
 Director of Surveys
 980703

SCALE 1 : 750

Note: To obtain compass bearings add/subtract minutes Distances are in METRES

PLAN of 2 Parcelsof land coloured pink in the ~~Werra~~ of Arima

Containing together one thousand one hundred and ninety point two square metres. Surveyed by me, with due authority, in February 1994.

I certify that I have complied with rule 76 under section 14(2)(d) of the Land Surveyors' Ordinance 1952, and that this plan is correct.

Checked by *[Signature]* 12.6.94 *[Signature]*
 Entered Land Surveyor, Trinidad 7th June 1994

Original survey Plan F. 1 37