

REMAINING PORTION

R.P.O. Vol. 28 Fol. 575

Cadastral Sheet $\frac{34C}{27a}$, D5

C. of T. Vol. 1661 Vol. 469

Ward of San Rafael

County of St. George

1196

166

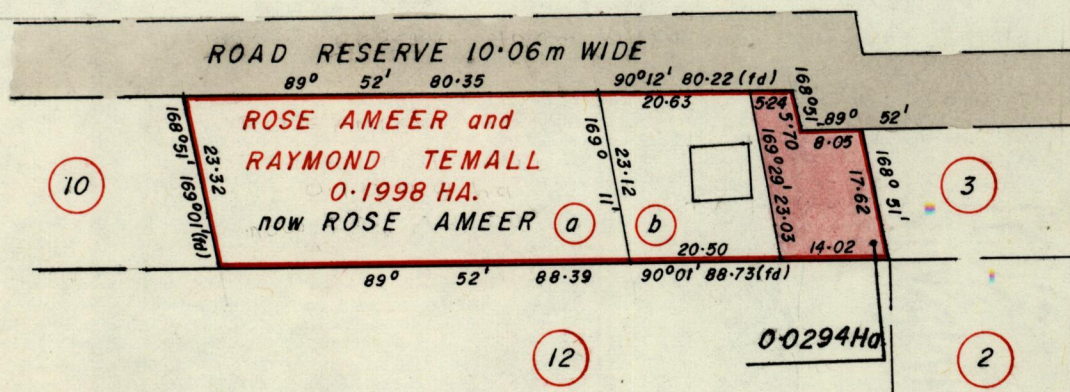

(a) John & Margret Seepaulsingh 0.1237 Ha.
C.T. Vol. 2595 Fol. 221

(b) Paul & Daisy Ramsaroop 0.0466 Ha.
C.T. Vol. 2466 Fol. 183

Approved

C. A. ...

Director of Surveys

9980608

Note: To obtain compass bearings add 8 minutes subtract

SCALE 1/1000

Distances are in metres

This is a true copy of a diagram of zero point one nine nine eight hectares originally transferred granted to ROSE AMEER and RAYMOND TEMALL, shewing a portion coloured pink and containing zero point zero two nine four hectares being the remainder after two previous transfers of other portions of the land. the dividing lines having been run in conformity with Rule 76 under Sec. 7(d) of Cap. 27: No. 2 and duly certified by the Director of Surveys.

Checked by *AD 29.5.8*

Entered on

Albert ...

Land Surveyor, Trinidad,19.....

Orig Survey Plan R. G. 13.

