

R.P.O Vol. 1804 Fol. 45
C.T. Vol. Fol.

Ward of Arima
County of St. George
Cadastral Sheet B.24 L. 24C
37D

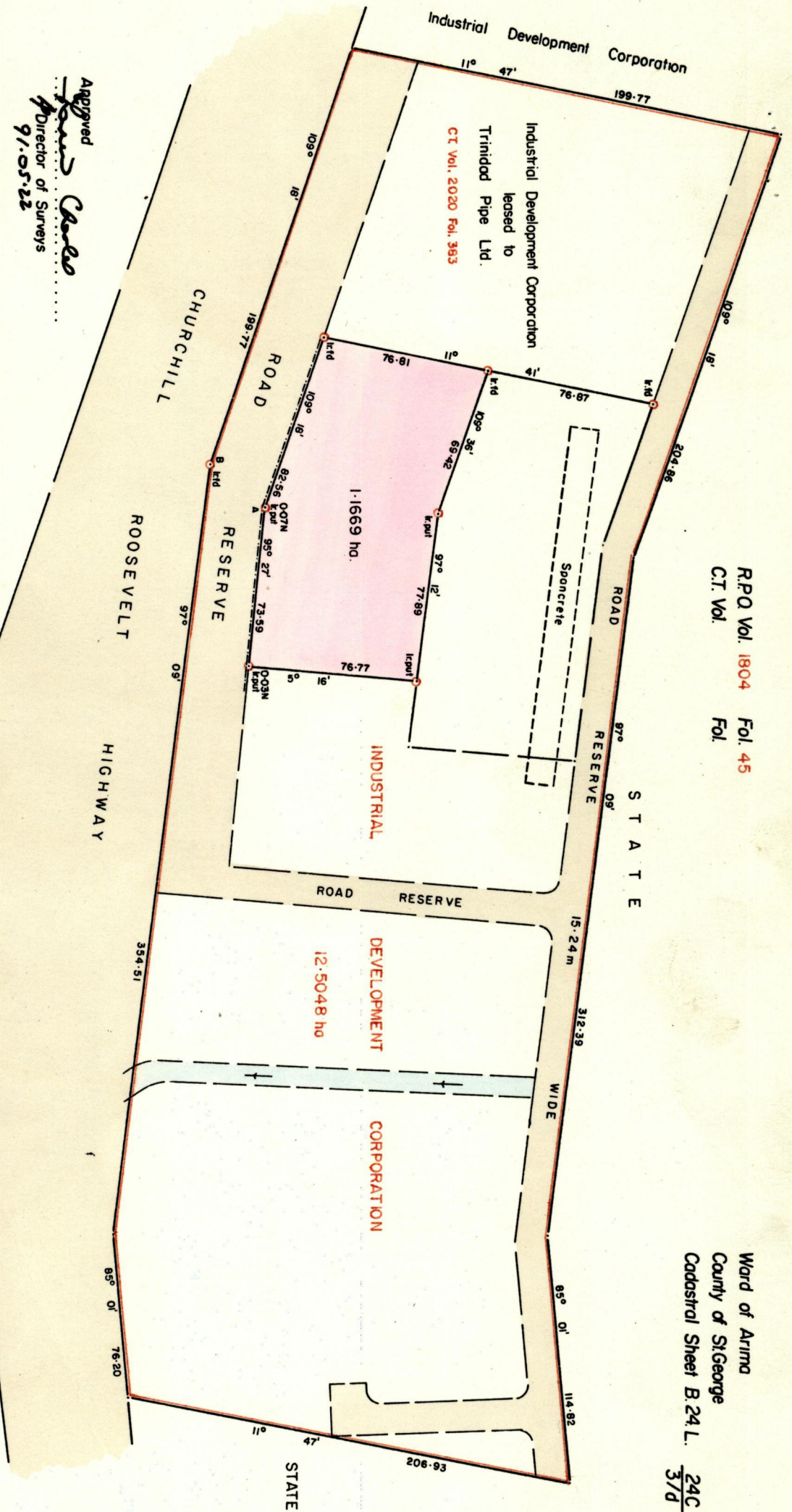

Approved
[Signature]
Director of Surveys
9/05/22

Bearings are based on Solar Observations.
PLAN of a Parcel of land coloured pink in the Ward of Arima
Containing one point one six six nine hectares
Surveyed by me, with due authority, in November 1990
I certify that I have complied with rule 76 under Section 14 (2) (d) of the Land
Surveyors' Ordinance 1952, and that this plan is correct.
Checked by: *[Signature]*
Entered: *[Signature]* 15/1/79.

[Signature]
Land Surveyor, Trinidad 18/11/December 1990

B - A 38° 32' 32.38
SCALE 1/2500
Distances are in metres

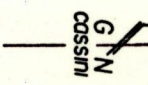

Original Survey -! Bk. 947 fol. 221