

1196

L. & S.—54

152

No 14945

R.P.O. Vol. 424
C.T. Vol. 2366.

Fol. 595
Fol. 429.

Ward of Savana Grande.
County of Victoria.

Cadastral Sheet G. 14. D. 64E
1/4.

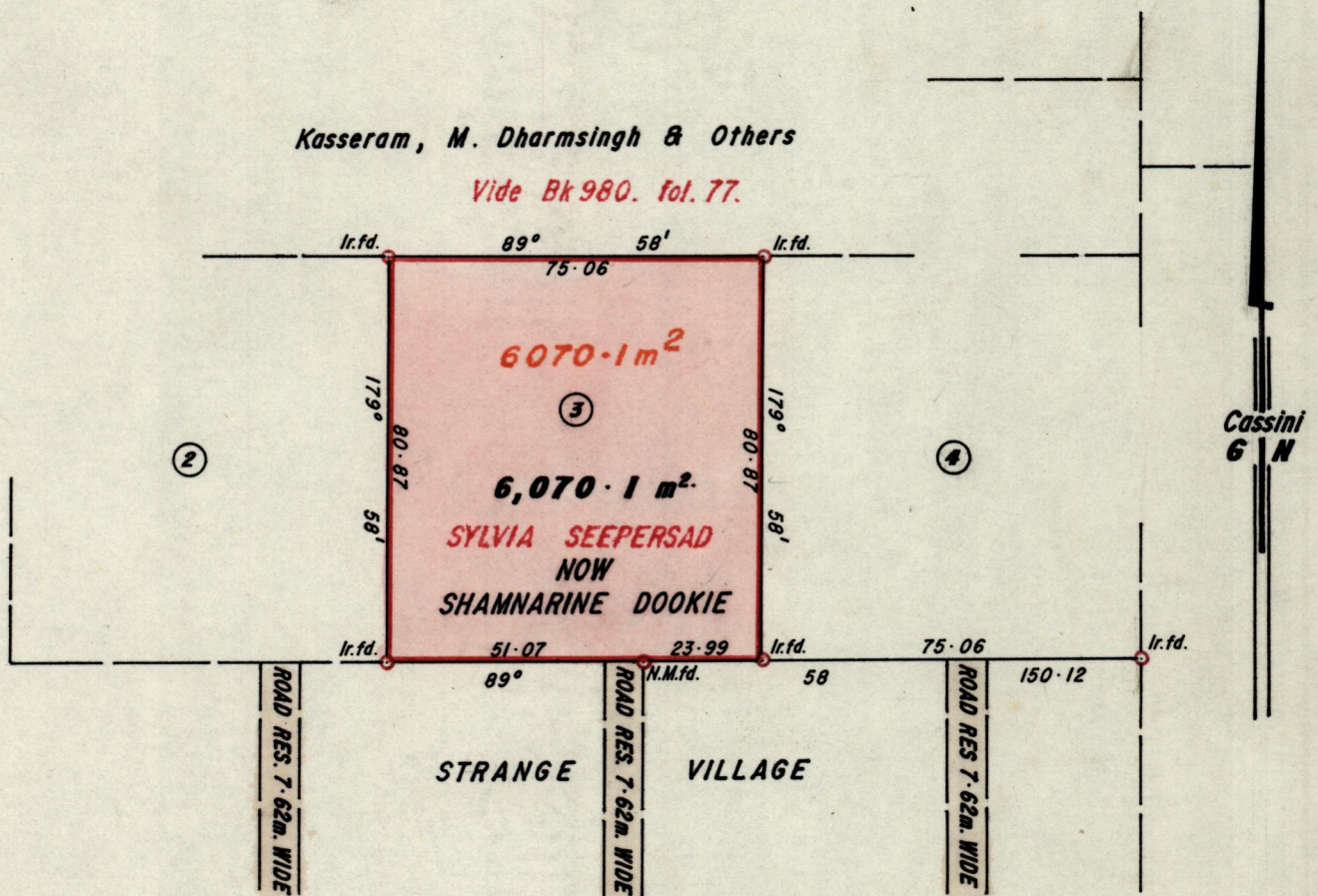

Approved

[Signature]

Director of Surveys

9905-29

Cassini Grid bearings based on Solar Observations. SCALE 1 : 1500.

Note: To obtain compass bearings add/ ~~02~~ 02 minutes Distances are in metres.

PLAN of a Parcel of land coloured pink in the Ward of Savana Grande.

Containing six thousand and seventy point one square metres.

Surveyed by me, with due authority, in January 1998.

I certify that I have complied with rule 76 under section 14(2)(d) of the Land Surveyors' Ordinance 1952, and that this plan is correct.

Checked by *[Signature]* *[Signature]*

Entered Land Surveyor, Trinidad 2nd February 19.98

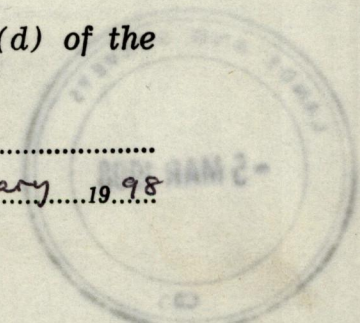

Original Survey Blk. 980 fol. 77

