

R.P.O. Vol. 103 Fol. 567

C.T. Vol. 1501 Fol. 133

Ward of Siparia

County of St. Patrick

Cadastral Sheet G.12.H 63E
1/d, 3/b

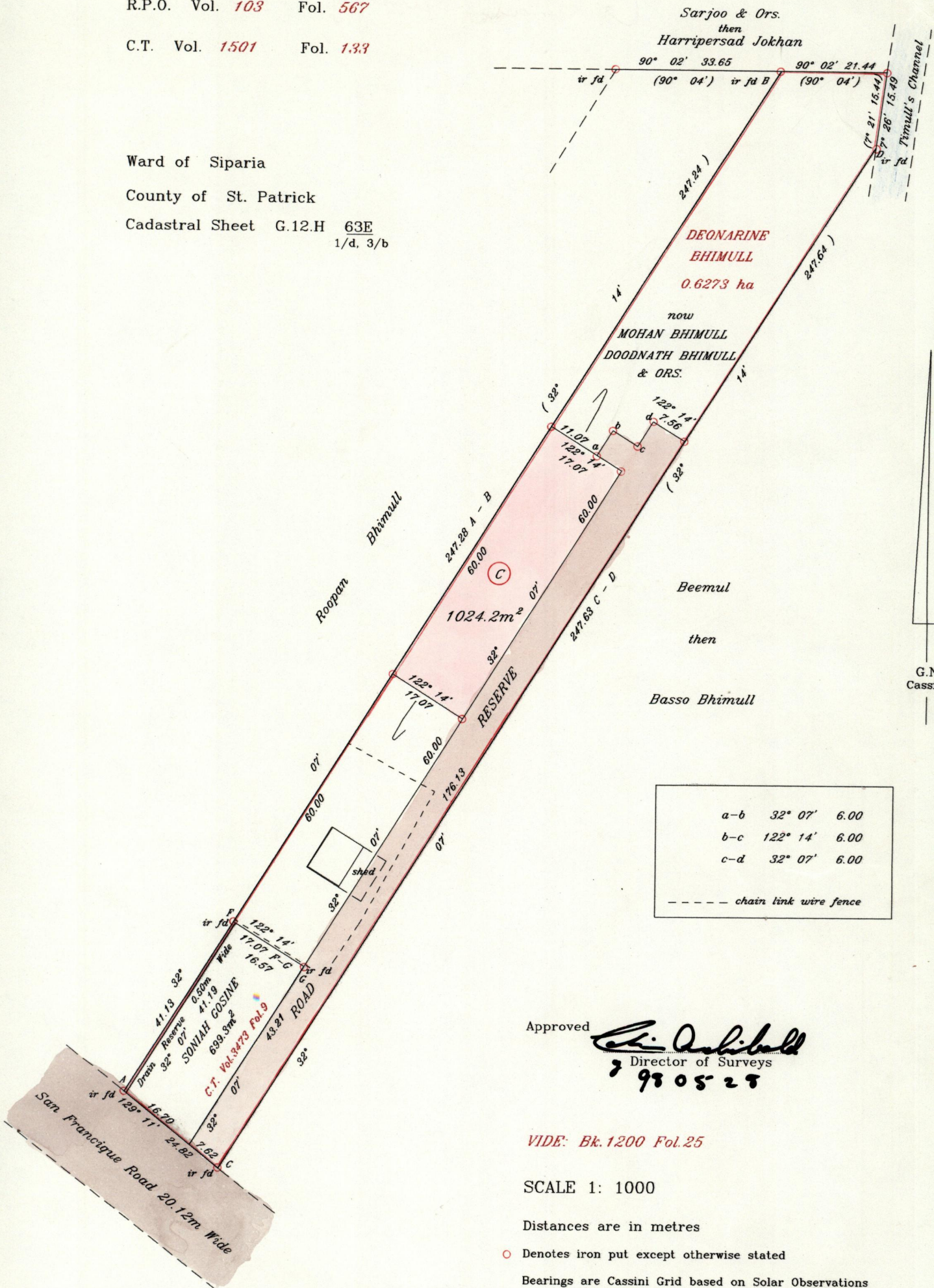

a-b	$32^{\circ} 07'$	6.00
b-c	$122^{\circ} 14'$	6.00
c-d	$32^{\circ} 07'$	6.00

--- chain link wire fence

Approved *[Signature]*
 Director of Surveys
 980525

VIDE: Bk.1200 Fol.25

SCALE 1: 1000

Distances are in metres

○ Denotes iron put except otherwise stated

Bearings are Cassini Grid based on Solar Observations

PLAN of a Parcel of land coloured pink in the Ward of Siparia
 Containing one thousand and twenty four point two square metres
 Surveyed by me, with due authority, in June 1997
 I certify that I have complied with rule 76 under section 14(2)(d) of the
 Land Surveyors' Ordinance 1952, and that this plan is correct

Checked by *[Signature]* 98.5.8

[Signature]
 Land Surveyor, Trinidad & Tobago 27/6/1997



Original Survey Bk. 936 fol. 249

