

R.P.O. Vol. 815 Fol. 347
 C.T. Vol. Fol.

Cadastral Sheet 66.E., (H. 15.1.)
 4/b

Ward of Guayguayare.
 County of Mayaro.

CROWN
 Under Mining Lease to
 Trinidad
 Leaseholds Ltd.

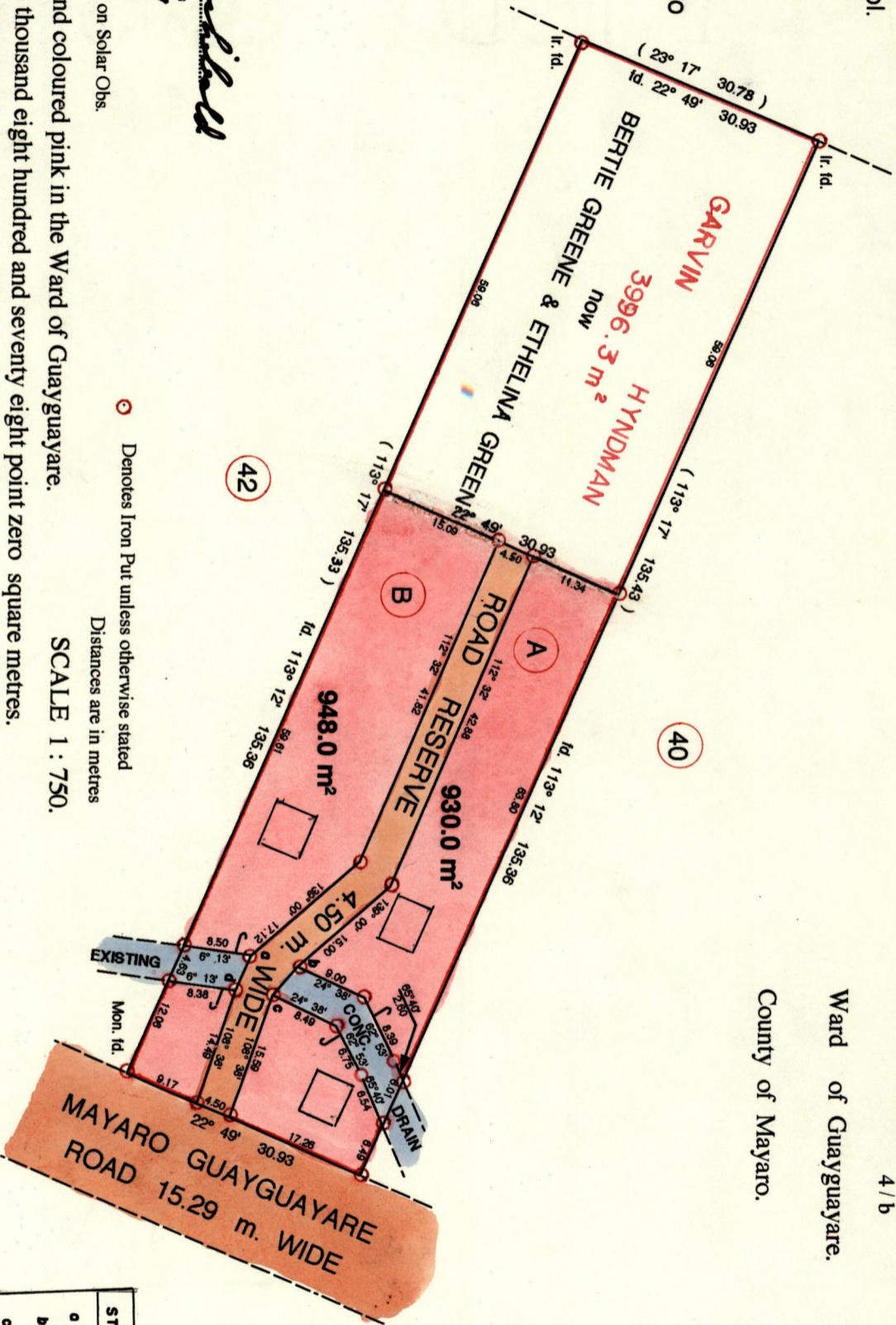

Approved *[Signature]*
 Director of Surveys
 2980527

○ Denotes Iron Put unless otherwise stated
 Distances are in metres

SCALE 1 : 750.

PLAN of 2 Parcels of land coloured pink in the Ward of Guayguayare.
 Containing together one thousand eight hundred and seventy eight point zero square metres.
 Surveyed by me, with due authority, in February 1996.
 I certify that I have complied with rule 76 under section 14 (2) (d) of the
 Land Surveyors Ordinance 1952, and that this plan is correct.

Checked by *[Signature]* 29.8.4.21.
 Entered.....
 Land Surveyor, Trinidad & Tobago 26. 04. 1997.

Vide Plan K.D.17

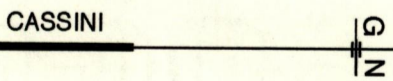

STATION	BEARING	DISTANCE
a - b	14° 01'	5.51
b - c	127° 38'	4.55
c - d	188° 53'	4.55
d - a	294° 37'	4.67

1980/15

124

Original Survey Bk. 745 fol. 97

