

1195

REMAINING PORTION

R.P.O. Vol. 566 Fol. 27
 C.T. Vol. Fol.
 U.P.R.N. No.:.....

Ward of Siparia
 County of St. Patrick
 Cadastral Sheet 64D & 63F (G.14.M)
 3/c 4/d

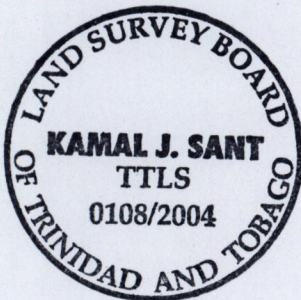
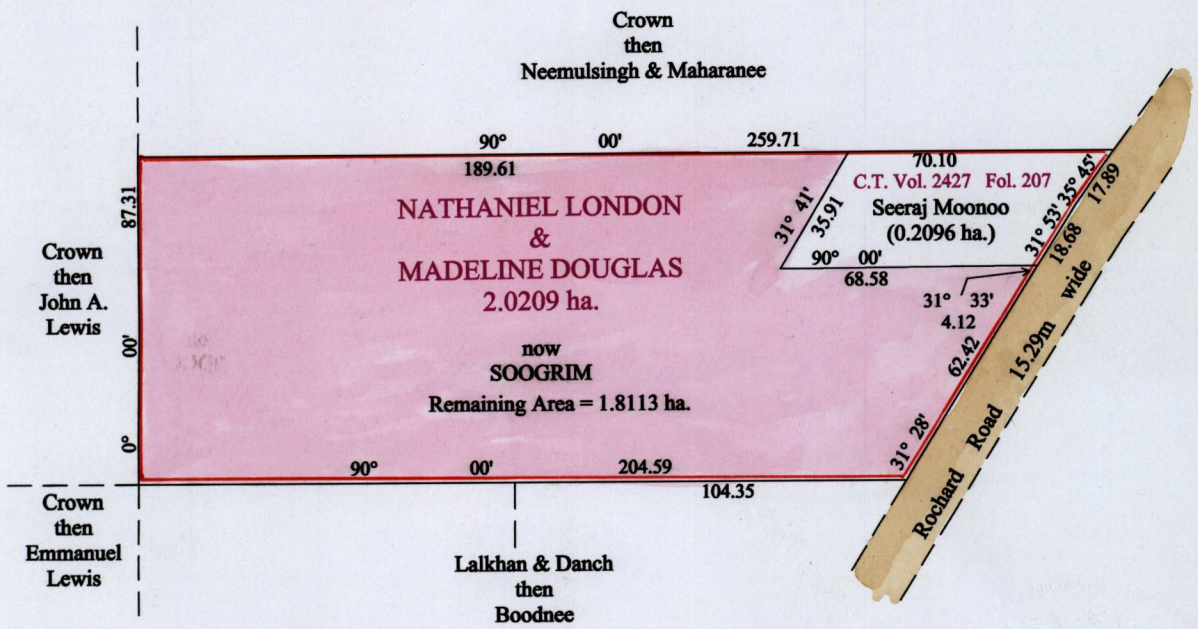
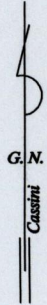

References:
 Bk. 563 Fol. 184
 Bk. 1063 Fol. 22

Approved *[Signature]*
 Director of Surveys
 2004/1/3

Distances are in metres
 Scale 1 : 2,000

This is a true copy of a diagram of Two point zero two zero nine hectares originally granted to Nathaniel London and Madeline Douglas, showing a portion coloured pink and containing One point Eight One One Three hectares being the remainder after one (1) previous transfer of another portion of the land. In accordance with Regulation 25(1) of the Land Surveyors' Regulations 1998, I certify that this plan is correct.

checked by *[Signature]* 12-10-04 Trinidad & Tobago Land Surveyor *[Signature]*
 entered on April 30th 2004