

Legend

F - M ₅	238° 29'	37.49
a - r ₁	177° 01'	3.40
r ₁ - r ₂	93° 00'	13.12
r ₂ - r ₃	145° 44'	13.83
r ₃ - r ₄	194° 03'	17.34
r ₄ - r ₅	134° 28'	9.31
r ₅ - r ₆	184° 07'	11.68
r ₆ - r ₇	153° 19'	19.94
r ₇ - d	58° 29'	6.22

See over for Notes.

SCALE 1: 1000

○ Denotes iron put except otherwise stated

Bearings are Cassini Grid based on Solar Observations

Approved *[Signature]*
Director of Surveys
2004/11/3

Reference: Plan R.H. 74

SCALE 1: 2000

Distances are in metres

○ Denotes iron put except otherwise stated

Bearings are Cassini Grid based on Solar Observations

No.	Transferee	CT. Vol.	Fol.
7	SONNYBOY SIRJU & DRS.	3789	265
8	SONNYBOY SIRJU & DRS.	3789	257

PLAN of 2 parcels of land coloured pink in the Ward of Siparia
Containing together two thousand three hundred and ninety four point three square metres
Surveyed by me, with due authority, in December 2002
In accordance with Regulation 25(1) of the Land Surveyors' Regulation 1998,
I certify that this plan is correct.

Checked by *[Signature]*
Entered
Trinidad & Tobago Land Surveyor *[Signature]* 12/12/2002



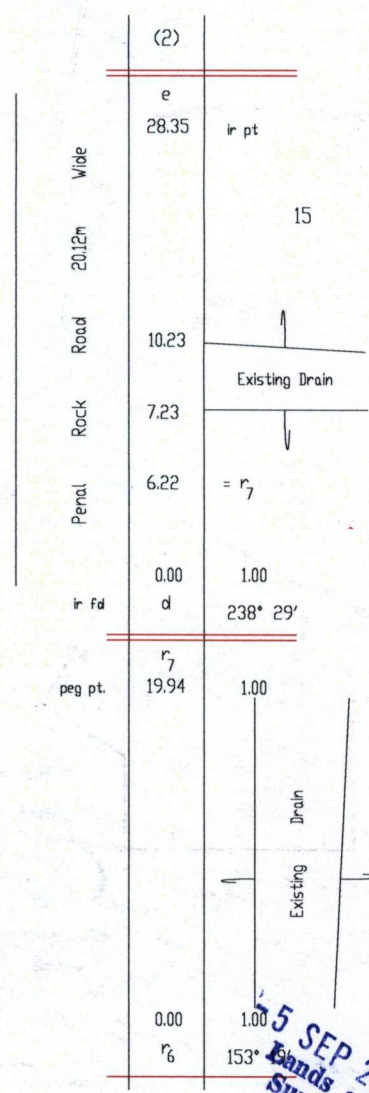
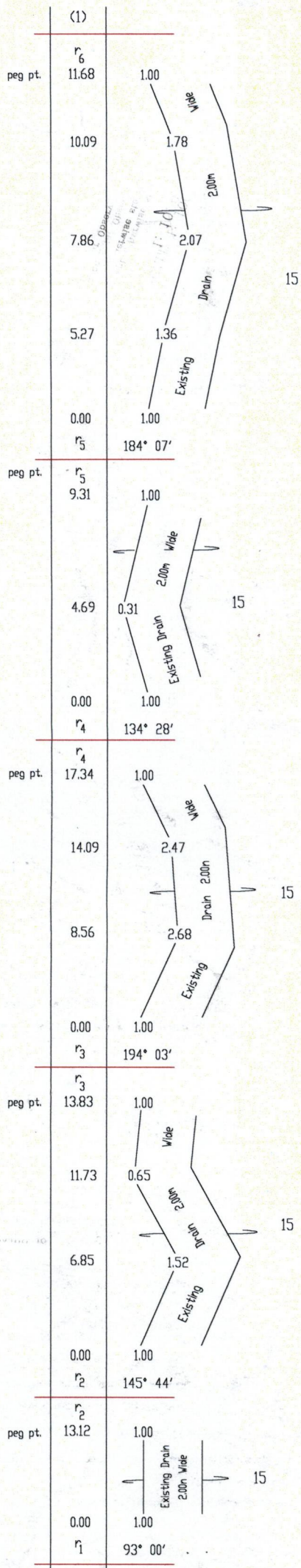

5 SEP 2003
 Lands and
 Surveys
 Division

1195/77