

1195

40

Cadastral Sheet E.1.C. & D. 25E
Ward of Tamana 2/c
County of St. Andrew.

R.P.O. Vol. 113 Fol. 449
C.T. Vol. 3652 Fol. 169
Vide Bk. 1053 Vol. II fol. 49

" " 1196 " 639

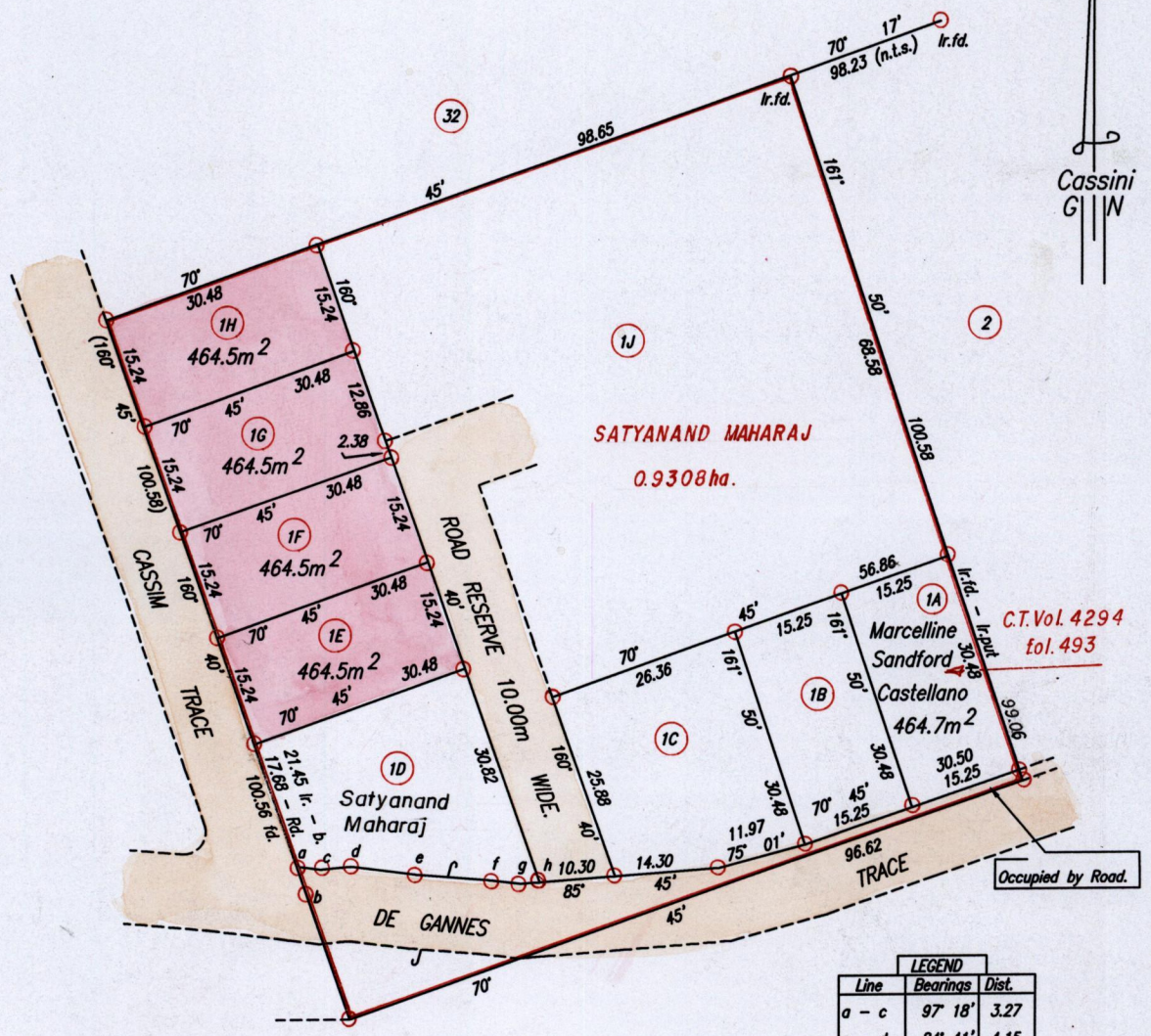

Approved *[Signature]*
Director of Surveys
2004.9.14

SCALE 1:1000
Distances are in Metres

○ Denotes Iron put except otherwise stated.
Bearings are Cassini Grid based on Solar Observations.

PLAN of 4 Parcels of land coloured pink in the Ward of Tamana
Containing together one thousand, eight hundred and fifty eight point zero square metres.
Surveyed by me, with due authority, on June 24th. 1999
In accordance with Regulation 25(1) of the Land Surveyors' Regulations 1998,
I certify that this plan is correct.

Checked by *[Signature]*
Trinidad & Tobago Land Surveyor



Entered 5/7 Trinidad & Tobago Land Surveyor 2004