

Bk 1159 Fol.112

Sapphire Irvine

James Kerr

See Bk 540 Fol 205

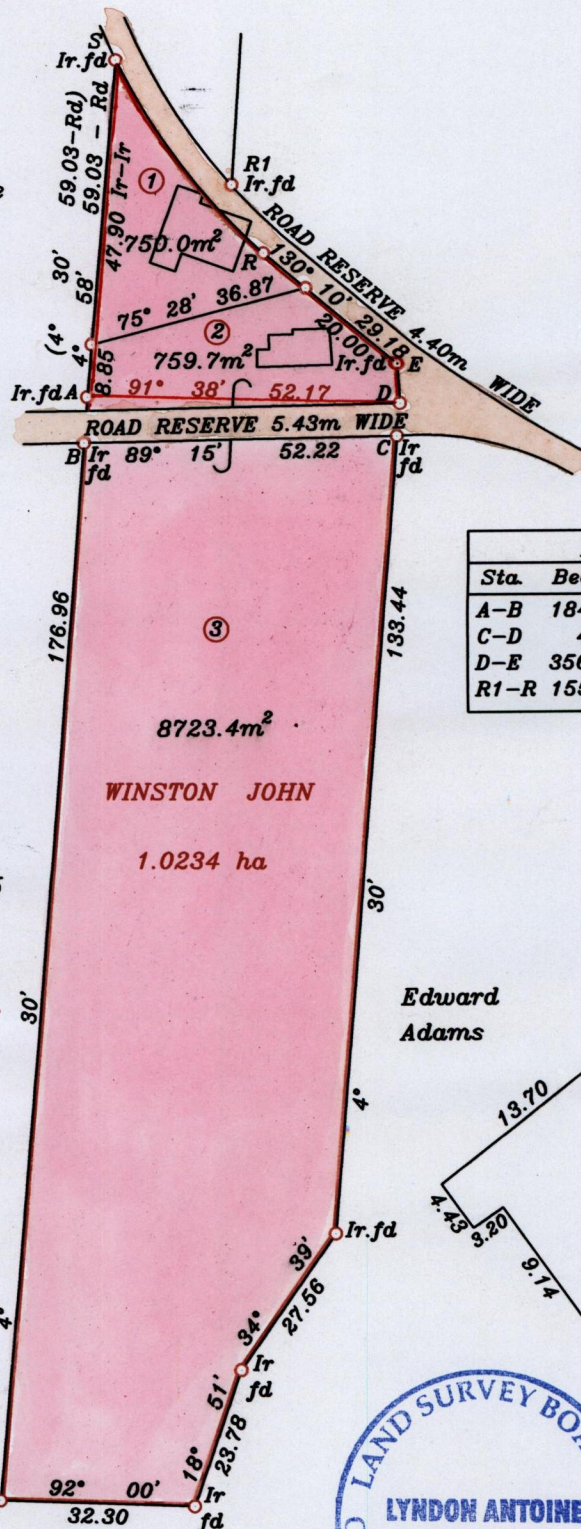

LEGEND		
Sta.	Bearing	Distance
A-B	184° 24'	7.73
C-D	4° 58'	5.54
D-E	356° 23'	6.67
R1-R	155° 26'	12.63

S	Ir. fd
40.75	
2.0	20.55
4.49	17.68
2.04	13.90
3.30	13.08
7.96	
5.46	
4.42	
0.00	323° 00'
R	Ir. pt



Approved

Director of Surveys

2004.9.29

○ Denotes iron put, except otherwise stated.

Bearings are grid based on solar observations

Distances are in metres

SCALE 1:1250

PLAN of 3 parcels of land coloured pink in the Ward of Tobago  
 Containing together one point zero two three three hectares.  
 Surveyed by me, with due authority on 1st December 2000.

In accordance with Regulation 25 (1) of the Land Surveyors' Regulations 1998, I certify that this plan is correct.

Checked by: MZ  
 Entered:.....

Lyndon Antoine

Trinidad & Tobago Land Surveyor..... 12<sup>th</sup> July 2004

path: 96SURVEY\WJOHN\WJOHN.dwg