

R.P.O. Vol. 426 Fol. 403
C.T. Vol. 2253 Fol. 499

Ward of Matura
County of St Andrew
Cadastral Sheet C.18.E. (16D)
4/a

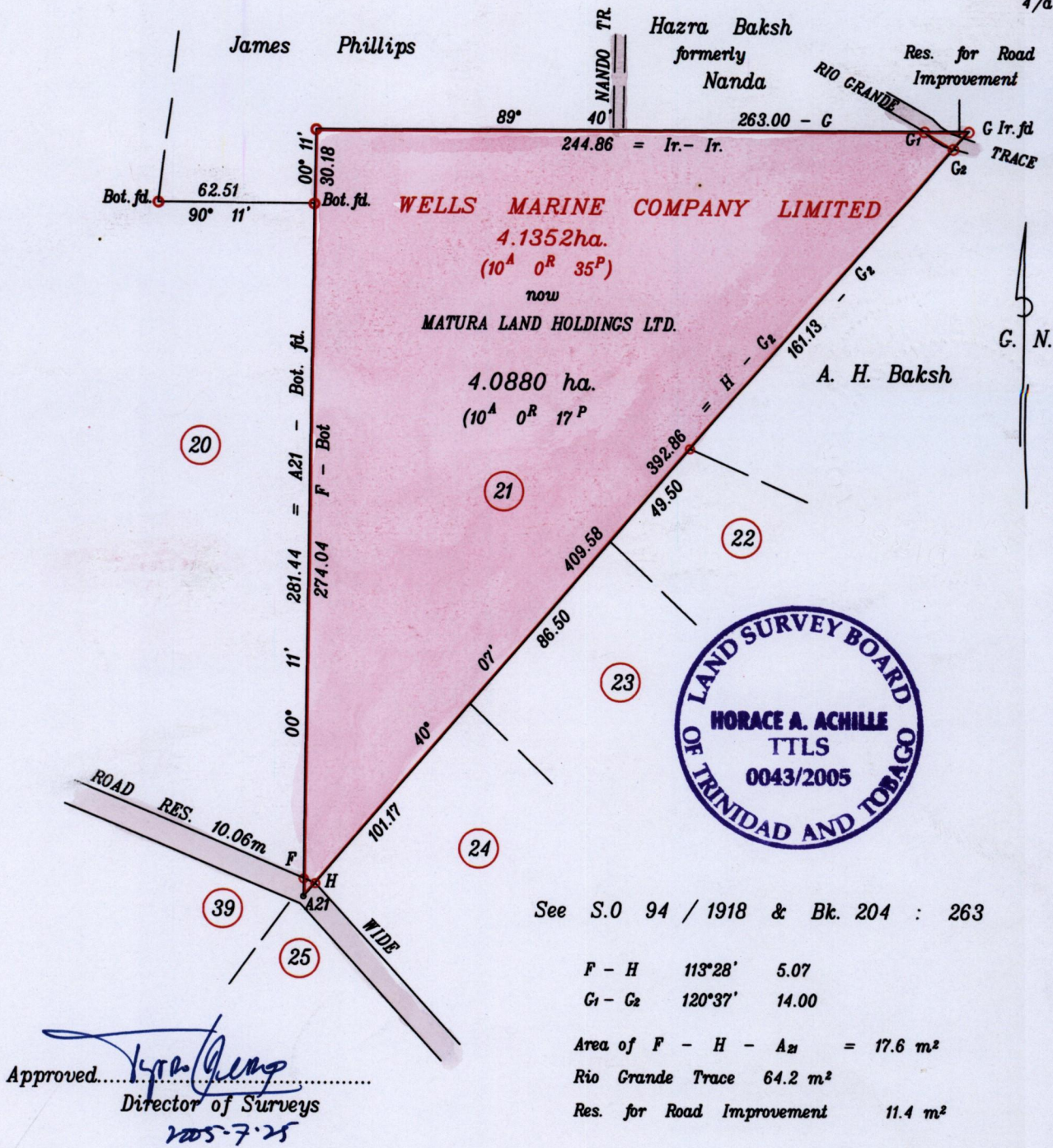

○ Denotes Iron put, except where otherwise stated.

Note : To obtain compass bearing subtract

minutes

Scale : 1:2500

Distances are in metres

PLAN of a Parcel of land coloured pink in the Ward of Matura
Containing four point zero eight eight zero hectares.

Surveyed by me, with due authority in March 1984.

In accordance with Reg. 25(1) of the Land Surveyors Regulations 1998,
I certify that this plan is correct.

Checked by.....
mm. 12/7/05

Horace A. Achille T.T.L.S.

Entered.....

Trinidad & Tobago Land Surveyor.. 8th June 2005