

1195

203

1195/283

R.P.O. Vol. 150. Fol. 377.

Cadastral Sheet G.17.C. 73B
1/c

C.T. Vol. 2323. Fol. 523.

Ward of Siparia

County of St. Patrick

Vide Bk. 1124 Fol.103

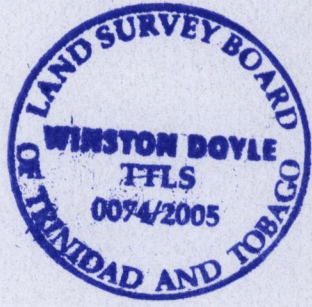
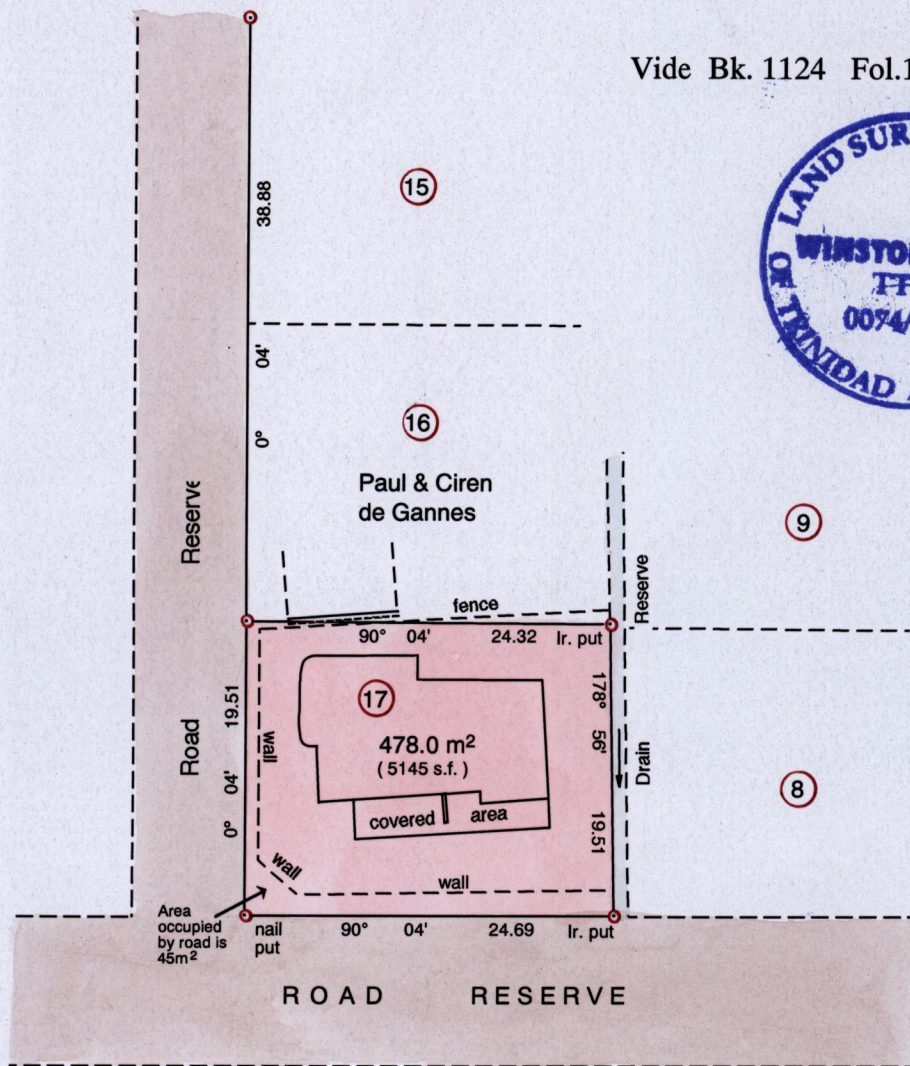

Approved *[Signature]*
 Director of Surveys
 2005-6-27

SCALE 1 : 500

Distances are in metres

○ Denotes Iron Found unless otherwise stated

Bearings are Cassini Grid based on Solar Obs.
 To obtain compass bearings subtract 4 minutes

PLAN of a Parcel of land coloured pink in the Ward of Siparia
 Containing four hundred and seventy eight point zero square metres
 Surveyed by me, with due authority, in September 2004

In accordance with regulation 25 (1) of the Land Surveyors' Regulations 1998,
 I certify that this plan is correct.

Checked by *[Signature]* 17/6/05

Entered on.....

[Signature]
 Trinidad & Tobago Land Surveyor 25th April 2005