

Cadastral Sheet C.14.C. $\frac{16}{b}$
 Ward of Matura
 County of St. Andrew
 Vide : Bk. 1014 Fol. 223
 Bk. 1141 Fol. 85
 Bk. 1176 Fol. 69

R.P.O. Vol. 483 Fol. 265
 C.T. Vol. 2852 Fol. 589

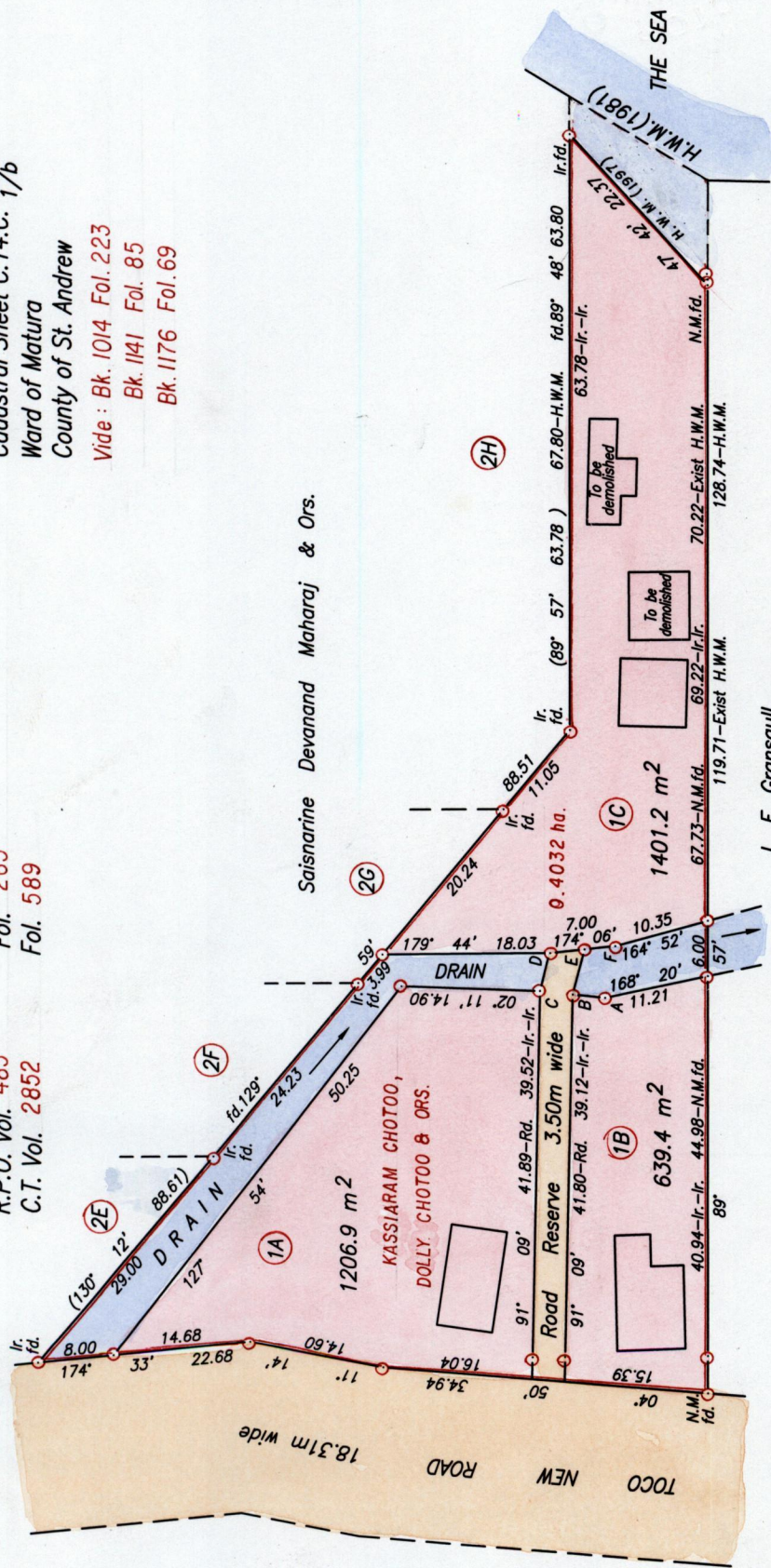
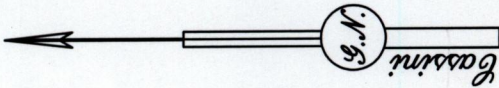

Line	Bearings	Dist.
A-B	06° 16'	3.48
B-C	06° 16'	3.51
C-D	103° 30'	4.20
D-E	174° 06'	3.70
E-F	174° 06'	3.30

Approved: *[Signature]*
 Director of Surveys
 2005-6-17



SCALE 1/750
 Distances are in metres

○ Denotes Iron put except otherwise stated
 Bearings are Cassini Grid based on Solar Observations
 Plan of 3 Parcels of land coloured pink in the Ward of Matura
 Containing together three thousand two hundred and forty seven point five square metres
 Surveyed by me, with due authority, on July 19th. 1997
 In accordance with Regulation 25 (1) of the Land Surveyors' Regulations 1998,
 I certify that this plan is correct.

[Signature]
 L. E. Gransaul
 Checked by: *[Signature]*
 Entered on: ... Trinidad & Tobago Land Surveyor. ... 30/1/04. 2008