

1195

264

R.P.O. Vol. 12
C.T. Vol. 2066

Fol. 505
Fol. 85

Ward of Savana Grande
County of Victoria
Cadastral Sheet D.24.O. 54C
3/a

Vide: Bk. 1002/83

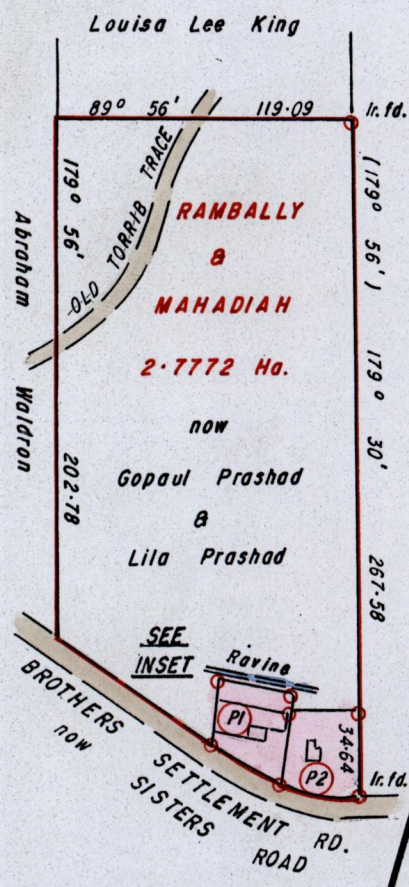

Elvira Moore
now
Pooran Pariag
Bk. 1014/54
Bk. 1157/73

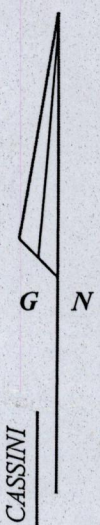
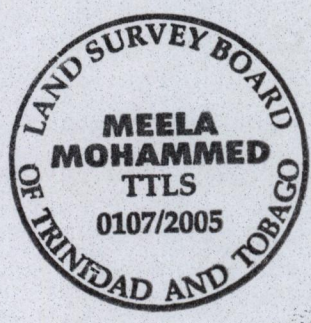

INSET

Scale: 1 / 3000

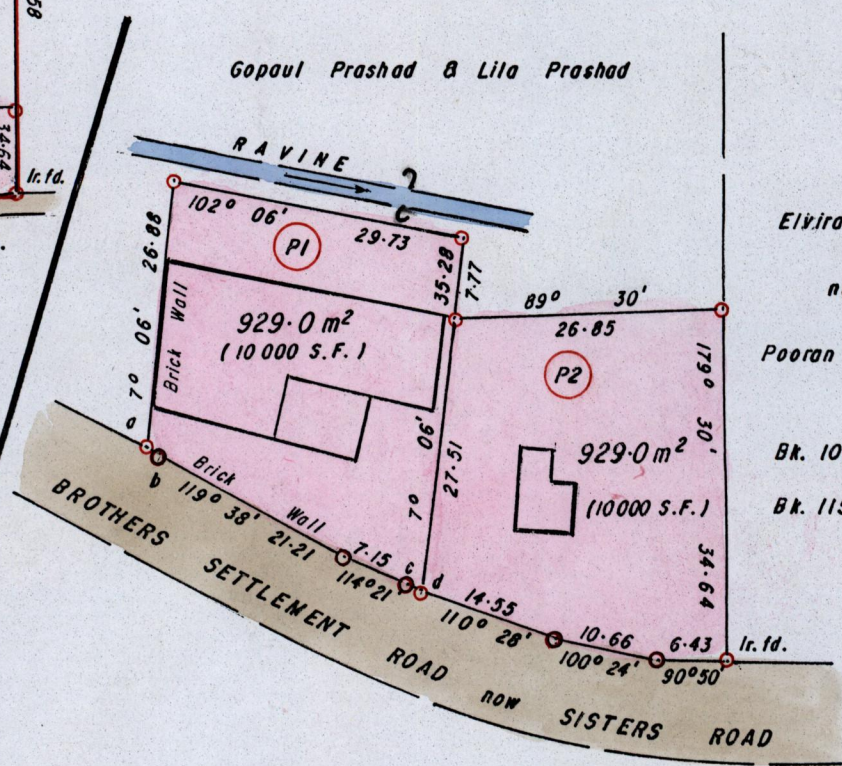

Elvira Moore
now
Pooran Pariag
Bk. 1014/54
Bk. 1157/73

a - b 109° 33' 1.17
c - d 110° 28' 2.11

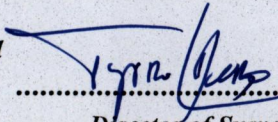
Approved 
Director of Surveys
2005-6.13

○ Denotes Iron put unless otherwise stated
Bearings are Cassini Grid based on Solar Obs.
SCALE 1 / 750 (INSET)
Distances are in METRES

Note: To Obtain compass bearings add/subtract minutes

PLAN of 2 Parcels of land coloured PINK in the Ward of Savana Grande
Containing together zero point one eight five eight hectare
Surveyed by me, with due authority, in November 2004
In accordance with Regulation 25 (1) of the Land Surveyors' Regulations 1998,
I certify that this plan is correct.

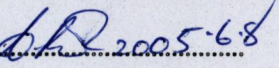
Checked by  Meela Mohammed

Entered Trinidad and Tobago Land Surveyor... 28th. February 2005