

R.P.O. Vol. 243 Fol. 149
 C.T. Vol. 1924 Fol. 335

Ward of Siparia
 County of St. Patrick
 Cadastral Sheet (G.13.P) 63.F.
 4/d

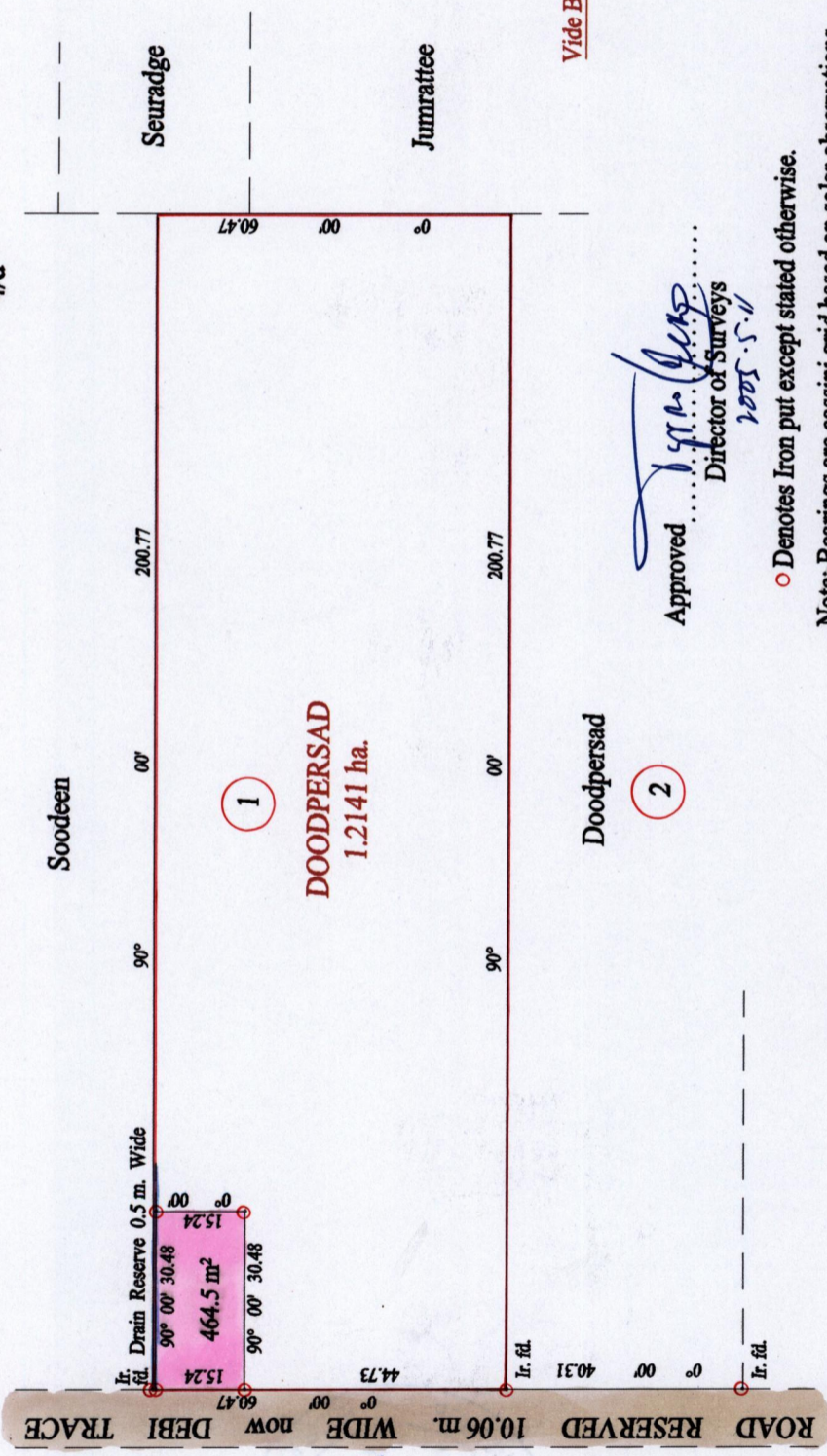

Vide Bk. 1017 fol. 34

Approved
 Director of Surveys
 2005.5.11

○ Denotes Iron put except stated otherwise. SCALE : 1:1250
 Note: Bearings are cassini grid based on solar observations Distances are in metres
 PLAN of a Parcel of land coloured pink in the Ward of Siparia
 Containing four hundred and sixty four point five square metres
 Surveyed by me, with due authority, in May 2004
 In accordance with Regulation 25 (1) of the Land Surveyors' Regulations 1998
 I certify that this plan is correct.

Checked by M.H. 9/5/05
 Entered on Trinidad & Tobago Land Surveyor 14: 12 2004



1195/246

246