

1195

195/238

233

U.P.R.N No.....

R.P.O. Vol. 181

C.T. Vol. 1107

Fol. 193

Fol. 207

Cadastral Sheet (D.10.E.)

Ward of San Rafael

County of St. George

34 C
4/c

REMAINING PORTION

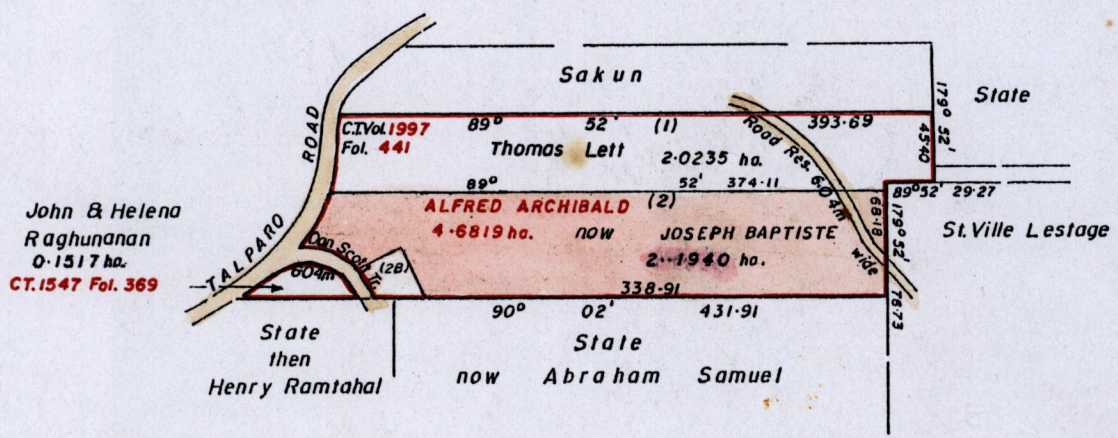
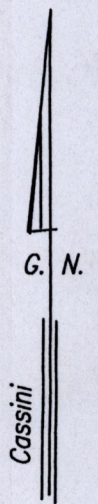

(2B)
 C.T. Vol. 4105 Fol. 333
 Selma Baptiste Charles
 & Nimrod Charles
 924.7m²

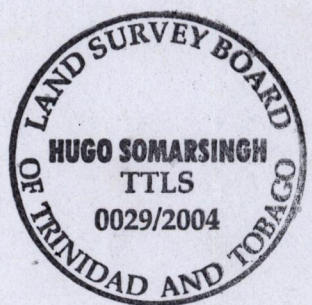

Approved by *[Signature]*
 Director of Surveys
 2005.4.26

SCALE 1/5000
 Distances are in metres

Note to obtain compass bearings add/subtract minutes

This is a true copy of a diagram of four point six eight one nine hectares Originally transferred to ALFRED ARCHIBALD showing a portion coloured pink and containing two point one nine four zero hectares being the remainder after three previous transfers of another portion of land.

In accordance with Regulation 25 (1) of the Land Surveyors' Regulations 1998, I certify that this plan is correct.

Checked by *[Signature]* 2005.4.25

Entered on..... Trinidad and Tobago Land Surveyor..... 2004