

RPO Vol. 103 Fol. 599
CT. Vol. 1160 Fol. 221

Ward of Siparia
County of St. Patrick
Cadastral Sheet (G.13.N), $\frac{63F}{3/c}$ & $\frac{73C}{1/a}$

1195/162

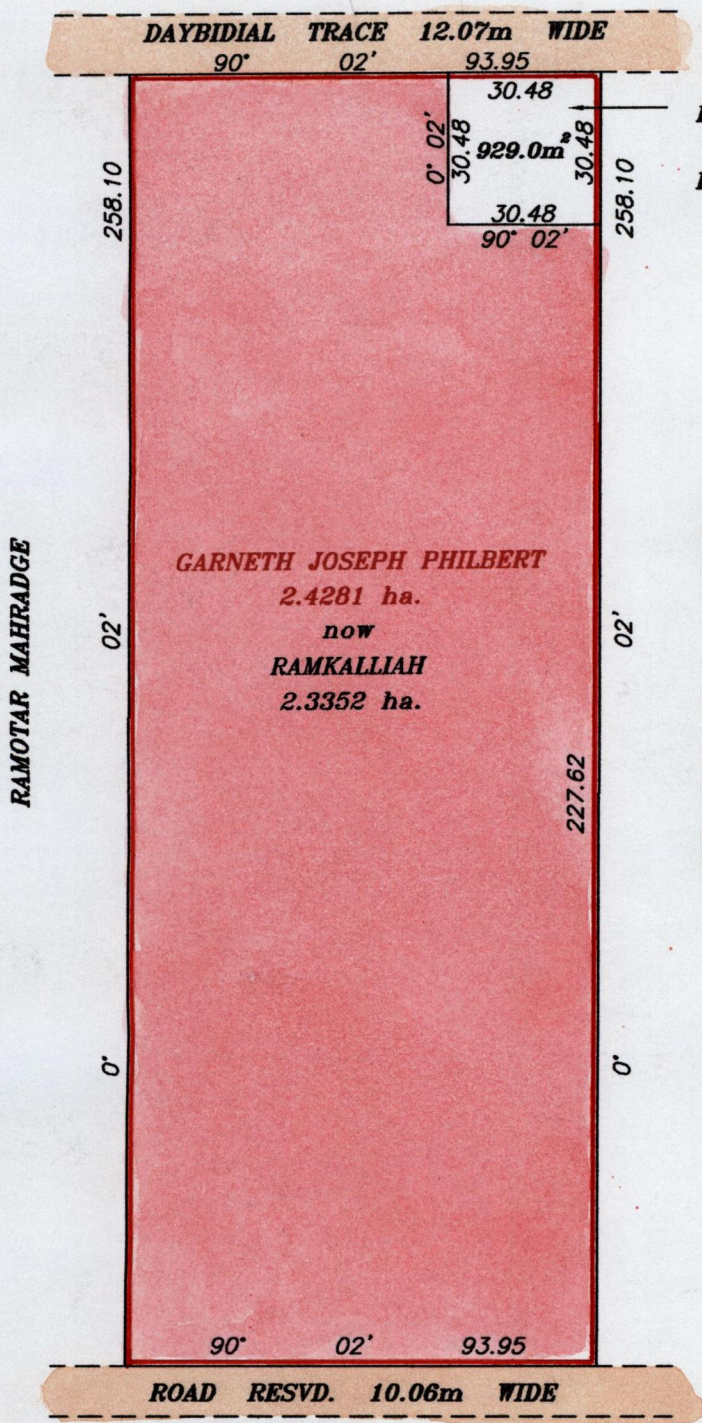

RAMESH DEOKIESINGH
&
LILAWATIE DEOKIESINGH
CT Vol. 2966 Fol. 19



Approved [Signature]
Director of Surveys

Ref. Bk. 886 Fol. 197
Bk. 1148 Fol. 77

SCALE 1 : 1500

Note : To obtain compass bearing subtract 2 minutes.

Distances are in metres

This is a true copy of a diagram of two point four two eight one hectares originally transferred to Garneth Joseph Philbert showing a portion coloured pink and containing two point three three five two hectares being the remainder after one (1) previous transfer of a portion of the land.

In accordance with Regulation 25 (1) of the Land Surveyors' Regulations 1998,

I certify that this plan is correct.

Checked by [Signature] 2005.1.28

Trinidad & Tobago Land Surveyor

Entered on

