

R.P.O. Vol. 4 Fol. 565  
 C.T. Vol. 970 Fol. 377

U.P.R.N. No. ....

Ward of Siparia  
 County of St. Patrick  
 Cadastral Sheet 63A (G.7.M.)  
 4/c

Location

References  
 Book 897 Fol. 147  
 Book 759 Fol. 276  
 Book 456 Fol. 179  
 Book 456 Fol. 51  
 Book 456 Fol. 116  
 Book 456 Fol. 67

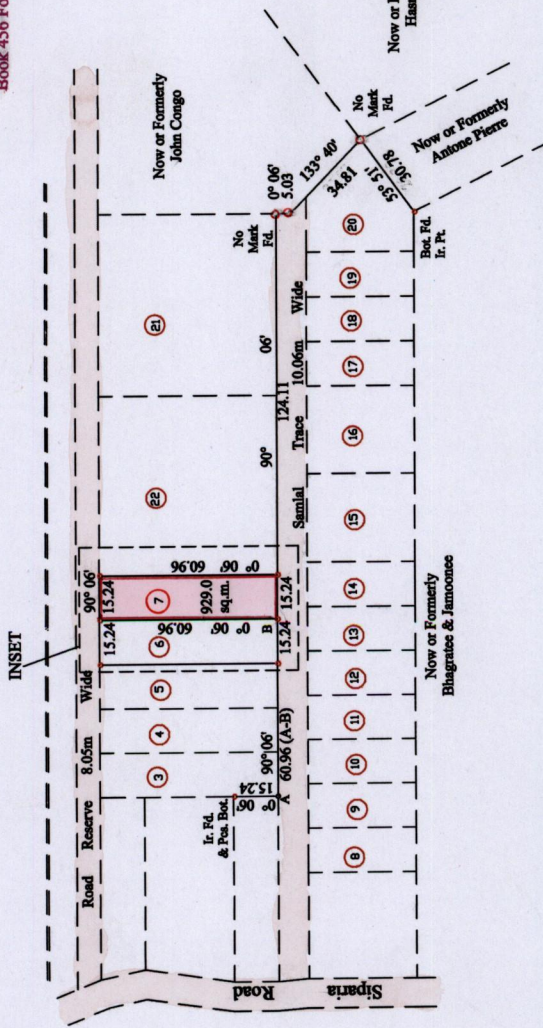

Scale 1:2,500

To obtain compass bearings subtract 6 minutes.  
 Bearings are Cassini Grid based on solar observations  
 PLAN of a parcel of land coloured pink in the Ward of Siparia.  
 Containing Nine Hundred and Twenty Nine square metres.  
 Surveyed by me, with due authority, in October, 2003, for Hamid, Zohora & Razif Mohammed  
 In accordance with Regulation 25(1) of the Land Surveyors' Regulations 1998.  
 I certify that this plan is correct.

Approved by *[Signature]*  
 Director of Surveys

2005.2.2

Checked by *[Signature]*

Entered on .....

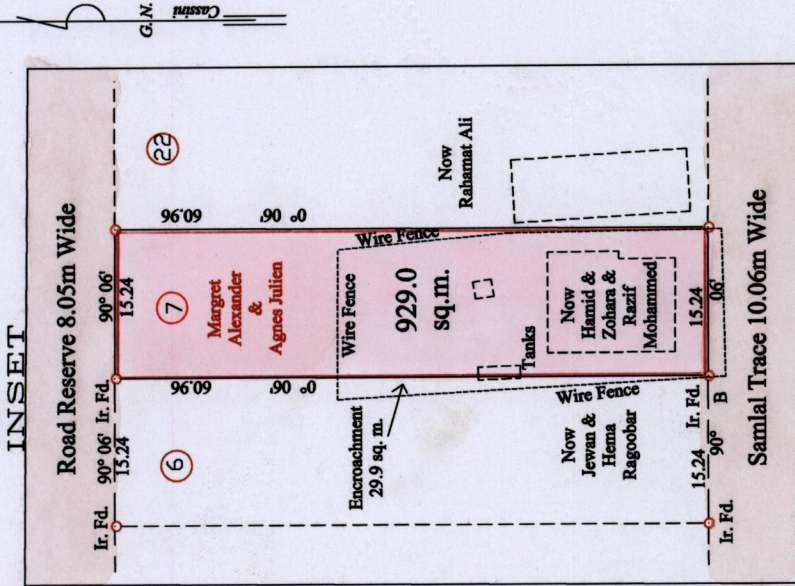
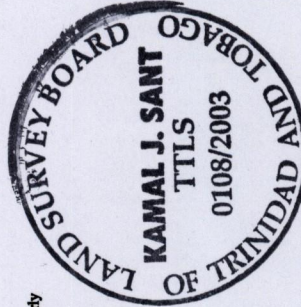

Scale 1:750

Distances are in metres  
 ○ Denotes iron put unless otherwise stated

Trinidad & Tobago Land Surveyor *[Signature]*

6th November 2003

1195  
 1195/156

156