

1195

128

Ward of Naparima
County of Victoria
Cadastral Sheet 63C
3/c (G.8.N)

R.P.O. Vol. 46 Fol. 331

C.T. Vol. 2830 Fol. 567

U.P.R.N. No.

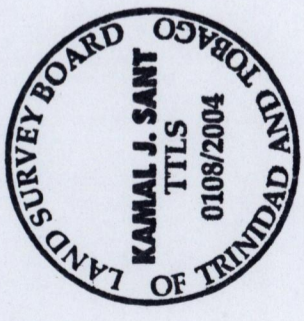

References
Bk. 940 Fol. 6 Bk. 722 Fol. 165
Bk. 944 Fol. 59
Bk. 715 Fol. 29 Plan P.F. 177
Parcels 10 & 1 to be amalgamated
Parcels 20 & 2 to be amalgamated

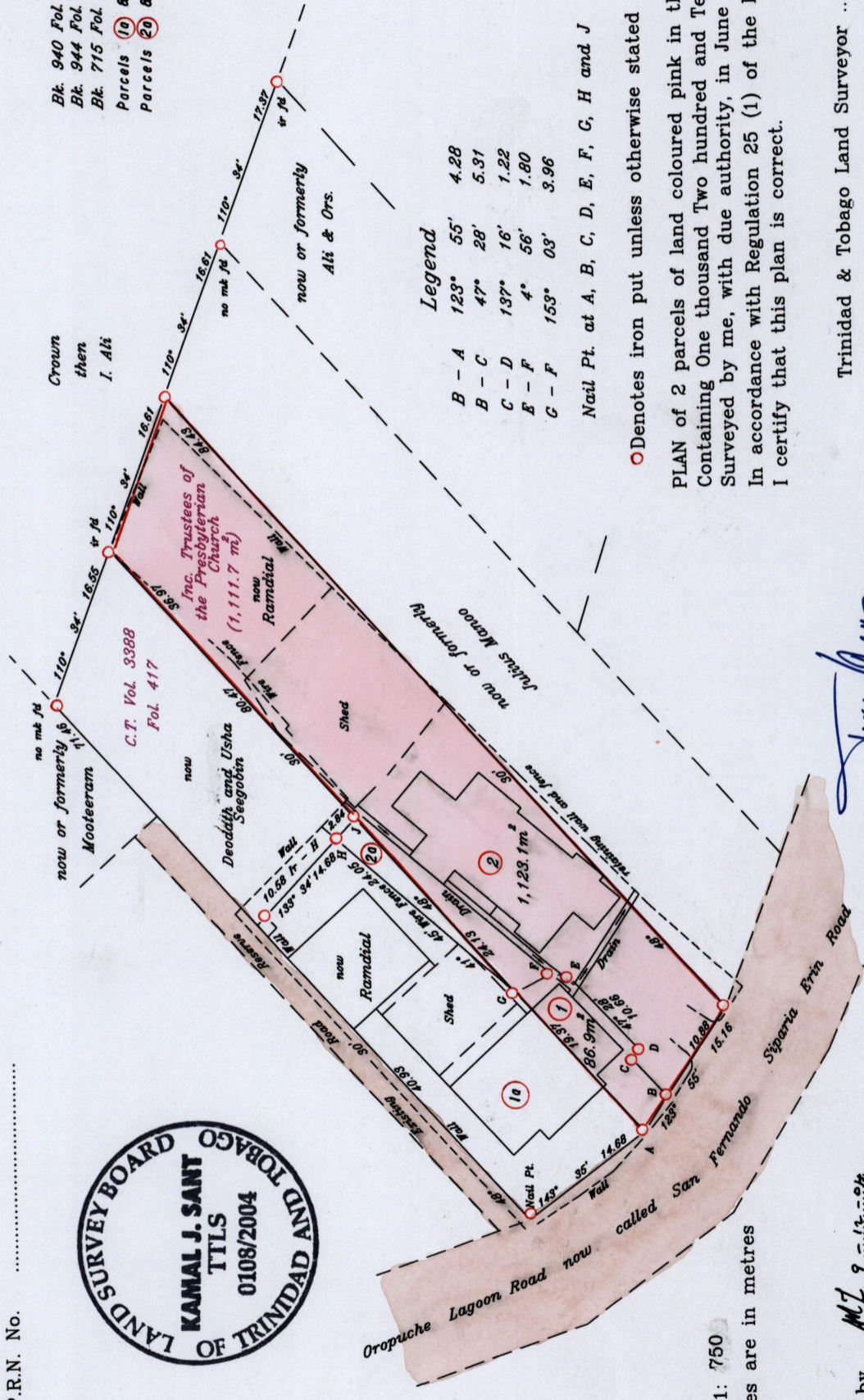

Legend

B - A	123°	55'	4.28
B - C	47°	28'	5.31
C - D	137°	16'	1.22
E - F	4°	56'	1.80
G - F	153°	03'	3.96

Nail Pt. at A, B, C, D, E, F, G, H and J

○ Denotes iron put unless otherwise stated

PLAN of 2 parcels of land coloured pink in the ward of Naparima. Containing One thousand Two hundred and Ten point Zero square metres. Surveyed by me, with due authority, in June 2004. In accordance with Regulation 25 (1) of the Land Surveyors' Regulations 1998, I certify that this plan is correct.

Checked by *M.L. 2-14-04*
Entered by

Approved
[Signature]
Director of Surveys
2004.12.14

Trinidad & Tobago Land Surveyor
[Signature]
2004