

1195

127

Ward of Naparima
County of Victoria
Cadastral Sheet 63C
3/c (G.8.N)

R.P.O. Vol. 45 Fol. 331
C.T. Vol. 519 Fol. 263

U.P.R.N. No.

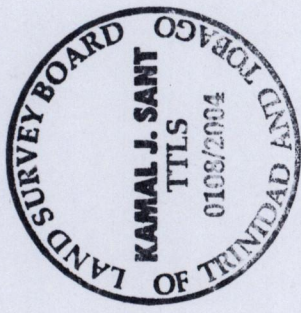

References
Bk. 940 Fol. 6 Bk. 722 Fol. 165
Bk. 944 Fol. 59 Bk. 535 Fol. 177
Bk. 715 Fol. 29 Plan P.F. 177
Parcels (10) 8 (1) to be amalgamated.
Parcels (20) 8 (2) to be amalgamated.

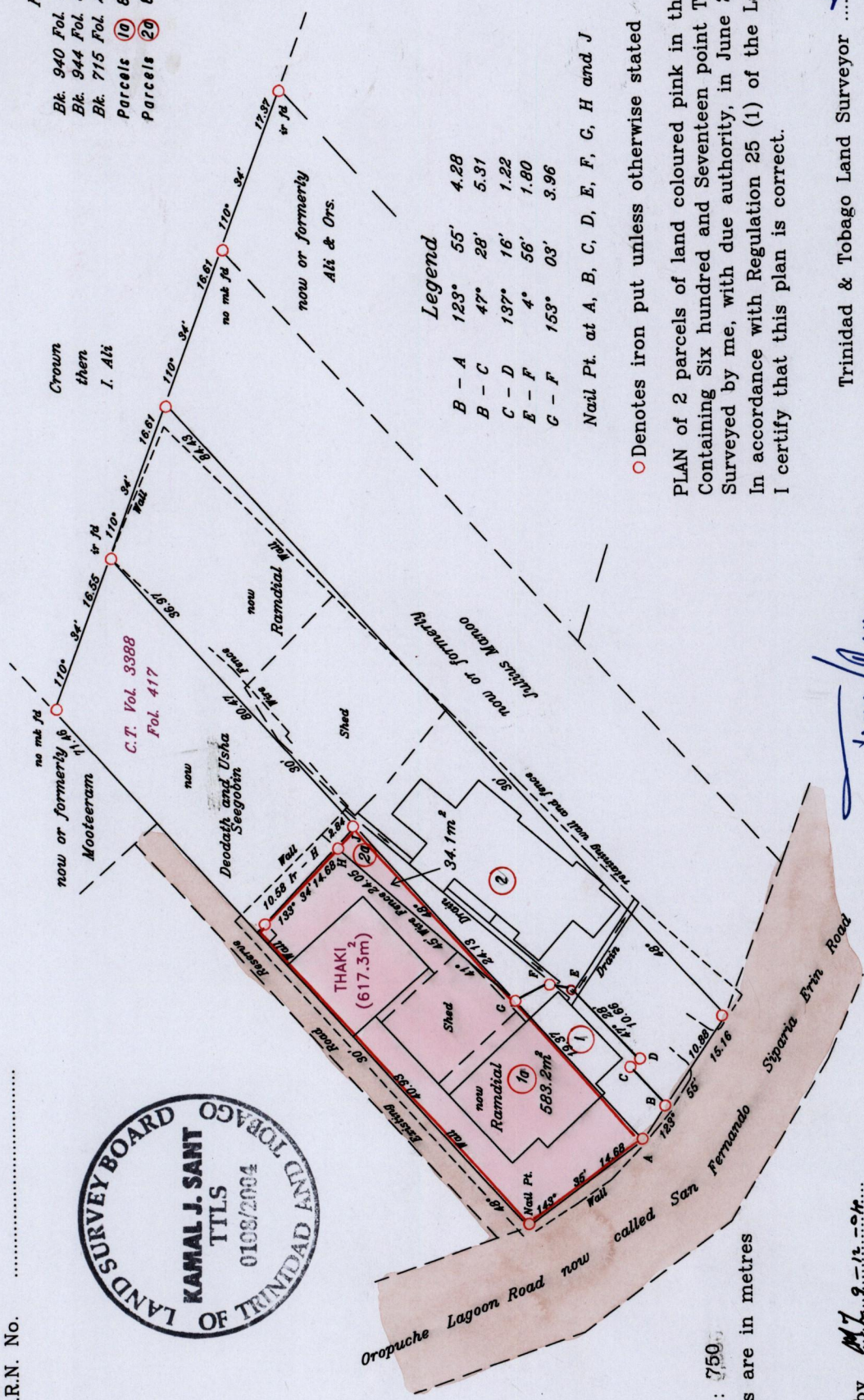

Legend

B - A	123° 55'	4.28
B - C	47° 28'	5.31
C - D	137° 16'	1.22
E - F	4° 56'	1.80
G - F	153° 03'	3.96

Nail Pt. at A, B, C, D, E, F, G, H and J

○ Denotes iron put unless otherwise stated

PLAN of 2 parcels of land coloured pink in the ward of Naparima. Containing Six hundred and Seventeen point Three square metres. Surveyed by me, with due authority, in June 2004. In accordance with Regulation 25 (1) of the Land Surveyors' Regulations 1998, I certify that this plan is correct.

Checked by M.L. ...
Entered by

Approved
[Signature]
Director of Surveys
2004.12.14

Trinidad & Tobago Land Surveyor
[Signature]
07th Sunday, 2004