

1195

1195/114

114

R.P.O. Vol. 46
C.T. Vol. 3264

Fol. 163
Fol. 33

Cadastral Sheet G.12.G. $\frac{63 D}{2/d}$, $\frac{63 E}{1/c}$
Ward of Siparia
County of St. Patrick

Vide : Bk. 1163 Fol. 143

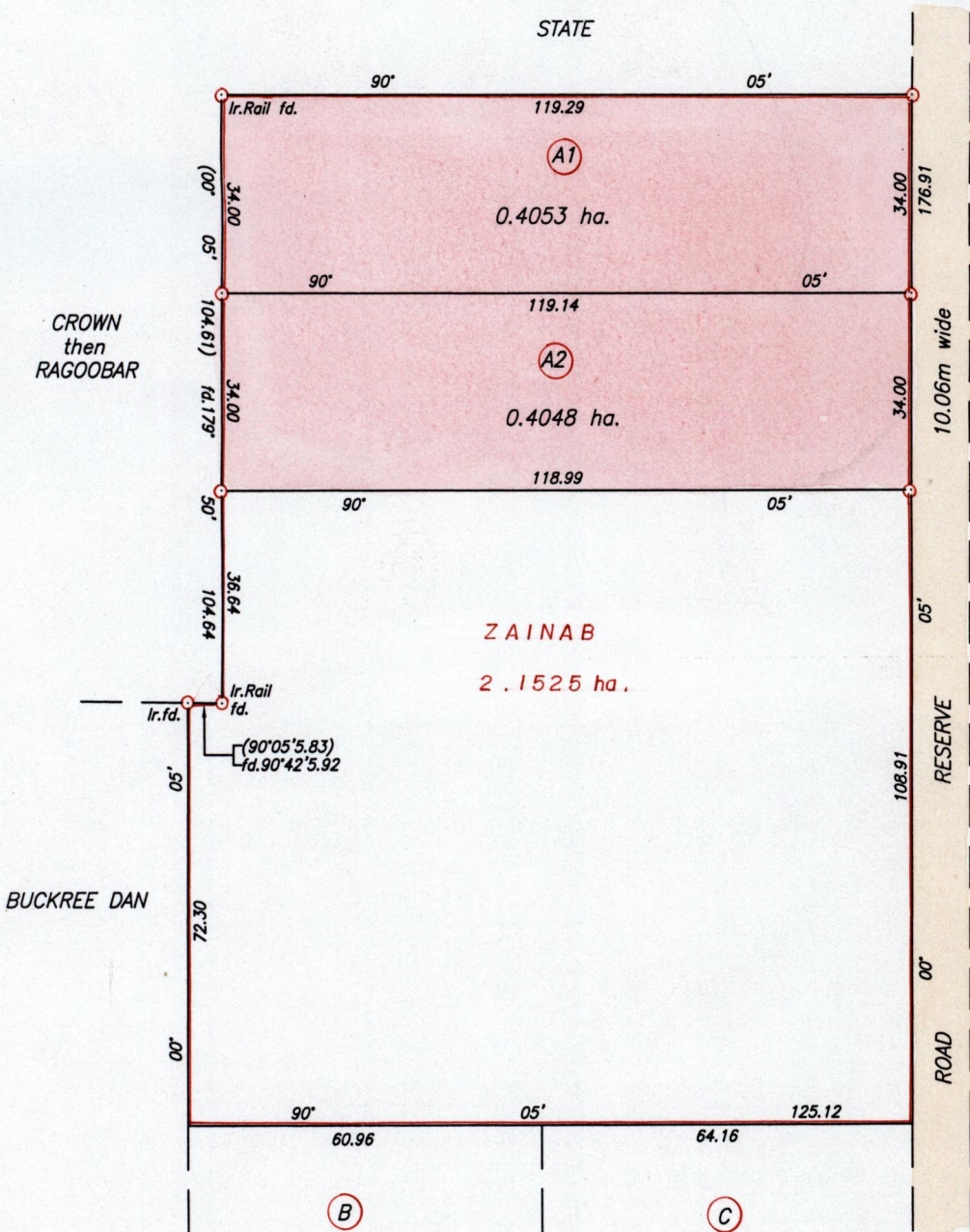

Approved *[Signature]*
Director of Surveys

2004-11-29

SCALE 1/1250
Distances are in metres

○ Denotes Iron put except otherwise stated
Bearings are Cassini Grid based on Solar Observations
Plan of 2 Parcels of land coloured pink in the Ward of Siparia
Containing together zero point eight one zero one hectare
Surveyed by me, with due authority, on March 16th. 2004
In accordance with Regulation 25 (1) of the Land Surveyors' Regulations 1998
I certify that this plan is correct.



Entered on *[Signature]*
Checked by *[Signature]* 16-11-04. Trinidad & Tobago Land Surveyor *[Signature]* 23/9. 2004