

No 9885

R.P.O. Vol.
C.T. Vol. 1990

Fol.
Fol. 229

Ward of St. Anns.
County of St. George
Cadastral Sheet B.17.J (13F)

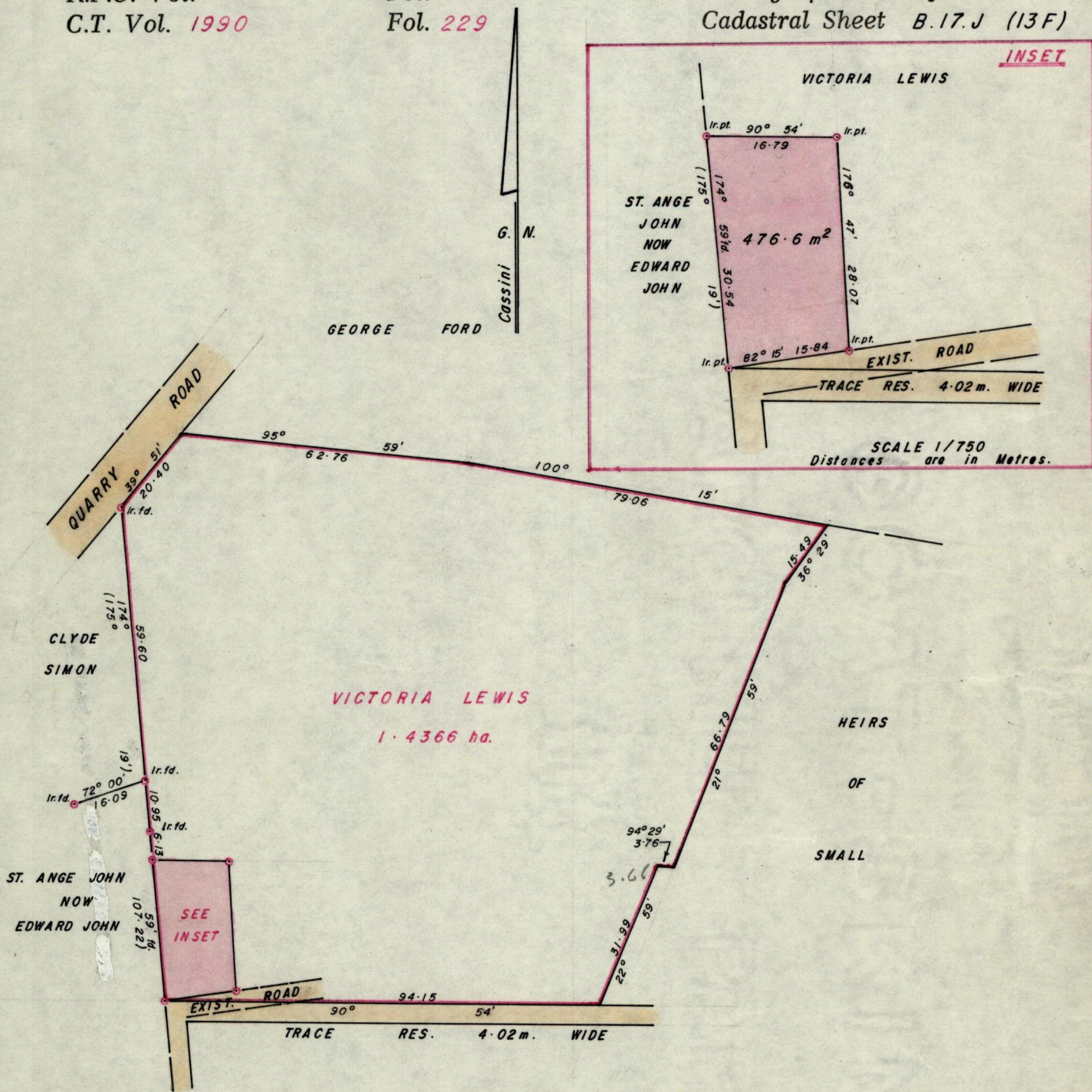

Approved

K.B. Joseph
Director of Surveys
86.7.15

Bearings are Cassini Grid, based on Solar Obs.
Note: To obtain compass bearings add/subtract

SCALE 1/1250
minutes

Distances are in Metres.

PLAN of a Parcel of land coloured Pink in the Ward of St. Anns
Containing four hundred and seventy six point six square metres.
Surveyed by me, with due authority, in June 1986
I certify that I have complied with rule 76 under section 14(2)(d) of the
Land Surveyors' Ordinance 1952, and that this plan is correct.

Checked by *TD 86.7.11* *J. Marshall*
Entered Land Surveyor, Trinidad 20th JUNE 1986