

R. P. O. Vol. 190.  
C.T. Vol. 1382.

Ward of Naparima.  
County of Victoria.  
Cadastral Sheet 63B  
G. 7. P. 3/6

SEE BK 926. FOL. 287

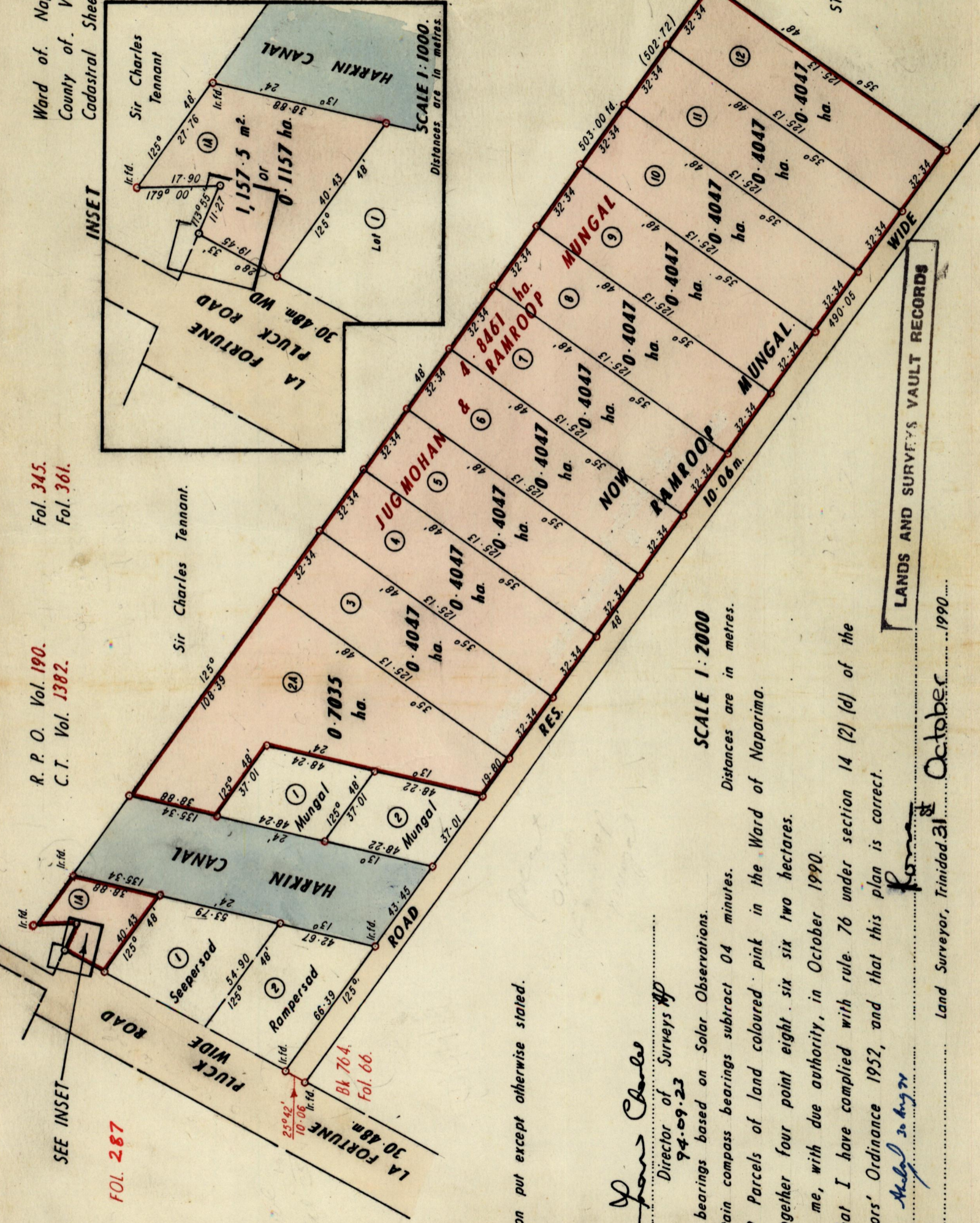

1155

781

○ Denotes iron put except otherwise stated.

Approved *John Charles*  
Director of Surveys 94-09-23

Cassini Grid bearings based on Solar Observations.

Note: To obtain compass bearings subtract 04 minutes. Distances are in metres.

PLAN OF 12 PARCELS OF LAND COLOURED PINK IN THE WARD OF NAPARIMA.  
Containing together four point eight six six two hectares.

Surveyed by me, with due authority, in October 1990.

I certify that I have complied with rule 76 under section 14 (2) (d) of the Land Surveyors' Ordinance 1952, and that this plan is correct.

Checked by *Mabel 30 Aug 91*

Entered on *Form* Land Surveyor, Trinidad 31 October 1990

LANDS AND SURVEYS VAULT RECORDS

STATE then  
Lowton

SCALE 1:1000.  
Distances are in metres.

SCALE 1:2000  
Distances are in metres.

INSET

SEE INSET

Cassini  
GRID