

No 28614

R.P.O. Vol. 96
C.T. Vol. 3478

Fol. 249
Fol. 383

Ward of Charuma.
County of Nariva
Cadastral Sheet $\frac{55D}{1/b}$ H.I.G.

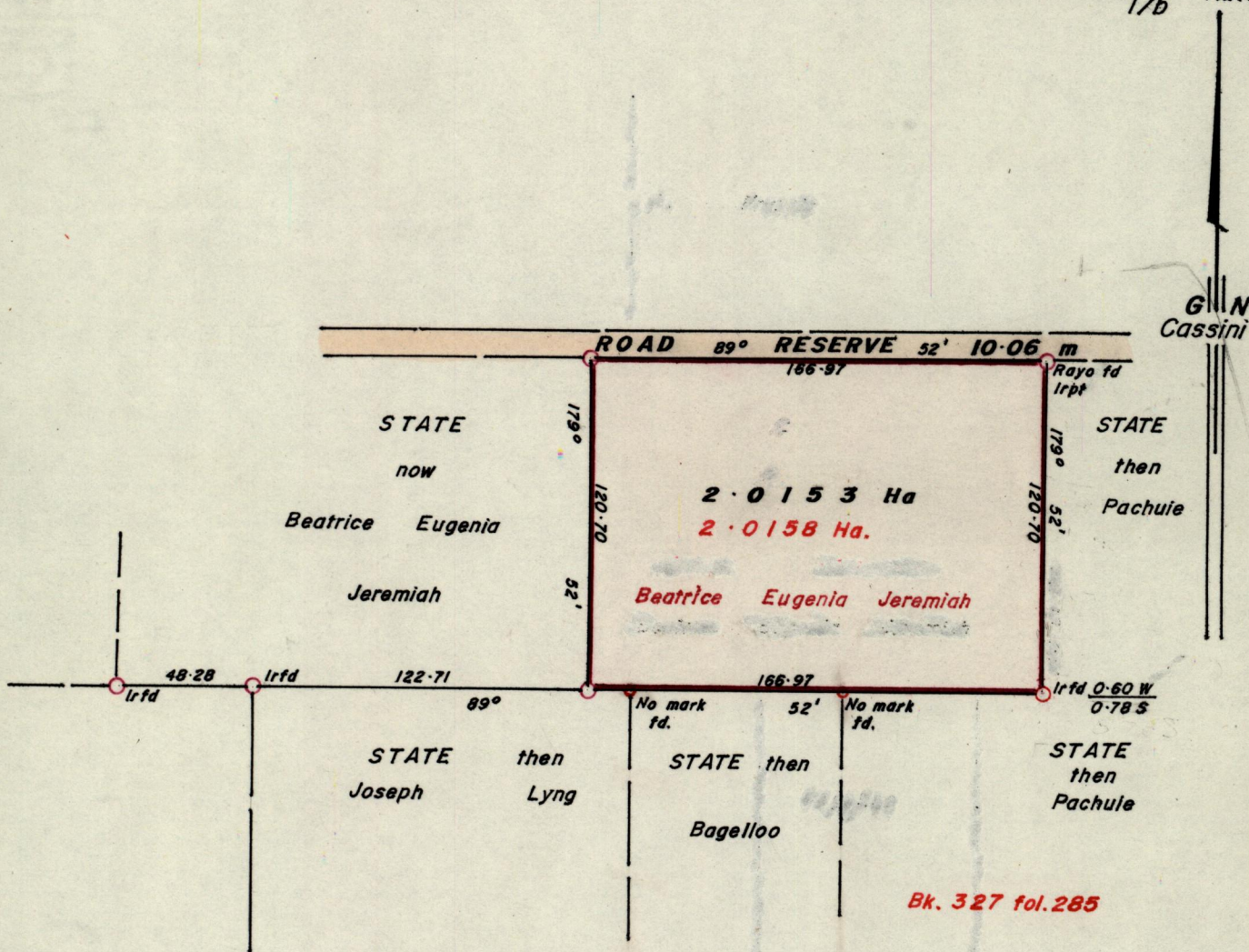

Approved *[Signature]*

Director of Surveys
940316

○ Denotes Iron put except otherwise stated
Bearings based on solar observations

Note: To obtain compass bearings add/minutes

SCALE 1:2500

Distances are in metres.

PLAN of a Parcel of land coloured pink in the Ward of Charuma
Containing two point zero one five three hectares.

Surveyed by me, with due authority, in May, 1993.

I certify that I have complied with rule 76 under section 14(2)(d) of the
Land Surveyors' Ordinance 1952, and that this plan is correct.

Checked by *[Signature]* *[Signature]*

Entered Land Surveyor, Trinidad 19.9.93
and Tobago