

1155

L. & S.—54

645

No 21078

R.P.O. Vol. 28
C.T. Vol. 2167

Fol. 237
Fol. 603

Ward of Naparima
County of Victoria
Cadastral Sheet G.8.N.

Bk. 1003 Fol. 121

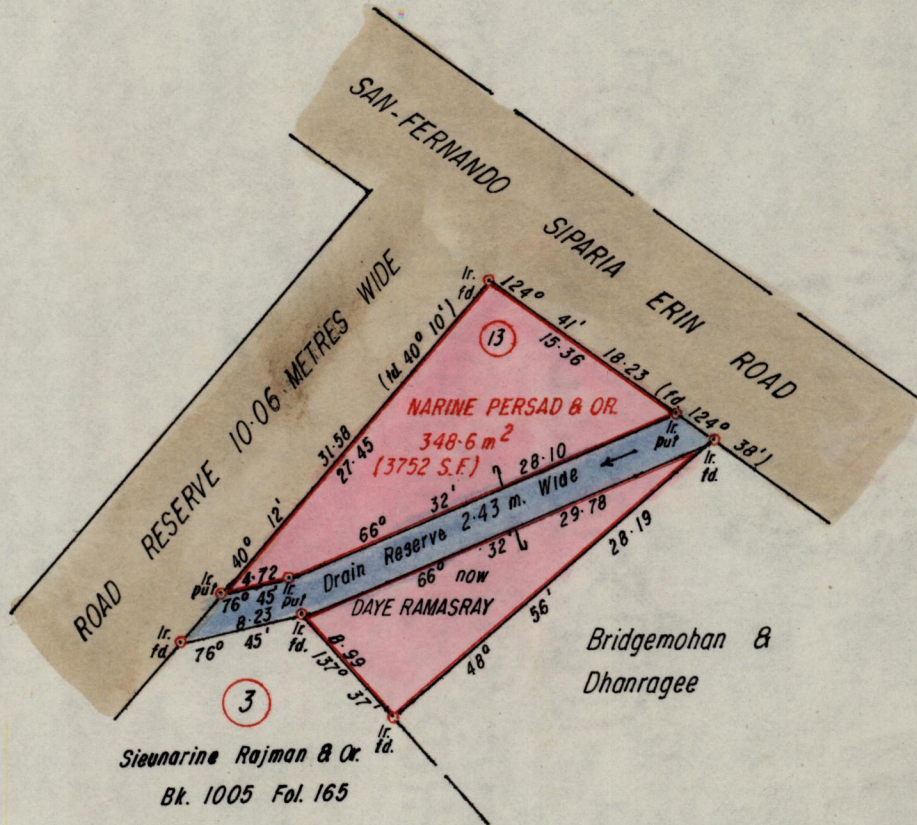

Approved

Calvin Archibald

Director of Surveys
940308

SCALE 1/500

Note: To obtain compass bearings add/subtract 2 minutes Distances are in metres

PLAN of a Parcel of land coloured pink in the Ward of Naparima

Containing three hundred and forty eight point six square metres

Prepared from Surveys done by C.L. Stoute
Surveyed by me, with due authority, in October, 1973

~~I certify that I have complied with rule 76 under section 14(2)(d) of the Land Surveyors' Ordinance 1952, and that this plan is correct.~~

Checked by *H. J. March 7/11*

Albert H. Hayes

Entered

Land Surveyor, Trinidad 4 March 1974
and Tobago