

No 21065

R.P.O. Vol. 190  
C.T. Vol. 2418

Fol. 541  
Fol. 377

Ward of Siparia .  
County of St. Patrick .  
Cadastral Sheet G. 13. G.  
63. F.  
1/d.82/k .

G N

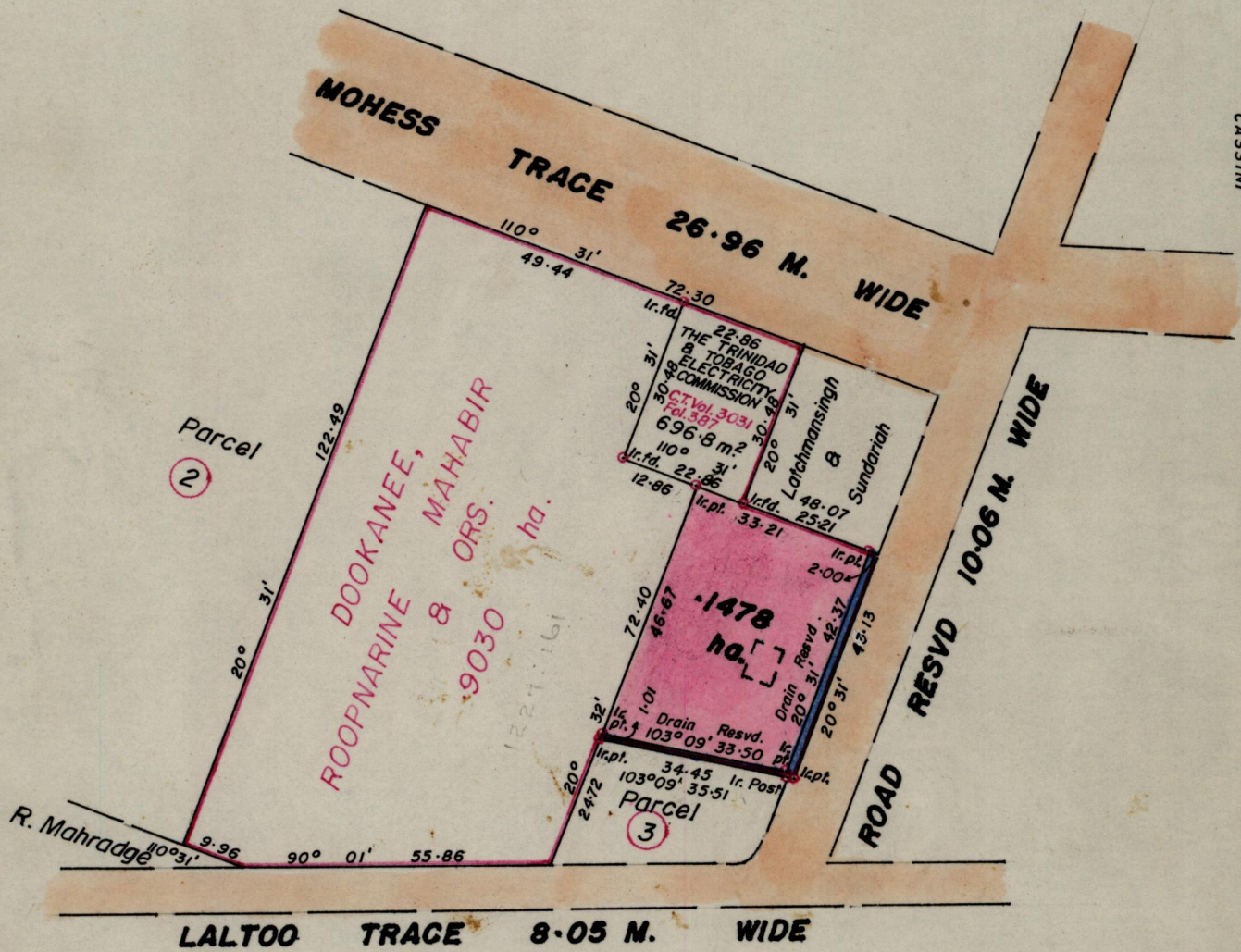

Approved

*Handwritten signature of Chand Chole*

Director of Surveys  
90-12-14

SCALE 1:1250

Note: To obtain compass bearings ~~add~~/subtract / minutes Distances are in metres .

PLAN of a Parcel of land coloured pink in the Ward of Siparia .  
Containing point one four seven eight hectare .

Surveyed by me, with due authority, in May 1987 .

I certify that I have complied with rule 76 under section 14(2)(d) of the  
Land Surveyors' Ordinance 1952, and that this plan is correct.

Checked by *Handwritten signature* 13/11/90

*Handwritten signature of Collicharan*

Entered .....

Land Surveyor, Trinidad & Tobago 7/7/1987