

No 26715

R.P.O. Vol. 14
C.T. Vol. 53159

Fol. 253
Fol. 271

Ward of Savana Grande.
County of Victoria.
Cadastral Sheet G.10.N (64B/4/d)

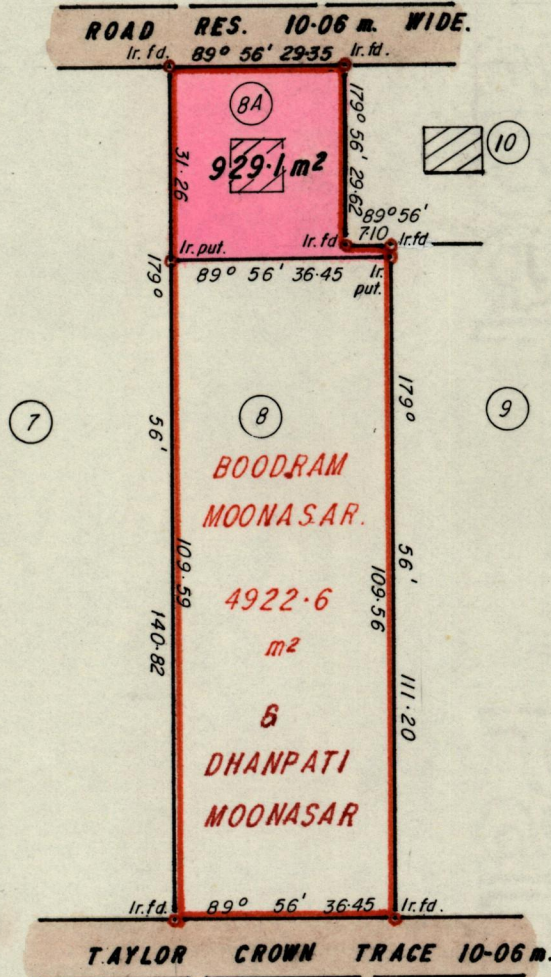

Approved

Lawrence Clarke
 Director of Surveys
 90.12.09

SCALE 1 / 1250.

Note: To obtain compass bearings add/subtract

minutes

Distances are in metres.

PLAN of a Parcel of land coloured pink in the Ward of Savana Grande.

Containing nine hundred and twenty nine point one square metres.

Surveyed by me, with due authority, in May 1989.

I certify that I have complied with rule 76 under section 14(2)(d) of the Land Surveyors' Ordinance 1952, and that this plan is correct.

Checked by *Lawrence Clarke* 4/12/90

Lawrence Clarke
 Land Surveyor, Trinidad and Tobago
 7th June 1989.