

No 24042

R.P.O. Vol. 30
C.T. Vol. 1959

Fol. 129
Fol. 307

Ward of Savana Grande
County of Victoria
Cadastral Sheet (G.15.B) ^{64E}
2082b

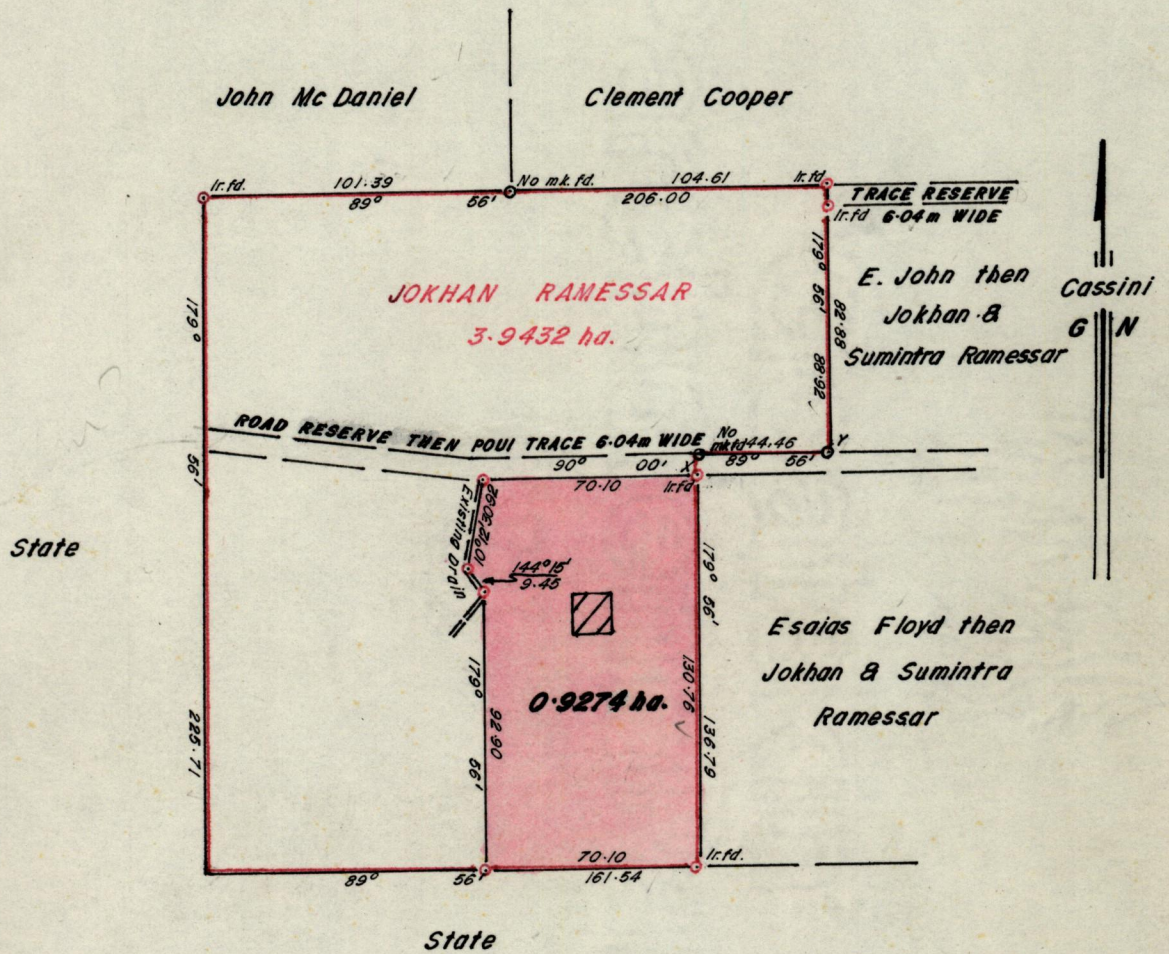

Approved

[Signature]
Director of Surveys
90.10.29

X-Y 82° 11' 44.47

See Bk.1233 Fol.116

o Denotes Iron put except stated otherwise
SCALE 1:2500

Note: To obtain compass bearings add/subtract 4 minutes Distances are in metres

PLAN of a Parcel of land coloured pink in the Ward of Savana Grande
Containing zero point nine two seven four hectare

Surveyed by me, with due authority, in December 1989

I certify that I have complied with rule 76 under section 14(2)(d) of the
Land Surveyors' Ordinance 1952, and that this plan is correct.

Checked by *G. Rancheva*
29/10/90

Winston Rancheva

Entered

Land Surveyor, Trinidad 22nd June 1990