

No 19671

R.P.O. Vol. 654  
C.T. Vol.

Fol. 627  
Fol.

Ward of Tobago.  
Parish of St. Mary.  
Cadastral Sheet I. 19. E

INSET

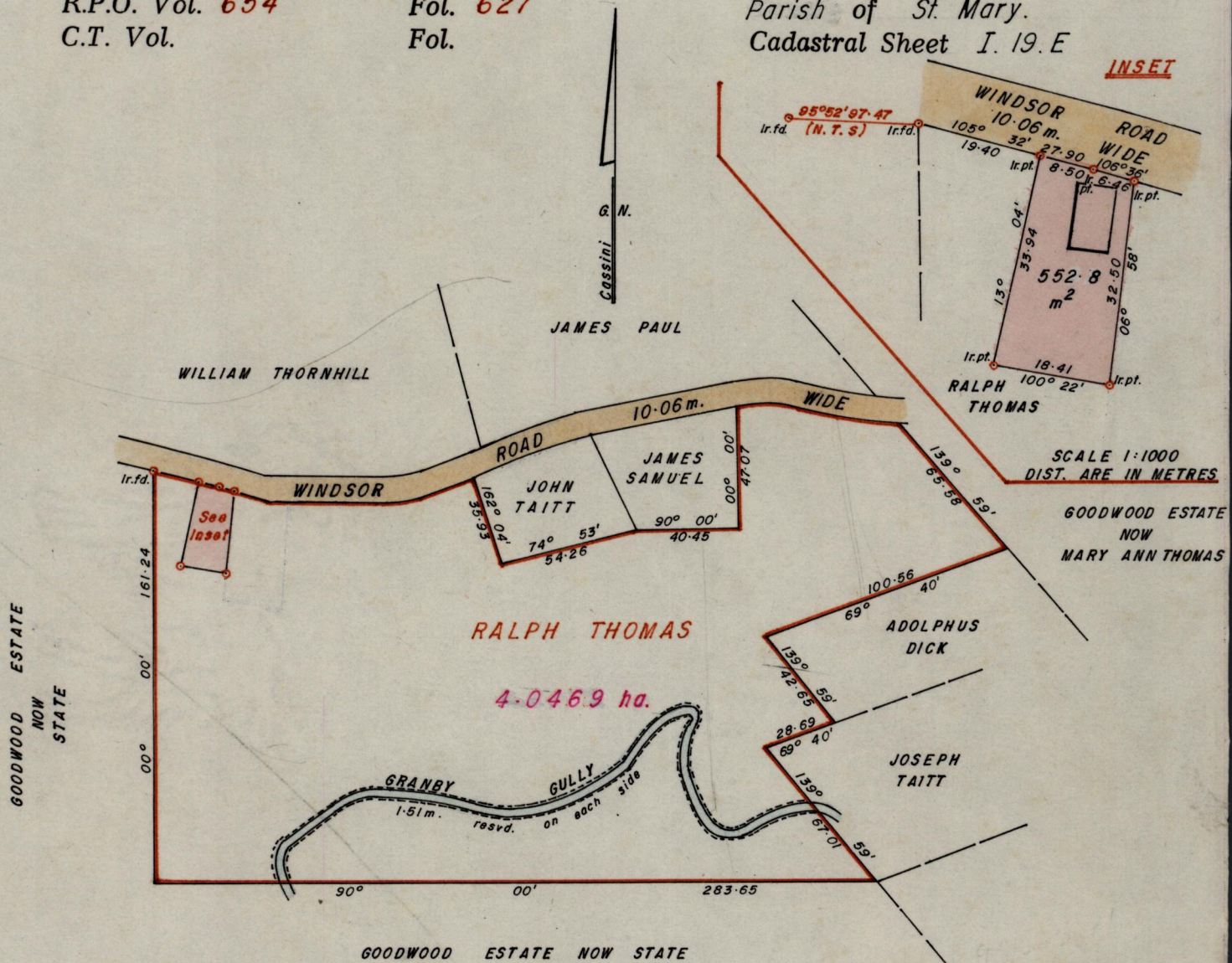

Approved

*Alwyn R. P. J.*  
Director of Surveys

89.05.09

Bearings are Cassini Grid, based on Solar Obs.

SCALE 1:2500

Note: To obtain compass bearings add/subtract

minutes

Distances are in Metres

PLAN of a Parcel of land coloured Pink in the Ward of Tobago.

Containing five hundred and fifty two point eight square metres.

Surveyed by me, with due authority, in September 1987

I certify that I have complied with rule 76 under section 14(2)(d) of the Land Surveyors' Ordinance 1952, and that this plan is correct.

Checked by *SR 5/5/89*

*A. Heenan*  
Land Surveyor, Trinidad 5<sup>th</sup> October 1987