

R.P.O. Vol.
C.T. Vol. 951

Fol.
Fol 511

Ward of Siparia
County of St. Patrick
Cadastral Sheet G.18.D (73C / 2/a, 2/b)

INSET

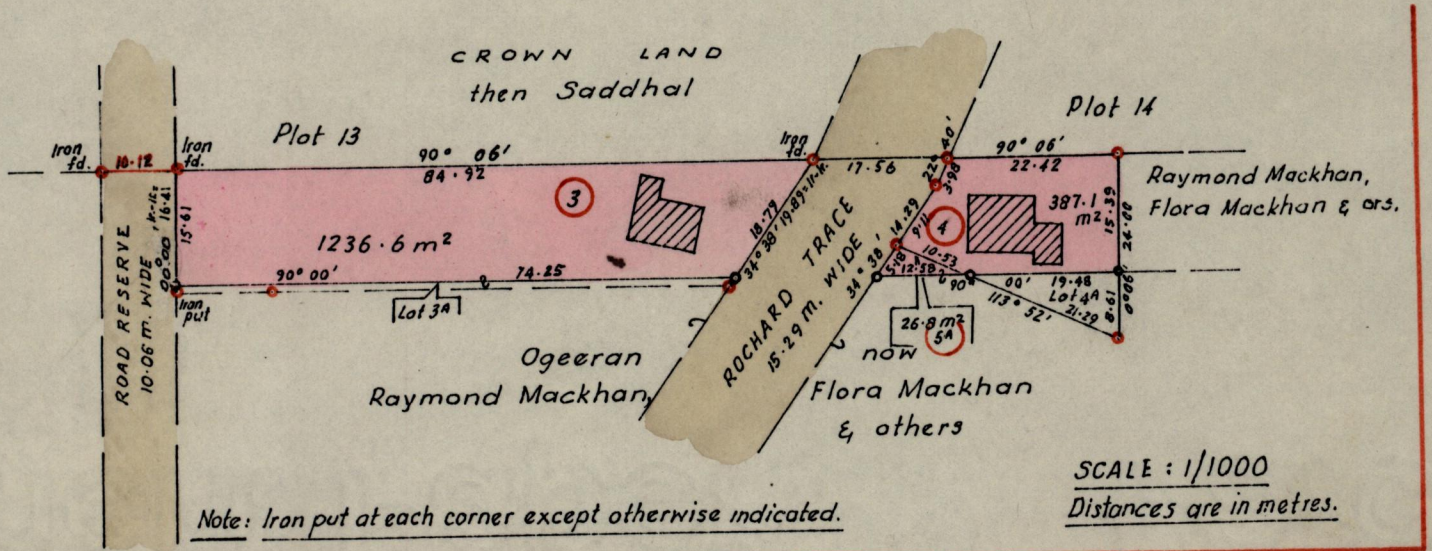

Note: Iron put at each corner except otherwise indicated.

SCALE: 1/1000
Distances are in metres.

G. N
(Cassini)

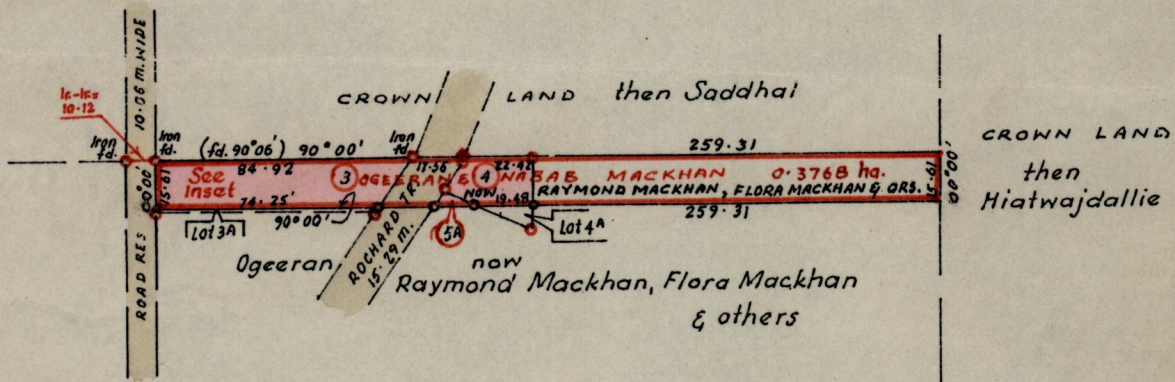

Approved

Alwyn Thibaut
Director of Surveys
89.05.10

SCALE: 1/2500

Note: To obtain compass bearings add/subtract minutes Distances are in metres
PLAN of 3 Parcels of land coloured pink in the Ward of Siparia
Containing

Surveyed by me, with due authority, in May 1988

I certify that I have complied with rule 76 under Section 14 (2) (d) of the Land Surveyors' Ordinance 1952, and that this plan is correct.

Checked by *PH 10/5/89*

Entered.....

J. R. Gardner
Land Surveyor, Trinidad
12/7/1988