

REMAINING PORTION

R.P.O. Vol. 105

Fol. 593

1155

Cadastral Sheet G.II.D 63D
1/a

544

C. of T. Vol.

Vol.

Ward of Siparia

County of St Patrick

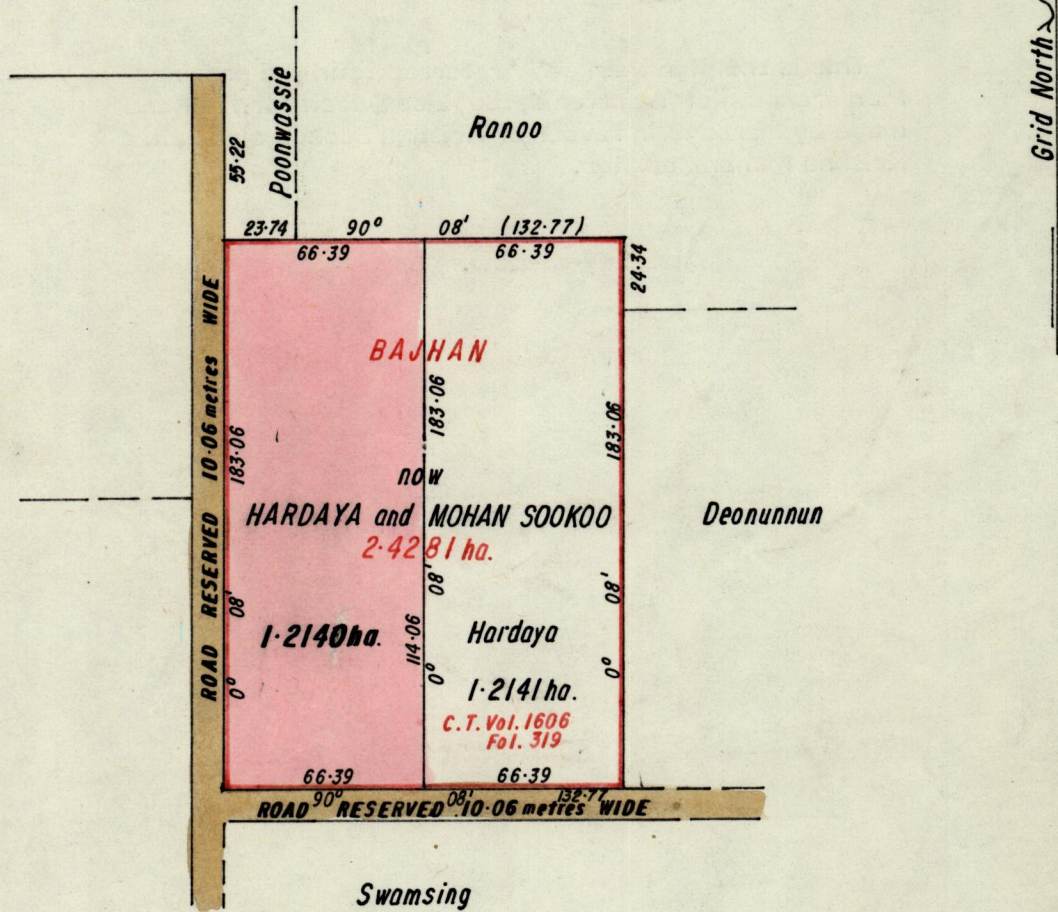

Approved

Abanaya Thidj
 Director of Surveys
 89.04.14

SCALE 1:2500

Note: To obtain compass bearings

subtract 8 minutes

Distances are in metres

This is a true copy of a diagram of two point four two eight one hectares originally granted to **BAJHAN**, shewing a portion coloured pink and containing one point two one four zero hectares being the remainder after one previous transfer of another portion of the land. 14(2)(d) of the Land Surveyors' Ordinance 1952, the dividing lines having been run in conformity with Rule 76 under Sec. 14(d) of Cap. 27, No. 2 and duly certified by the Director of Surveys.

Checked by GR 13/4/89.

Entered on

G. Sathicharan
 Land Surveyor, Trinidad,

30/3/1989

Original Survey Bk. 466:332

'A'

This is the plan marked 'A' referred to in the prefixed Memorandum of Transfer dated 21st December, 1988 and made by Hardaya in favour of Krishna Sookoo also called Krishna Mohan Sookhoo.

Attorney-at-Law.