

No 9876

R.P.O. Vol. 520  
C.T. Vol. 982

Fol. 469  
Fol. 472

Ward of Tobago.  
Parish of St. Patrick.  
Cadastral Sheet 1.21.  $\frac{1.E.}{6/c/1}$

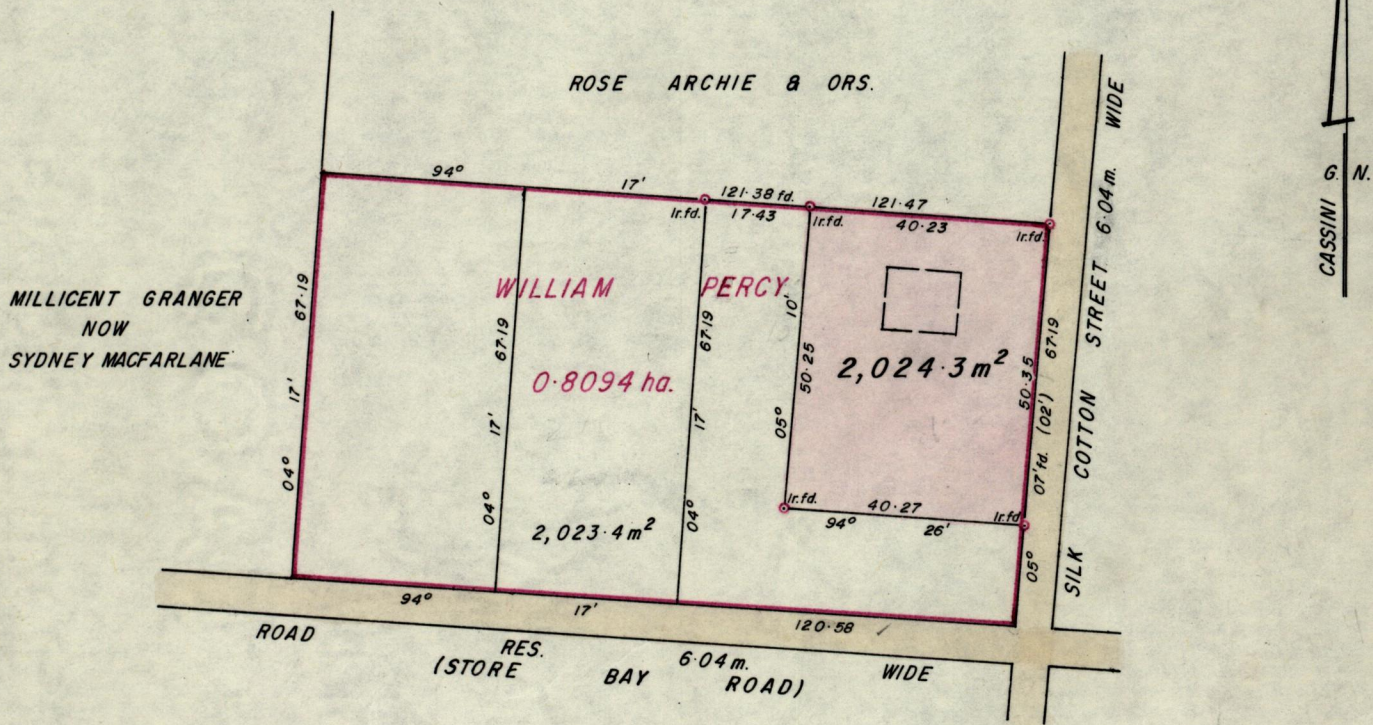

Approved

*K.B. Jones*  
Director of Surveys  
26.6.85

BEARINGS ARE CASSINI GRID BASED ON SOLAR OBS. SCALE 1:1250

Note: To obtain compass bearings add/subtract

minutes

Distances are in Metres.

PLAN of a Parcel of land coloured Pink in the Ward of Tobago.

Containing two thousand and twenty four point three square metres.

Surveyed by me, with due authority, in June 1985

I certify that I have complied with rule 76 under section 14(2)(d) of the Land Surveyors' Ordinance 1952, and that this plan is correct.

Checked by *H. 86/0.6/0.H.*

*J. Jones*

Entered

Land Surveyor, Trinidad 29<sup>th</sup> July 1985