

1257

REMAINING PORTION

R.P.O. Vol. 99 Fol. 271  
C. of T. Vol. 1134. Vol. 251

1155

Cadastral Sheet 13E 1/c (A.20.C.) 469  
Ward of St. Anns  
County of St. George.

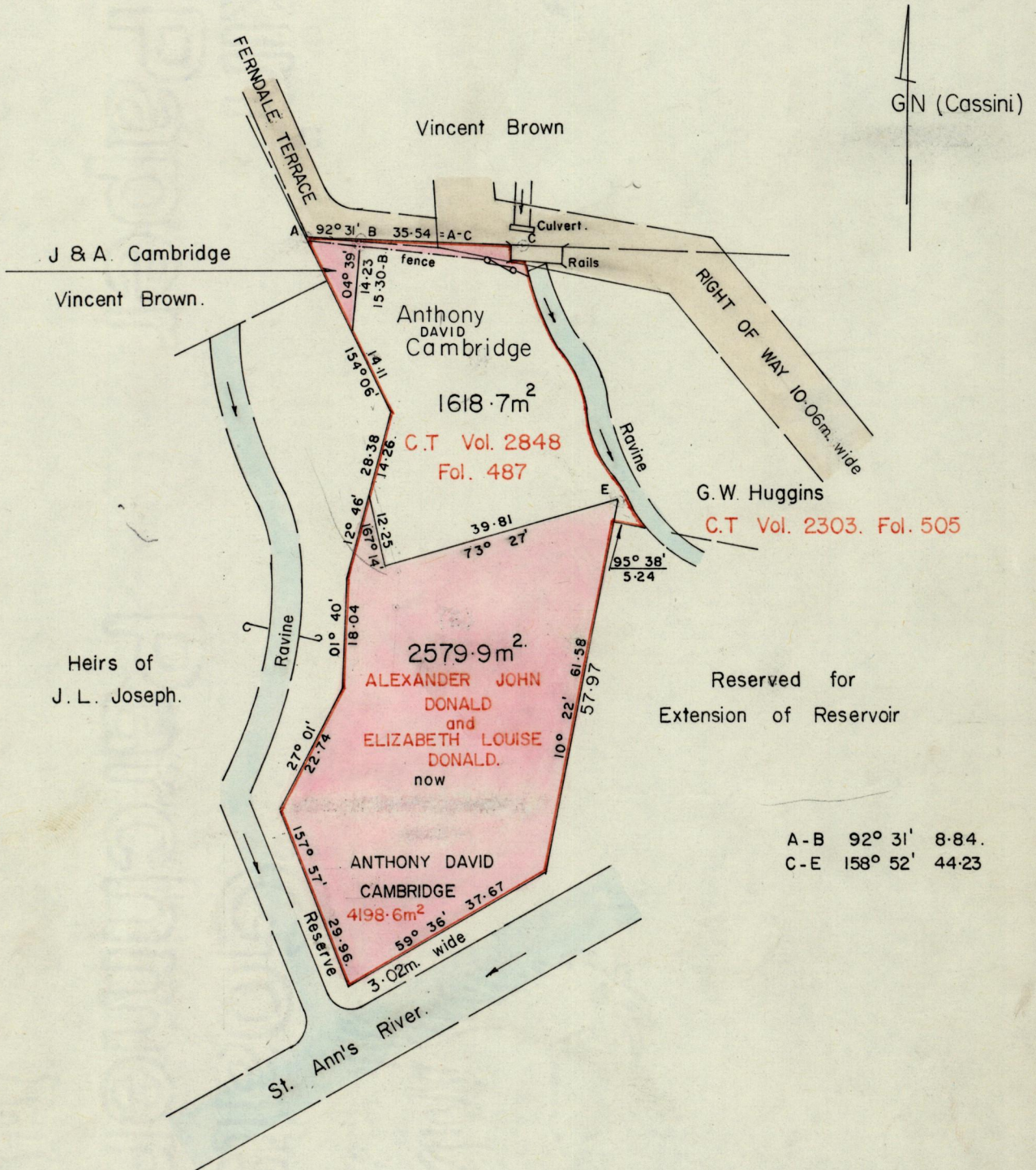

Approved

*Robert King*  
Director of Surveys  
88.07.26

Note: To obtain compass bearings *add* | minutes  
*subtract*

SCALE 1:1000.

Distances are in METRES.

This is a true copy of a diagram of four thousand one hundred and ninety-eight point six square metres originally transferred granted to Alexander John Donald and Elizabeth Louise Donald, shewing a portion coloured pink and containing twenty-five hundred and seventy-nine point nine square metres being the remainder after one previous transfer of another portion of the land. the dividing lines having been run in conformity with Rule 76 under Sec. 7(d) of Cap. 27. No. 2 and duly certified by the Director of Surveys.

Checked by *Q* 25/7/88

Entered on

*Paul Williams*

Land Surveyor, Trinidad, ..... 21. / . 0.3 / ..... 19.88