

R.P.O. Vol. 211

Fol. 249

1155

Cadastral Sheet ^{63E}/_{47b} (G.13.J.)

C. of T. Vol. 956

Fol. 9

Ward of Siparia

Remaining Portion Plan R.P.O. Vol. 956 Fol. 7

County of St. Patrick

468

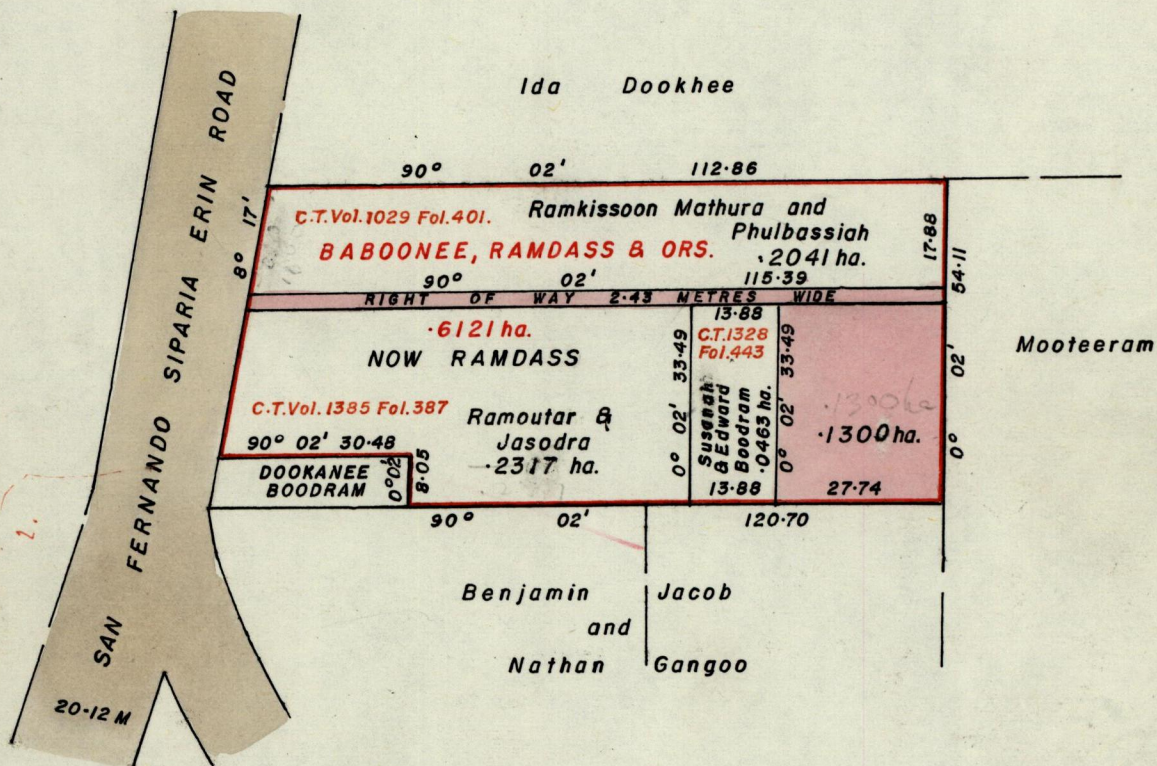

Approved

Alous, T. B. J.
 Director of Surveys
 88.07.25

SCALE 1 - 1250

Note: To obtain compass bearings

add 2 minutes
subtract

Distances are in metres

This is a true copy of a diagram of Point Six one two one hectare originally transferred to BABOONEE, RAMDASS & ORS., shewing a portion coloured pink and containing Point One three zero zero hectare being the remainder after three previous transfers of other portions of the land. the dividing lines having been run in conformity with Rule 76 under Sec. 14(2)(d) of the Land Surveyors Ordinance 1952, and duly certified by the Director of Surveys.

Checked by *B* 22/7/88

Entered on

Harj Soman
 Land Surveyor, Trinidad, 25th March 1988