

1155

L. & S.—54

4166
466

No 23884

R.P.O. Vol. 368
C.T. Vol. 1726

Fol. 93
Fol. 457

Ward of Siparia
County of St. Patrick
Cadastral Sheet G.12.P. $\frac{63.E}{4/c}$

See Bk. 988/46

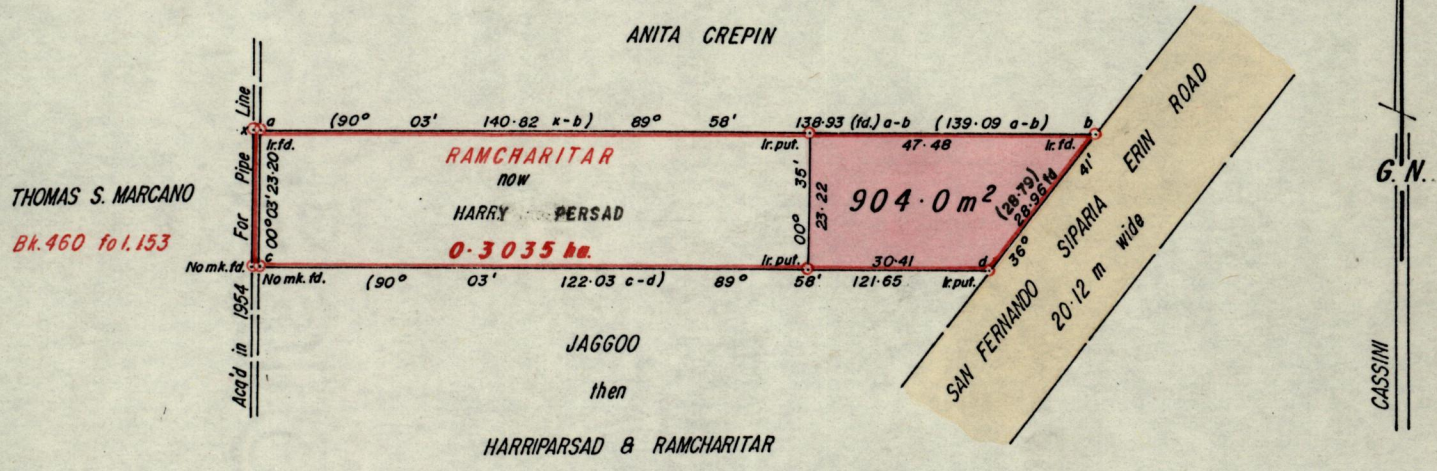

Approved

Alexandra Thiel
Director of Surveys
88.07.13

Bearings are based on Solar Observations (Cassini Grid)
Note: To obtain compass bearings ~~add~~/subtract 3 minutes

SCALE 1:1250

Distances are in metres

PLAN of a Parcel of land coloured pink in the Ward of Siparia
Containing nine hundred and four point zero square metres
Surveyed by me, with due authority, in April 1985

I certify that I have complied with rule 76 under section 14(2)(d) of the
Land Surveyors' Ordinance 1952, and that this plan is correct.

Checked by *[Signature]* 2/7/88

Jankaran Micoo

Entered

Land Surveyor, Trinidad *June, 29th* 1988