

1155

L. & S.—54

452

No 23919

R.P.O. Vol. 79
C.T. Vol. 1074

Fol. 213
Fol. 135

Ward of Siparia
County of St. Patrick
Cadastral Sheet G.13.F

63F
17c

VIDE PLAN R.G. 29
BK. 1017 FOL. 59
BK. 985 FOL. 176
BK. 390 FOL. 54
BK. 881 FOL. 4

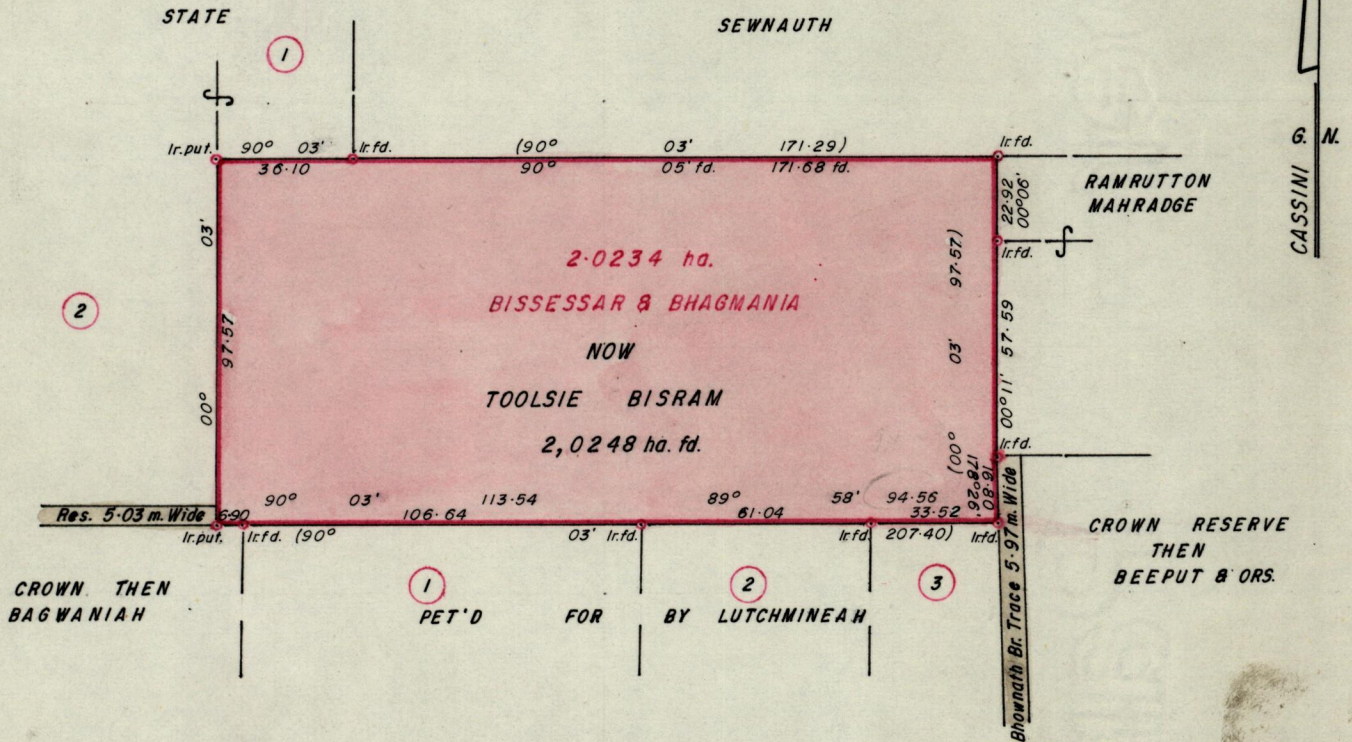

Approved

Algera Thiel
Director of Surveys
88.07.11

Bearings are Cassini Grid, based on Solar Obs.

SCALE 1/2000

Note: To obtain compass bearings add/subtract

minutes

Distances are in metres

PLAN of a Parcel of land coloured pink in the Ward of Siparia
Containing two point zero, two, four, eight hectares

Redefined by me, with due authority, in May 1988

I certify that I have complied with rule 76 under section 14(2)(d) of the
Land Surveyors' Ordinance 1952, and that this plan is correct.

Checked by *GR 6/7/88*

Deenan

Entered

Land Surveyor, Trinidad *6th June 1988*