

REMAINING PORTION

1155

352

R.P.O. Vol. 59.

Fol. 235.

Cadastral Sheet E. 2. N.

C. of T. Vol. 1603.

Vol. 439.

Ward of Turure.

County of St. Andrew.

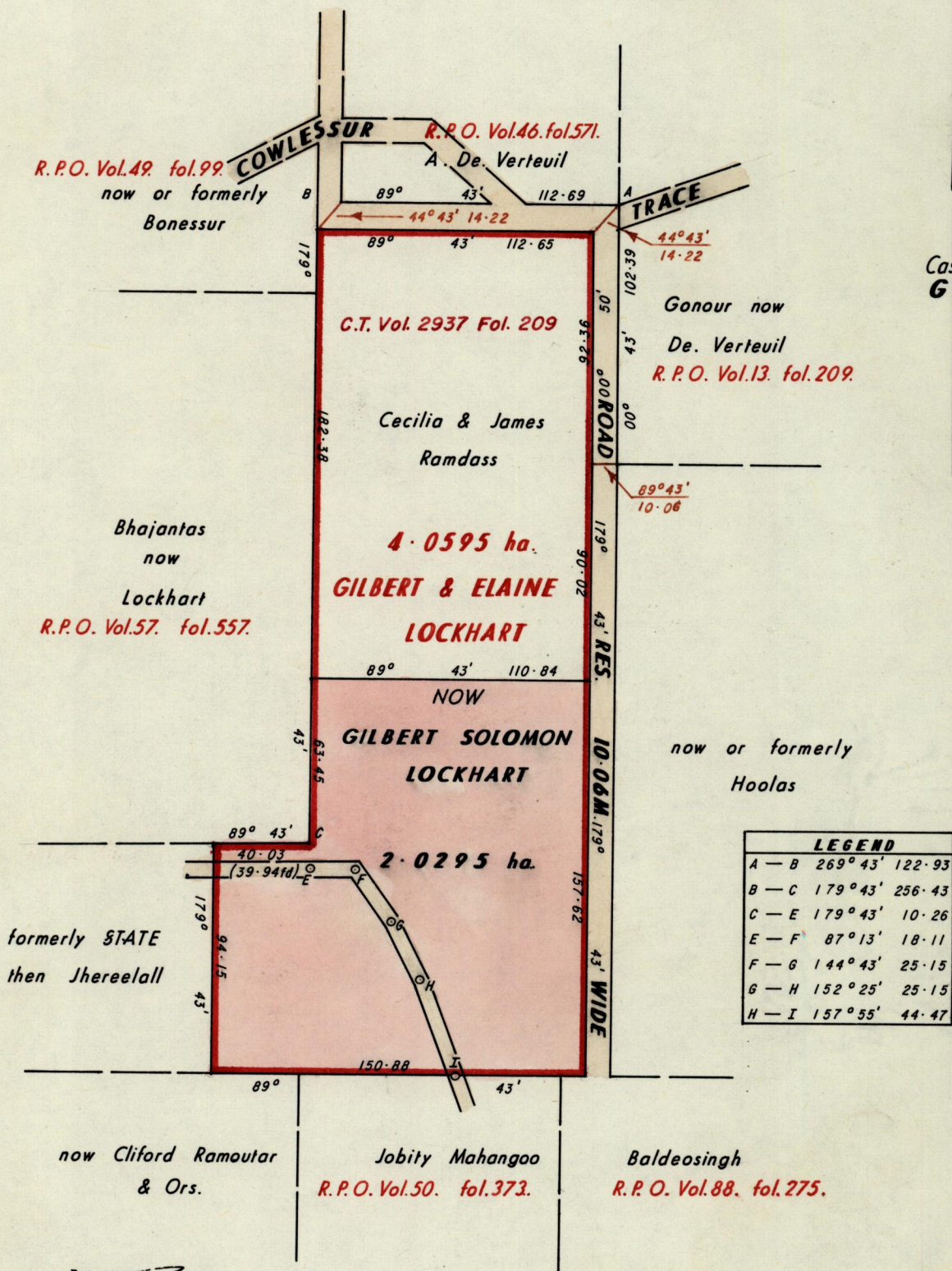

Cassini
G N

| LEGEND | |
|--------|-----------------|
| A — B | 269° 43' 122.93 |
| B — C | 179° 43' 256.43 |
| C — E | 179° 43' 10.26 |
| E — F | 87° 13' 18.11 |
| F — G | 144° 43' 25.15 |
| G — H | 152° 25' 25.15 |
| H — I | 157° 55' 44.47 |

Approved

[Signature]
 Director of Surveys
 87.06.23

Note: To obtain compass bearings ~~subtract~~ add 17 minutes

SCALE 1 : 2500.

Distances are in metres.

This is a true copy of a diagram of four point zero five nine five hectares. originally transferred to Gilbert & Elaine Lockhart, shewing a portion coloured pink and containing two point zero two nine five hectares. being the remainder after one previous transfer of another portion of the land. the dividing lines having been run in conformity with Rule 76 under Sec. 7(d) of Cap. 27. No. 2 and duly certified by the Director of Surveys.

Checked by *[Signature]* 87.6.22

Entered on

[Signature]
 Land Surveyor, Trinidad, 20th April 1987