

No 13325

1155

236

R.P.O. Vol. 58
C.T. Vol. 1842

Fol. 161
Fol. 283

Ward of Charuma .
County of Nariva .
Cadastral Sheet H.2.B.a.c.

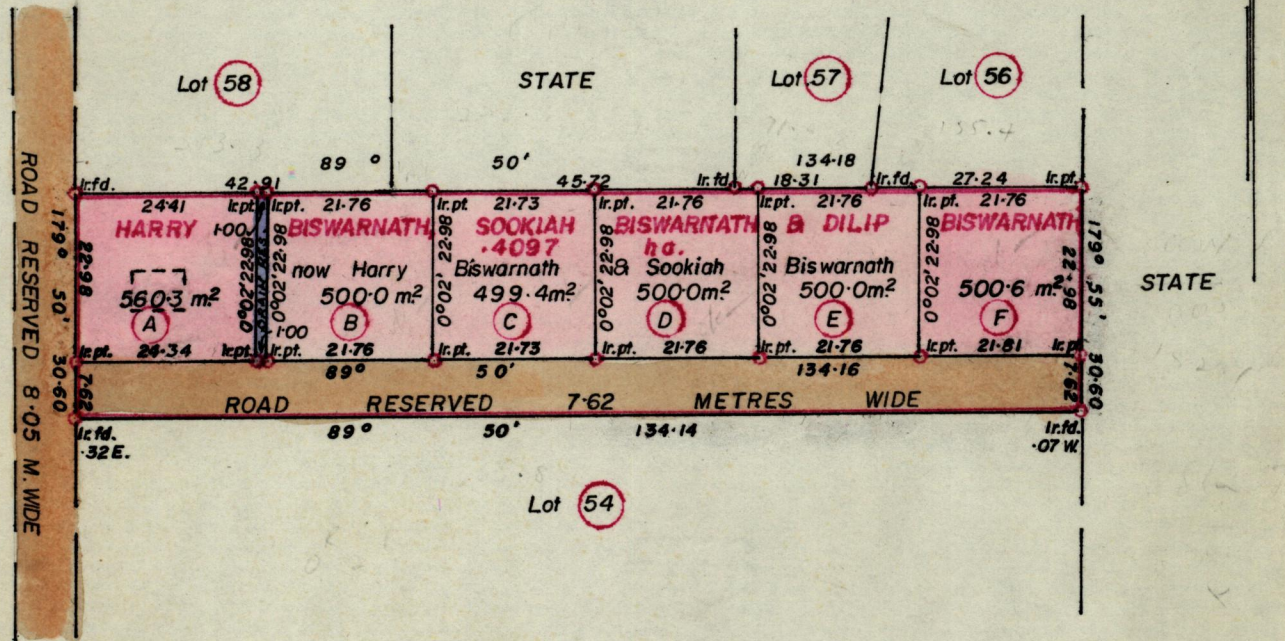

Approved

H.B. Joseph
Director of Surveys
86.11.25

SCALE 1:1000.

Note: To obtain compass bearings add/subtract 10 minutes Distances are in Metres.

PLAN of 6 Parcelsof land coloured Pink in the Ward of Charuma .
Containing Together three thousand and sixty point three metres sq .

Surveyed by me, with due authority, in October 1984

I certify that I have complied with rule 76 under section 14(2)(d) of the
Land Surveyors' Ordinance 1952, and that this plan is correct.

Checked by *T.D. 86.11.25*

S. Althicharan

Entered

Land Surveyor, Trinidad 15/11/1984