

1155

L. & S.—54

217

No 15879

R.P.O. Vol. 92.
C.T. Vol. 734.

Fol. 97.
Fol. 253.

Ward of Siparia.
County of St. Patrick.
Cadastral Sheet G. 13. F.

Vide Remaining Portion Plan in Vol. 740. fol. 143.

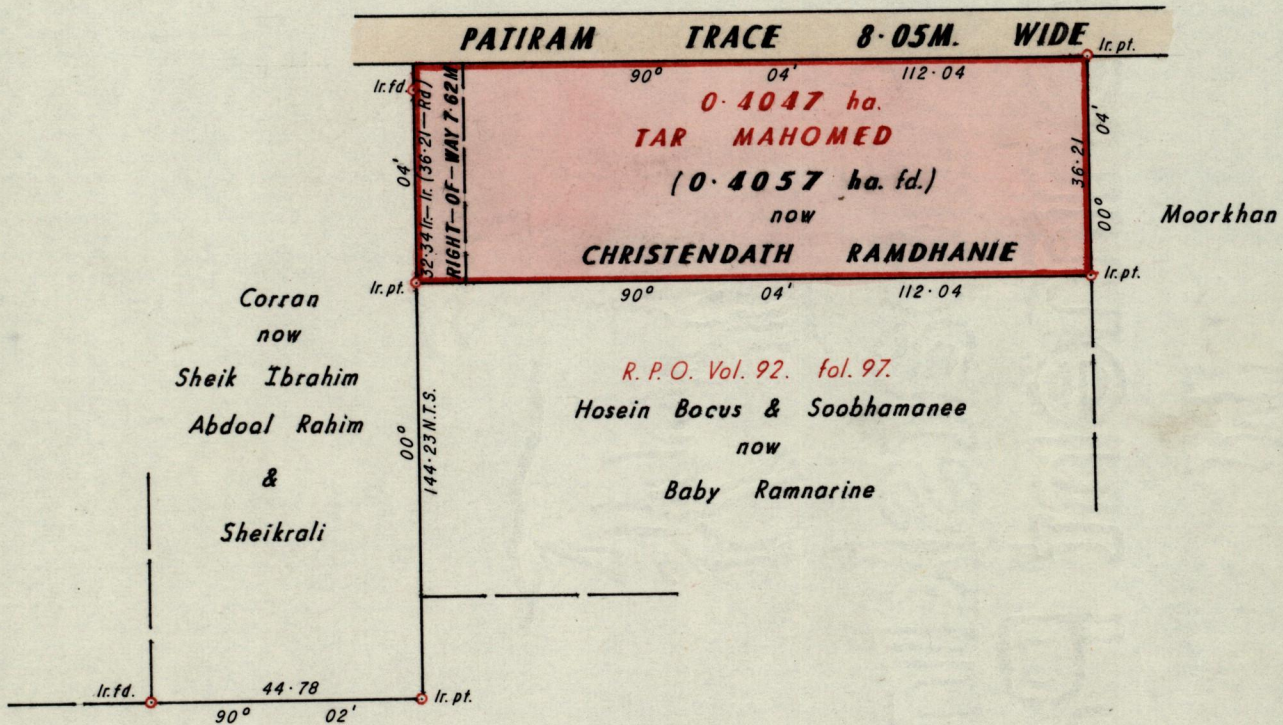

Cassini
G N

Approved

K.B. Joseph
Director of Surveys
86.11.17

Cassini bearings based on Solar Observations.

SCALE 1:1250.

Note: To obtain compass bearings ~~add~~/subtract 04 minutes

Distances are in metres.

PLAN of a Parcel of land coloured pink in the Ward of Siparia.

Containing zero point four zero five seven hectares.

Surveyed by me, with due authority, in April 1986.

I certify that I have complied with rule 76 under section 14(2)(d) of the Land Surveyors' Ordinance 1952, and that this plan is correct.

Checked by *J.P. 86.11.17*

Wina Ramnarine
Land Surveyor, Trinidad 26th April 1986