

No 16027

R.P.O. Vol. III  
C.T. Vol. 718

Fol. 281  
Fol. 453

Ward of Siparia.  
County of St. Patrick.  
Cadastral Sheet G. 13.N.

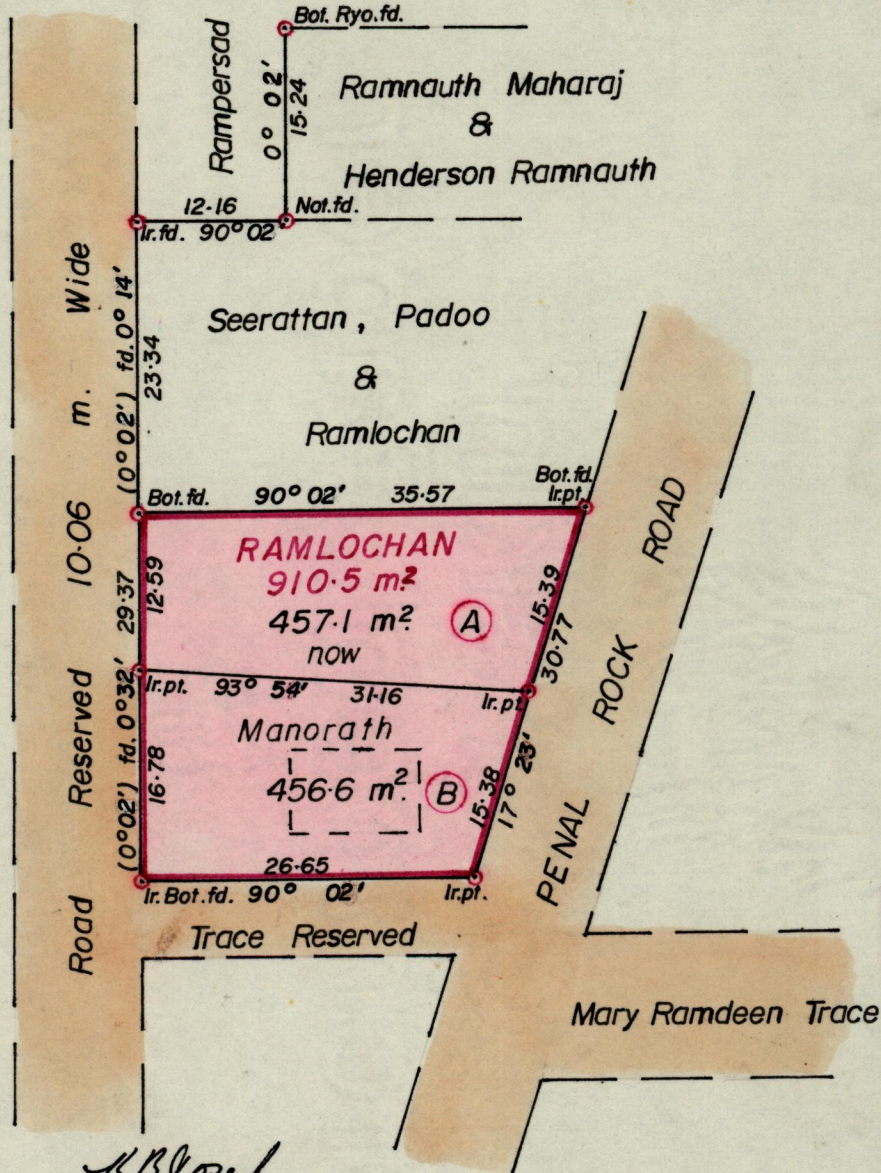

Approved

*K. B. Joseph*  
Director of Surveys  
88.11.12

SCALE 1 : 600.

Note : To obtain compass bearings ~~add~~/subtract 2 minutes Distances are in metres .

PLAN of 2 Parcelsof land coloured pink in the Ward of Siparia .  
Containing together nine hundred and thirteen point seven sq. metres .  
Surveyed by me, with due authority, in October 1985 .

I certify that I have complied with rule 76 under section 14(2)(d) of the  
Land Surveyors' Ordinance 1952, and that this plan is correct.

Checked by *GR 11/11/86*

*S. Sathicharan*  
Land Surveyor, Trinidad 4/11/1986