

1155

209

No 15883

R.P.O. Vol. 83.
C.T. Vol. 1021.

Fol. 317
Fol. 343.

Ward of Siparia.
County of St. Patrick.
Cadastral Sheet G. 13. J.

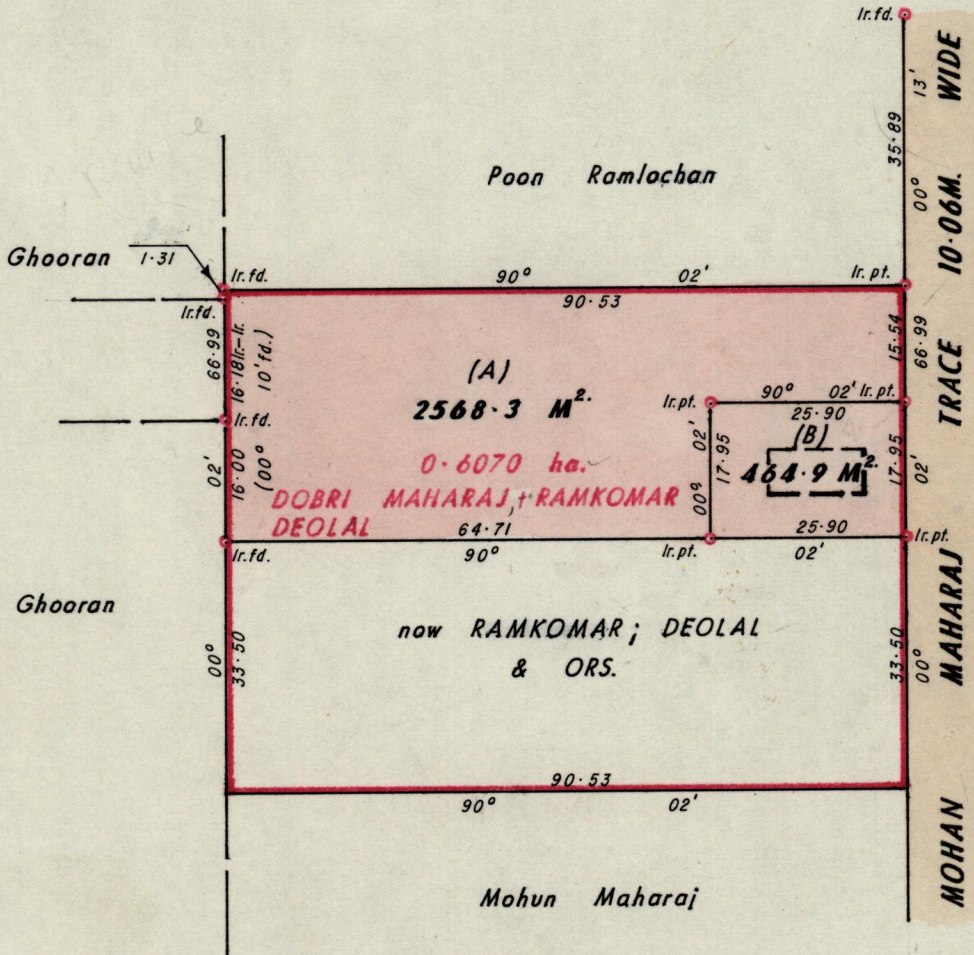

Approved

KB Joseph

Director of Surveys
86.11.10

Cassini Grid Bearings based on Solar Observations.

SCALE 1:1000.

Note: To obtain compass bearings add/subtract

minutes

Distances are in metres.

PLAN of 2 Parcels of land coloured pink in the Ward of Siparia.

Containing together three thousand and thirty three point two square metres.

Surveyed by me, with due authority, on 19th September 1986.

I certify that I have complied with rule 76 under section 14(2)(d) of the Land Surveyors' Ordinance 1952, and that this plan is correct.

Checked by *[Signature]* 7/11/86

[Signature]

Entered

Land Surveyor, Trinidad 15th October 1986.