

Nº 47416

1155

201

C.T.  
R.P.O. Vol. 75  
C.T. Vol.

Fol. 55  
Fol.

Borough  
~~Ward~~ of Arima  
County of St. George  
Cadastral Sheet B. 19. P. 24 C  
1/b

See L & S. Plan E.G. 108

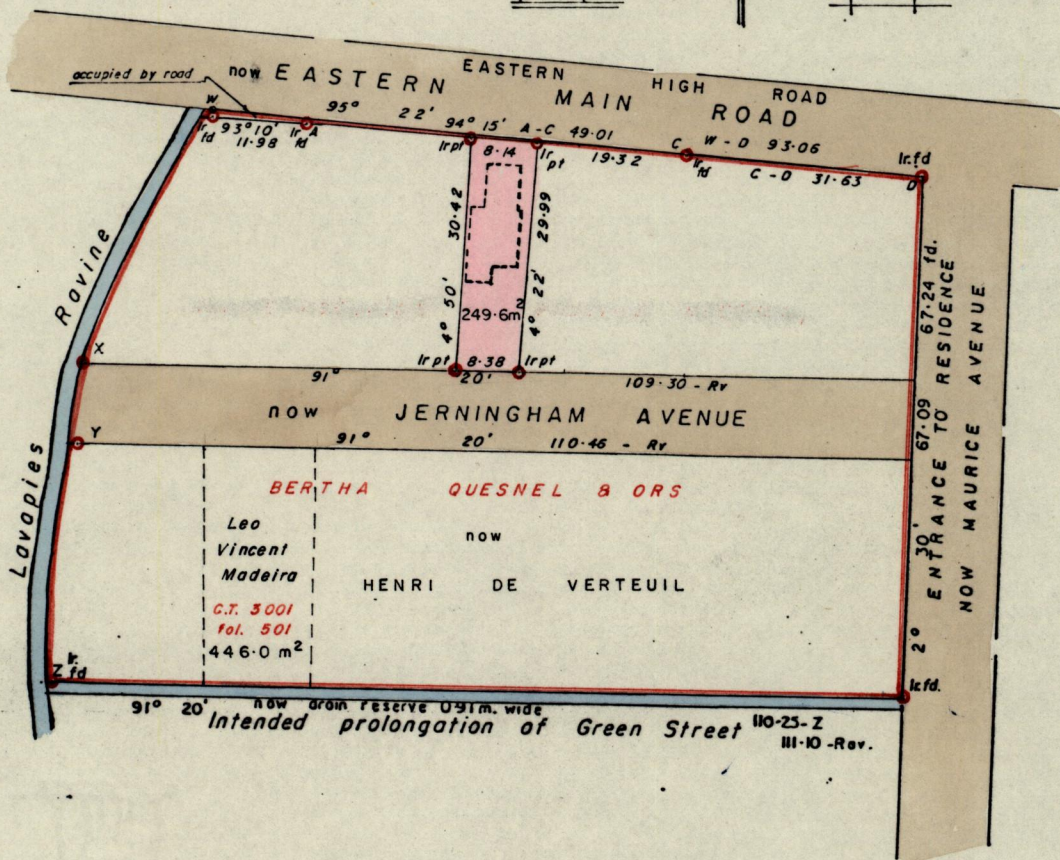
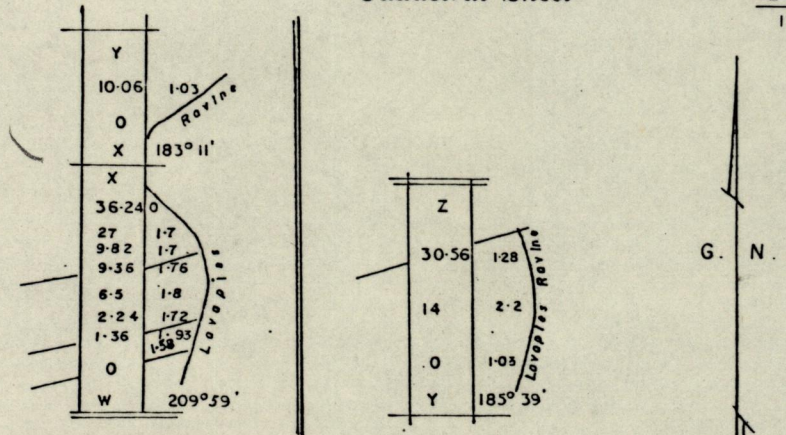

Approved

*K.B. Lynch*  
Director of Surveys  
PB-11-07

SCALE : 1 / 1000

Note: To obtain compass bearings add/subtract 10 minutes Distances are in metres

PLAN of a Parcel of land coloured pink in the ~~Ward~~ of Arima

Containing two hundred and forty - nine point six square metres

Surveyed by me, with due authority, in January 1972

I certify that I have complied with rule 76 under Section 14 (2) (d) of the Land Surveyors' Ordinance 1952, and that this plan is correct.

Checked by *D. 86-11-7*

*Doris H. ...*

Entered .....

Land Surveyor, Trinidad *21<sup>st</sup> Oct. 1985*