

N^o 47416

C.T
R.P.O. Vol. 75
C.T. Vol.

Fol. 55
Fol.

Borough
~~Ward~~ of Arima
County of St. George
Cadastral Sheet B. 19. P. $\frac{24 C}{1/b}$

See L & S. Plan E.G. 108

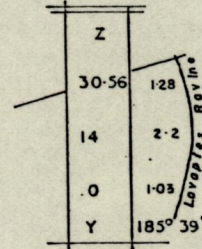
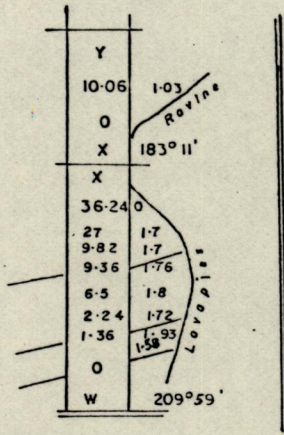

G. N.

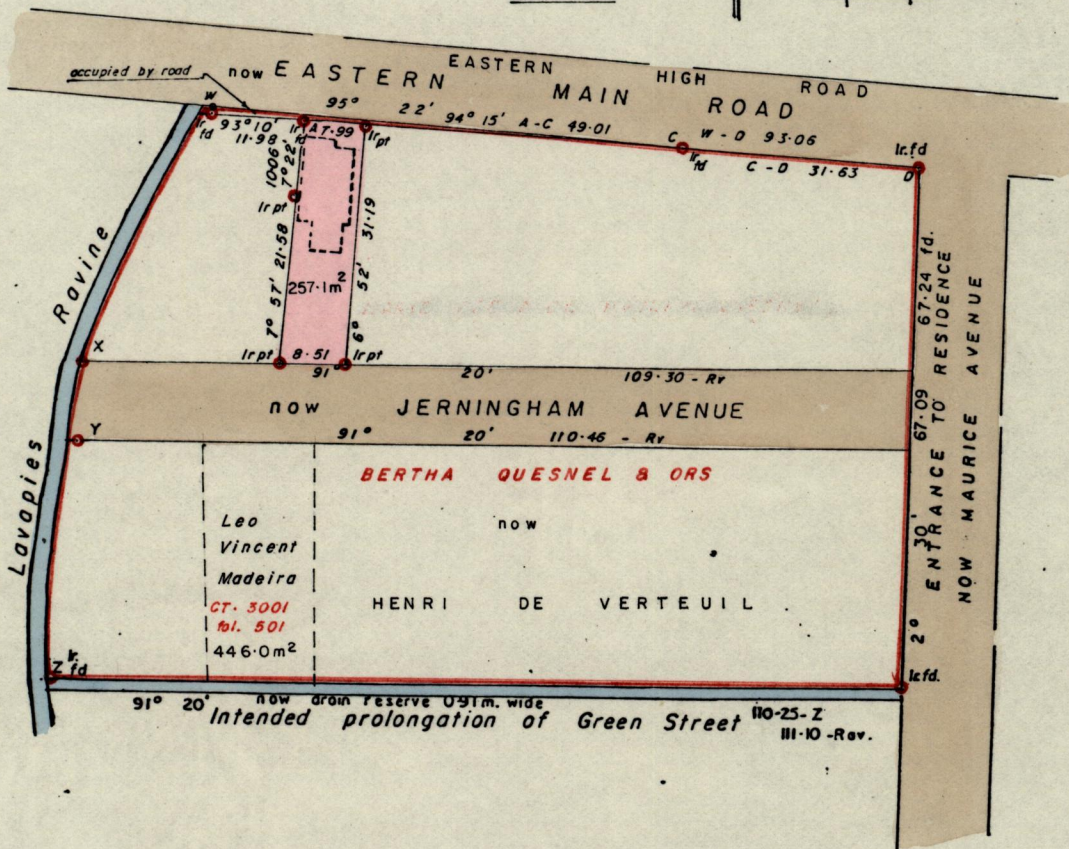

Approved

K.B. Joseph
Director of Surveys
86.11.07

SCALE : 1 / 1000

Note: To obtain compass bearings add/subtract 10 minutes Distances are in metres

PLAN of a Parcel of land coloured pink in the ~~Ward~~ Borough of Arima

Containing two hundred and fifty seven point one square metres

Surveyed by me, with due authority, in January 1972

I certify that I have complied with rule 76 under Section 14 (2) (d) of the Land Surveyors' Ordinance 1952, and that this plan is correct.

Checked by *T.B. 86.11.7*

Doris H. Bell

Entered

Land Surveyor, Trinidad 21st Oct. 1985